

PLOT SCALE: 1:11 EDIT DATE: 1/17/19 - 11:05 AM EDITED BY: JPERRY DRAWING FILE: C:\2018\00600.DRAWINGS\CIVIL\CONSTRUCTION DOCUMENTS\2018.00600 GRADING.DWG

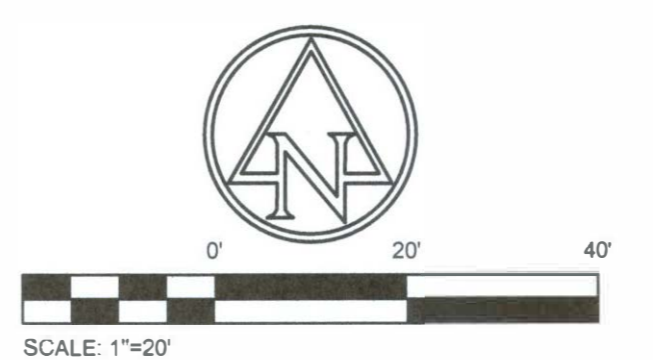
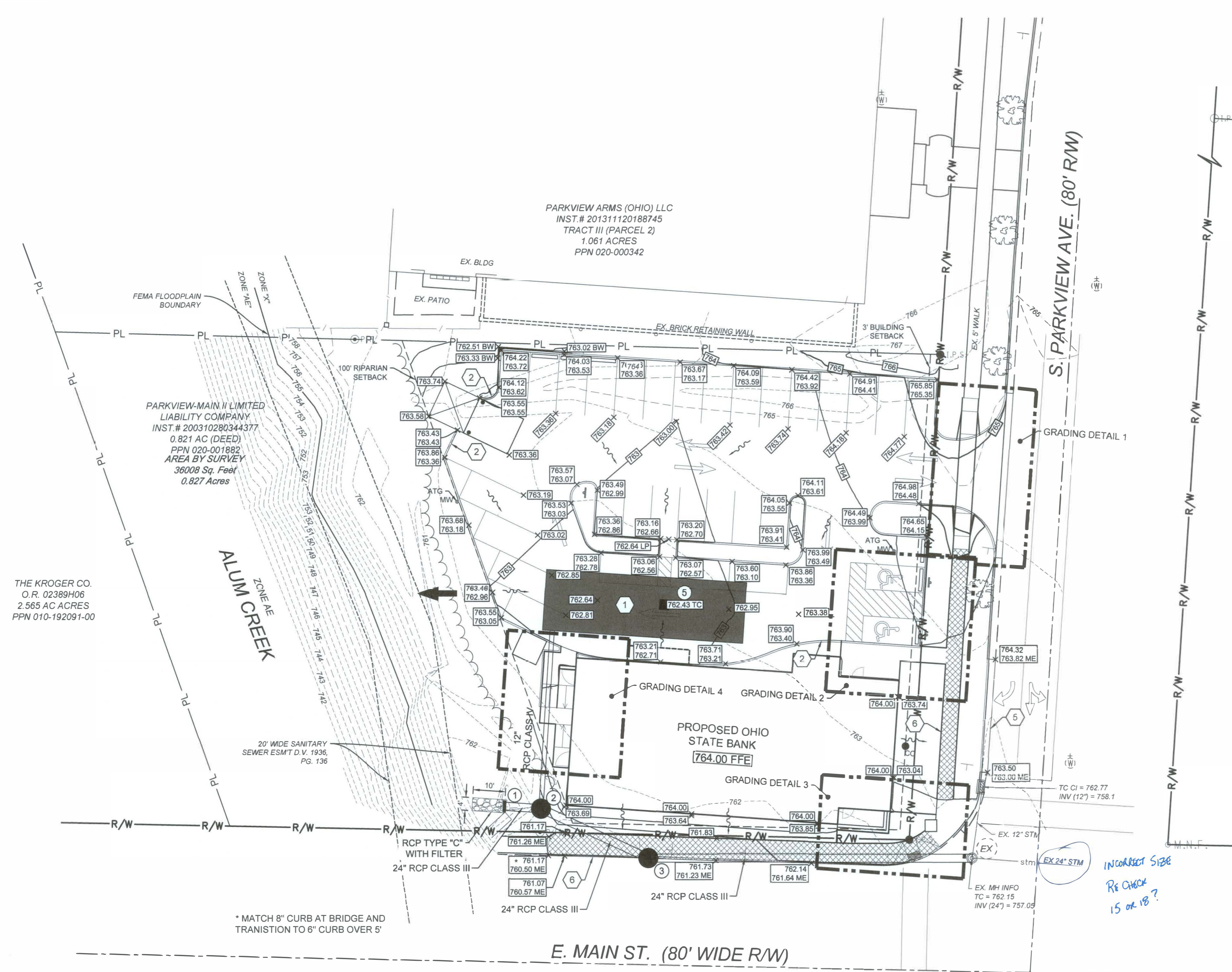

**GRADING LEGEND**

- PROPOSED MAJOR CONTOUR
- PROPOSED MINOR CONTOUR
- - - - - EXISTING MAJOR CONTOUR
- - - - - EXISTING MINOR CONTOUR
- XXXXXX FFE FINISHED FLOOR ELEVATION
- XXXXXX SPOT ELEVATION
- XXXXXX TC TOP OF CASTING ELEVATION
- XXXXXX HP HIGH POINT ELEVATION
- XXXXXX ME MATCH EXISTING ELEVATION
- XXXXXX TC TOP OF CURB ELEVATION
- XXXXXX BW BOTTOM OF CURB ELEVATION
- XXXXXX TW TOP OF WALL ELEVATION
- XXXXXX BW BOTTOM OF WALL ELEVATION
- SLOPE ARROWS
- FLOOD ROUTE
- ATG ADJUST TO GRADE
- █ UDS SEE DETAILS SHEET C401
- ▨ REMOVE AND REPLACE SIDEWALK PER CITY OF COLUMBUS STD DWG 2300

**CODED NOTES**

- 1 SEE SHEET C401 FOR UNDERGROUND DETENTION SYSTEM NOTES AND DETAILS
- 2 TRANSITION TO FULL-HEIGHT CURB
- 3 FLUSH CURB CONDITION
- 4 LANDING AREA NOT TO EXCEED 2% SLOPE IN ANY DIRECTION
- 5 COMBINATION CURB AND GUTTER PER CITY OF COLUMBUS STD DWG 2010
- 6 SIDEWALK PER CITY OF COLUMBUS STD DWG 2300
- 7 TYPE A CURB RAMP WITH DETECTABLE WARNING PER CITY OF COLUMBUS STD DWG 2319

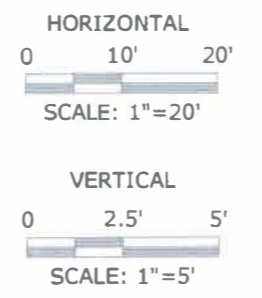
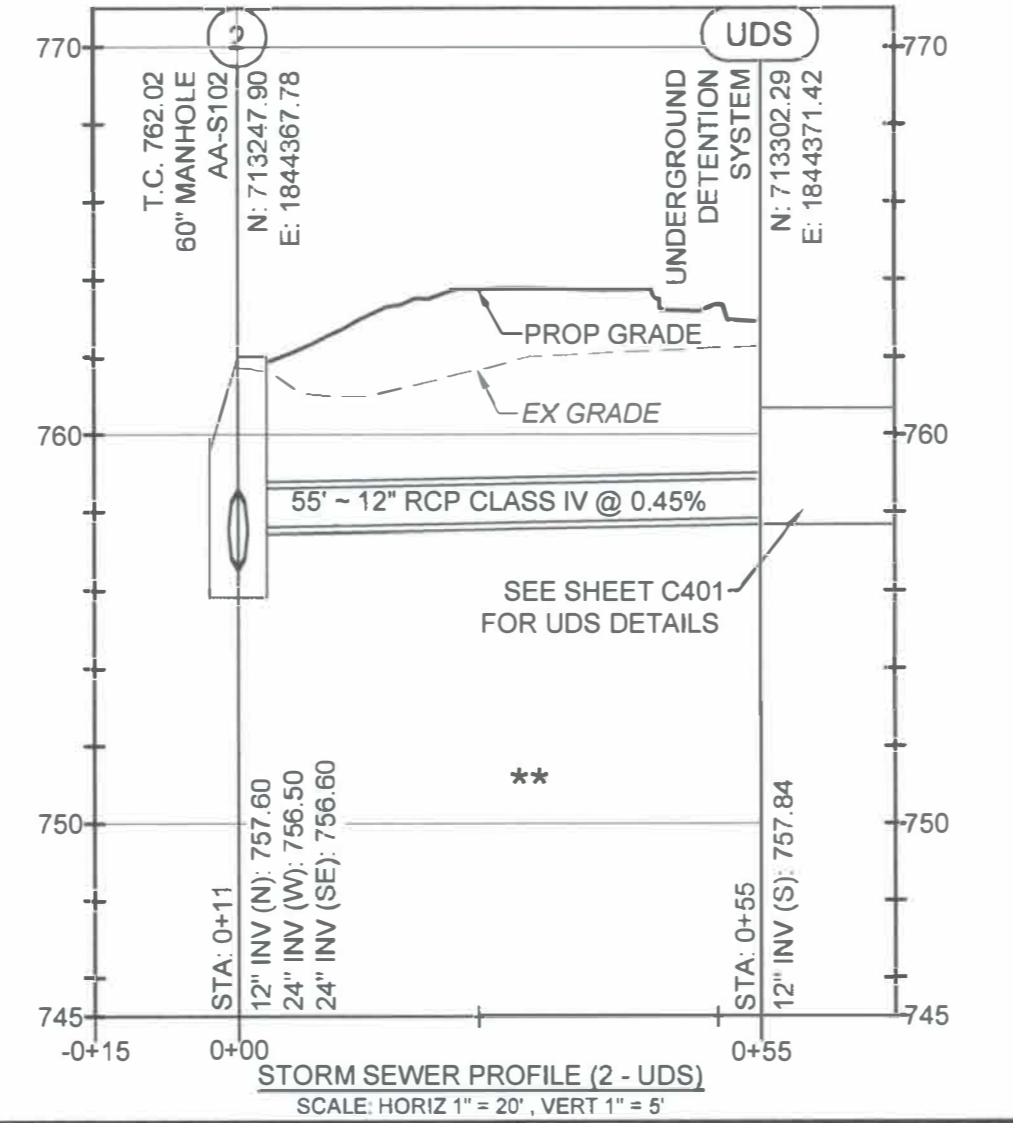
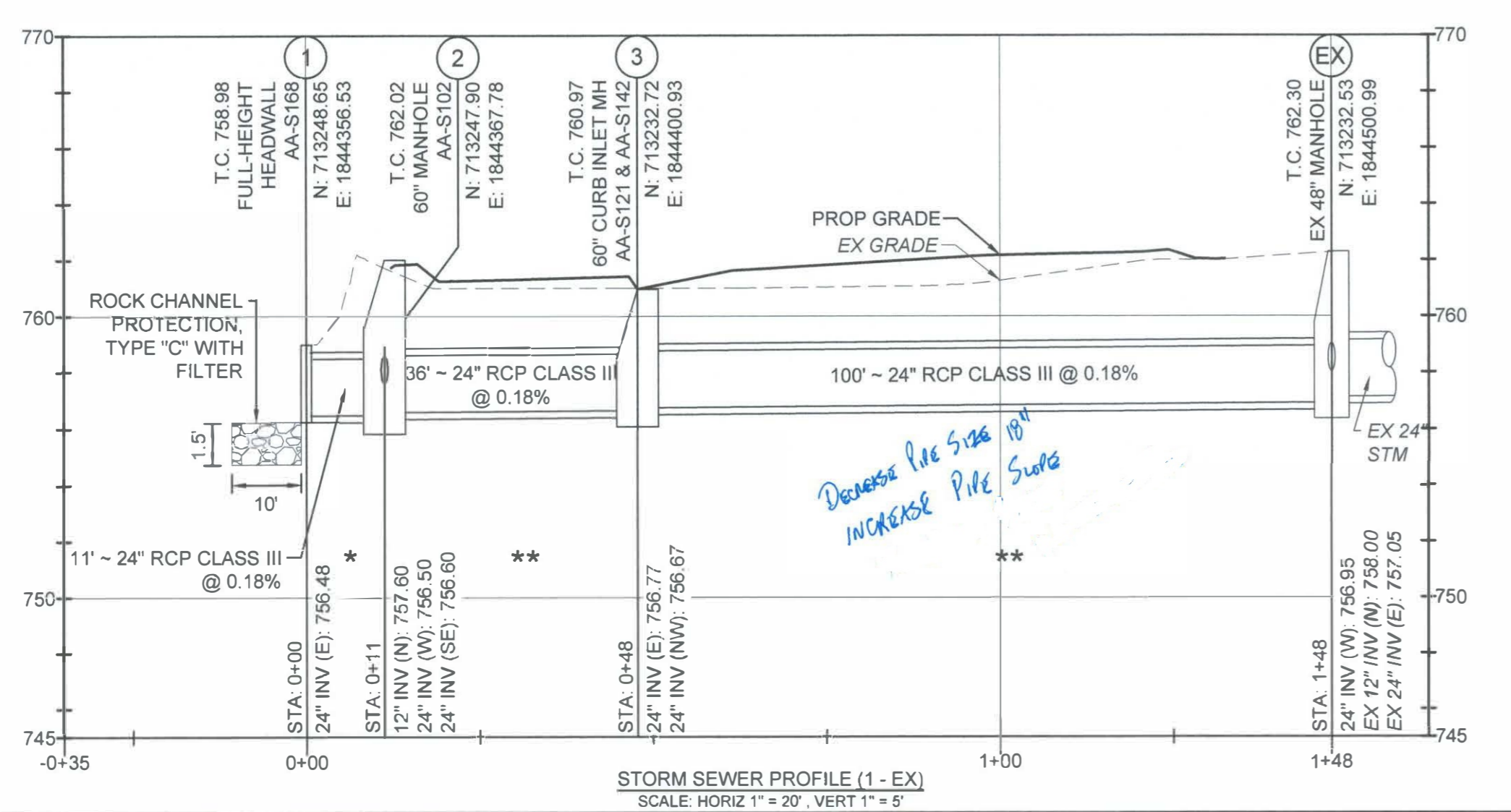
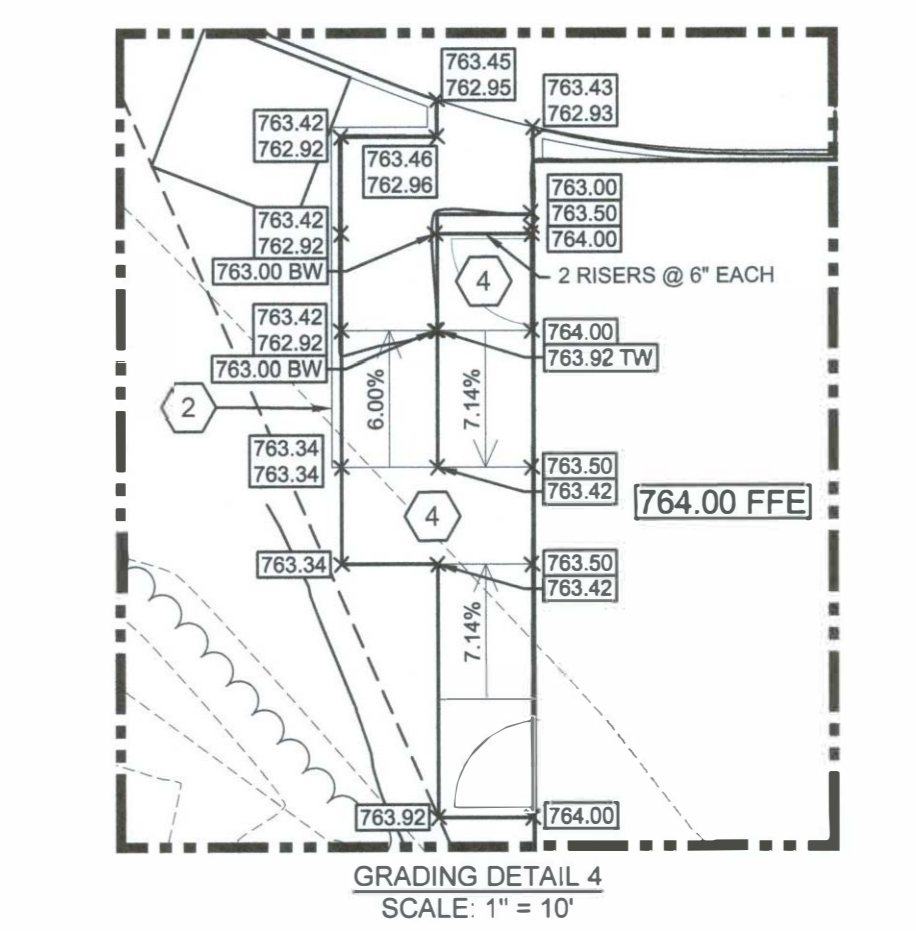
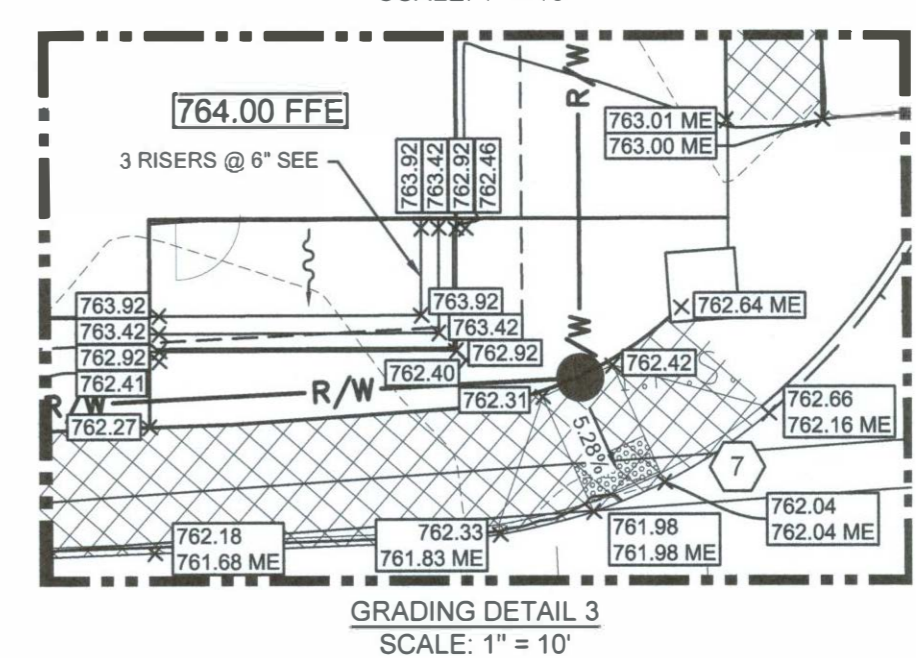
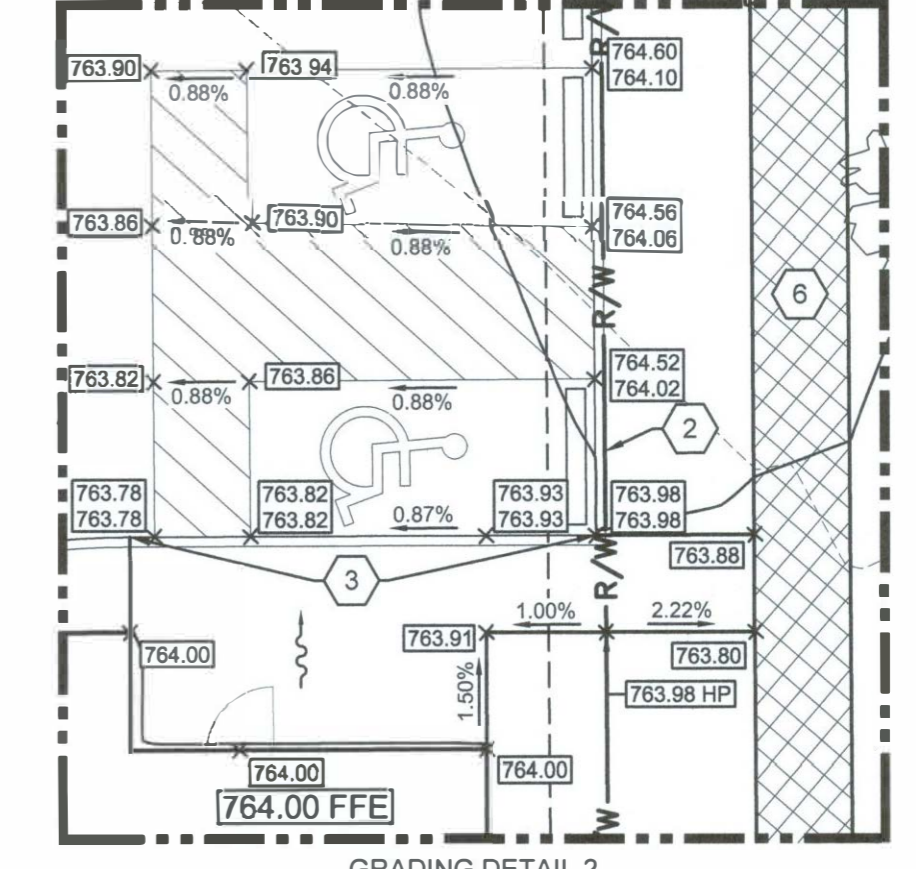
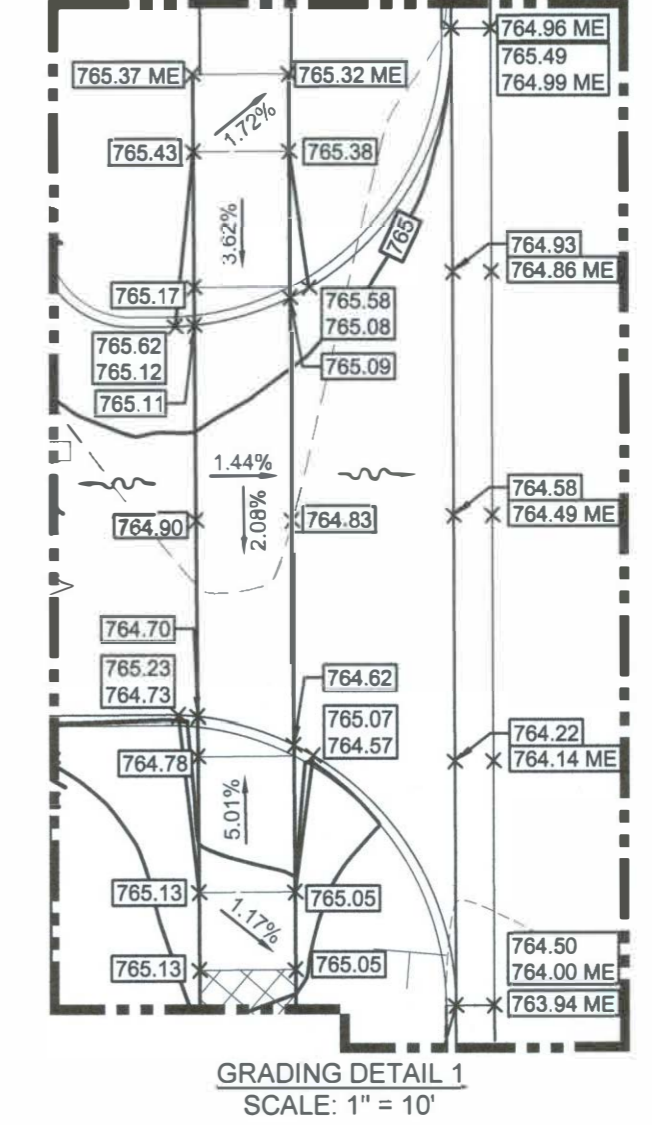
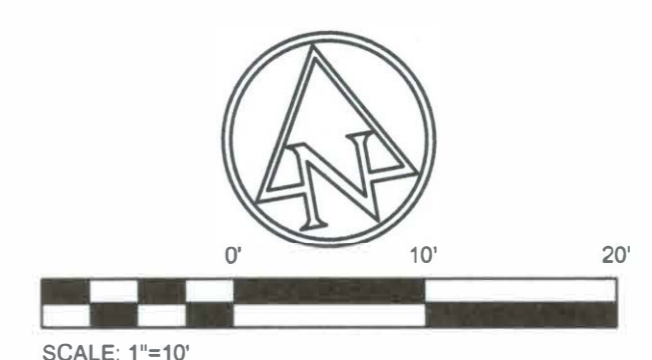

**STORM SEWER NOTES**

PROFILE DATUM NAVD '88

MAINTAIN A MINIMUM OF 18" VERTICAL AND 10' HORIZONTAL CLEARANCE FROM WATER MAINS

- \* COMPACTED BACKFILL PER ITEM 911
- \*\* COMPACTED GRANULAR BACKFILL PER ITEM 912

ALL FILLS ARE TO BE PLACED A MINIMUM OF 2.5' ABOVE THE PROPOSED STORM SEWER PER ITEM 203 PRIOR TO THE START OF STORM SEWER CONSTRUCTION

DENOTED THUS:

CONTRACTOR TO VERIFY ELEVATION AND LENGTH OF EXISTING STORM SEWER STUB BEFORE CONNECTING

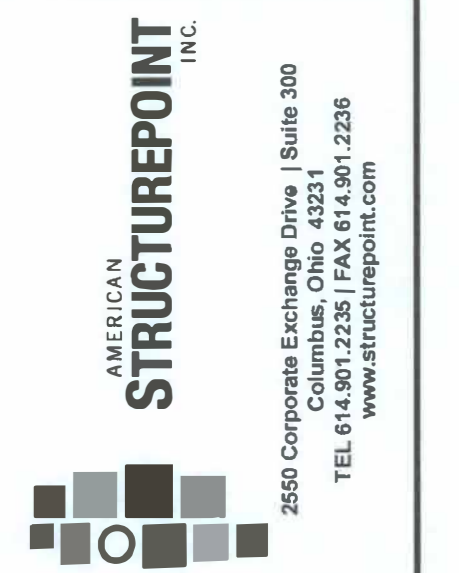

CONSTRUCTION DOCUMENTS FOR  
**OHIO STATE BANK**  
 CITY OF BEXLEY, FRANKLIN COUNTY, OHIO  
**GRADING PLAN**

REVISIONS	DATE	SHEET NO.	DESCRIPTION	APPROVED	DATE

DATE: 1/25/2019  
 DRAWN BY: JRP  
 CHECKED BY: OSD  
 JOB NUMBER: 2018.00600

**C400**