

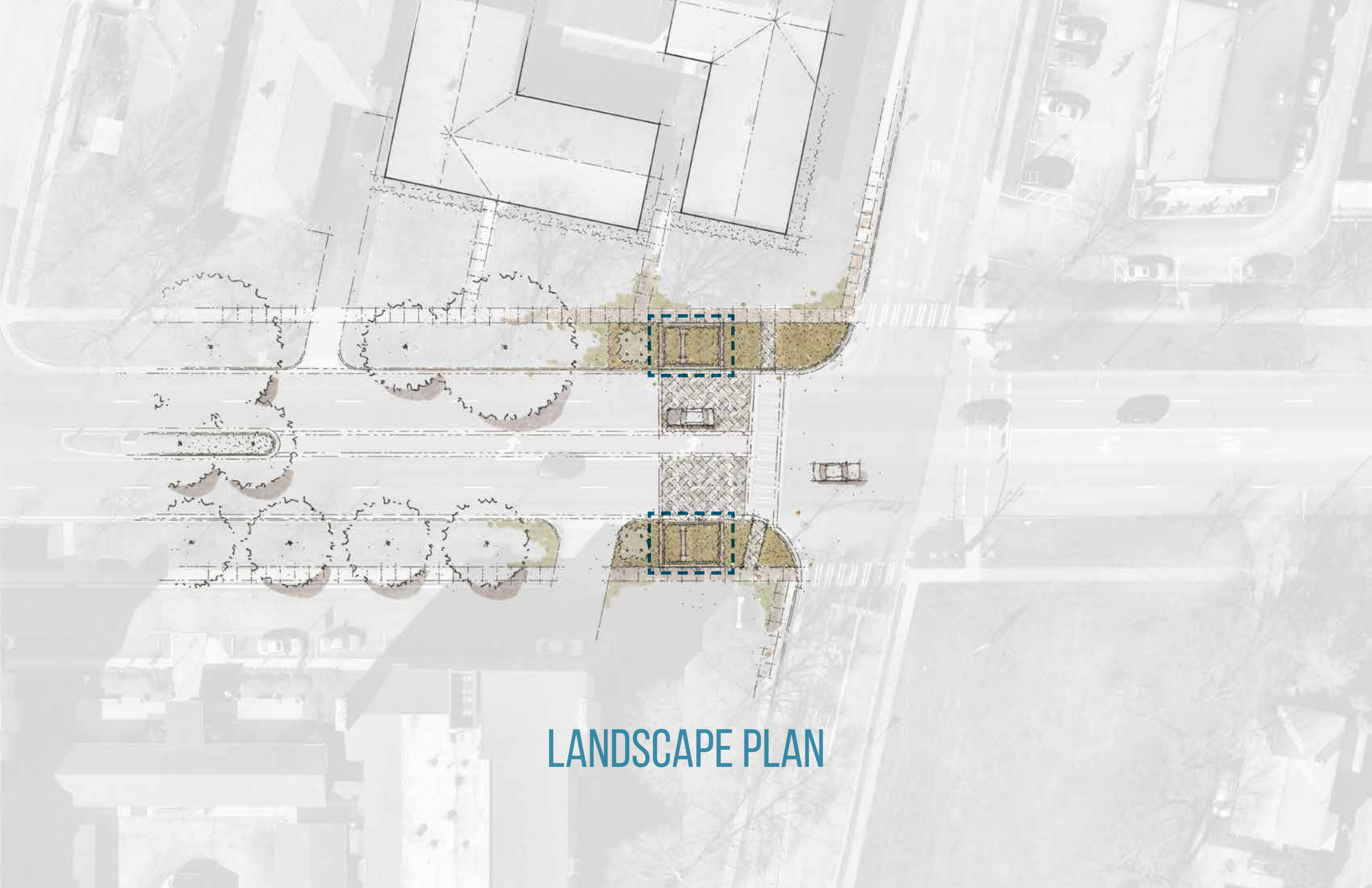

BROAD+GOULD **CITY OF BEXLEY GATEWAYS STRATEGIES**

TREE AND PUBLIC GARDENS COMMISSION

19 DECEMBER 2018



LANDSCAPE PLAN

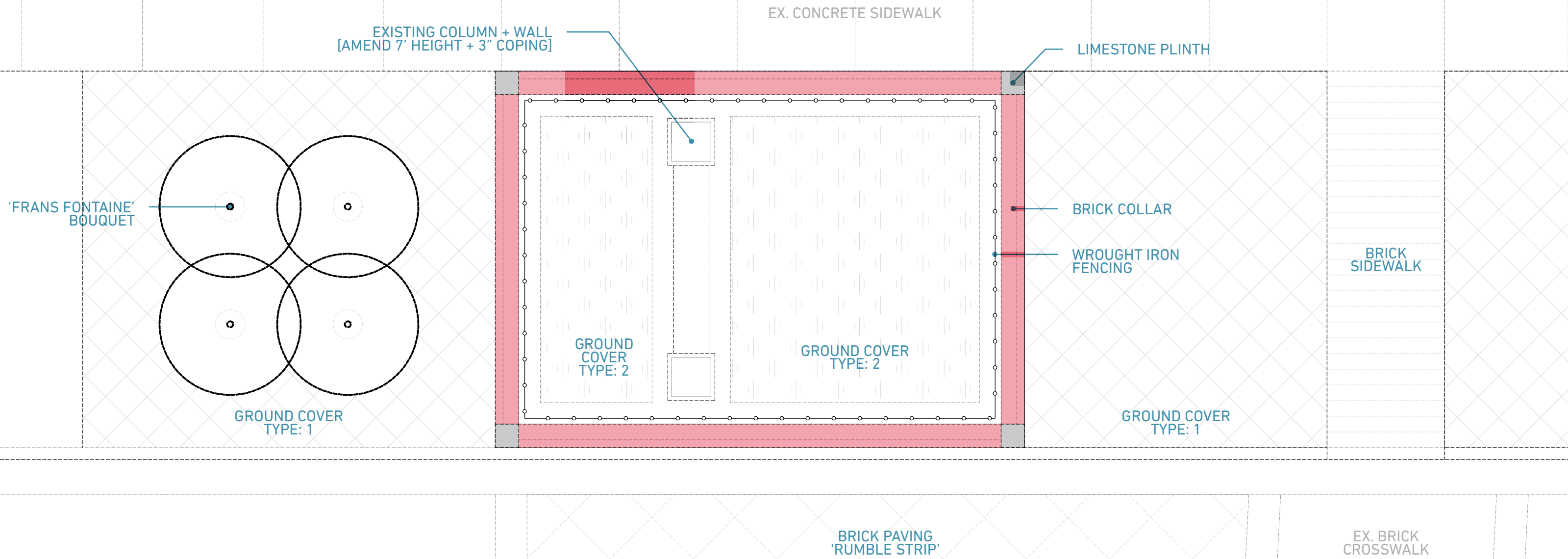

ORIGINAL PROPOSAL

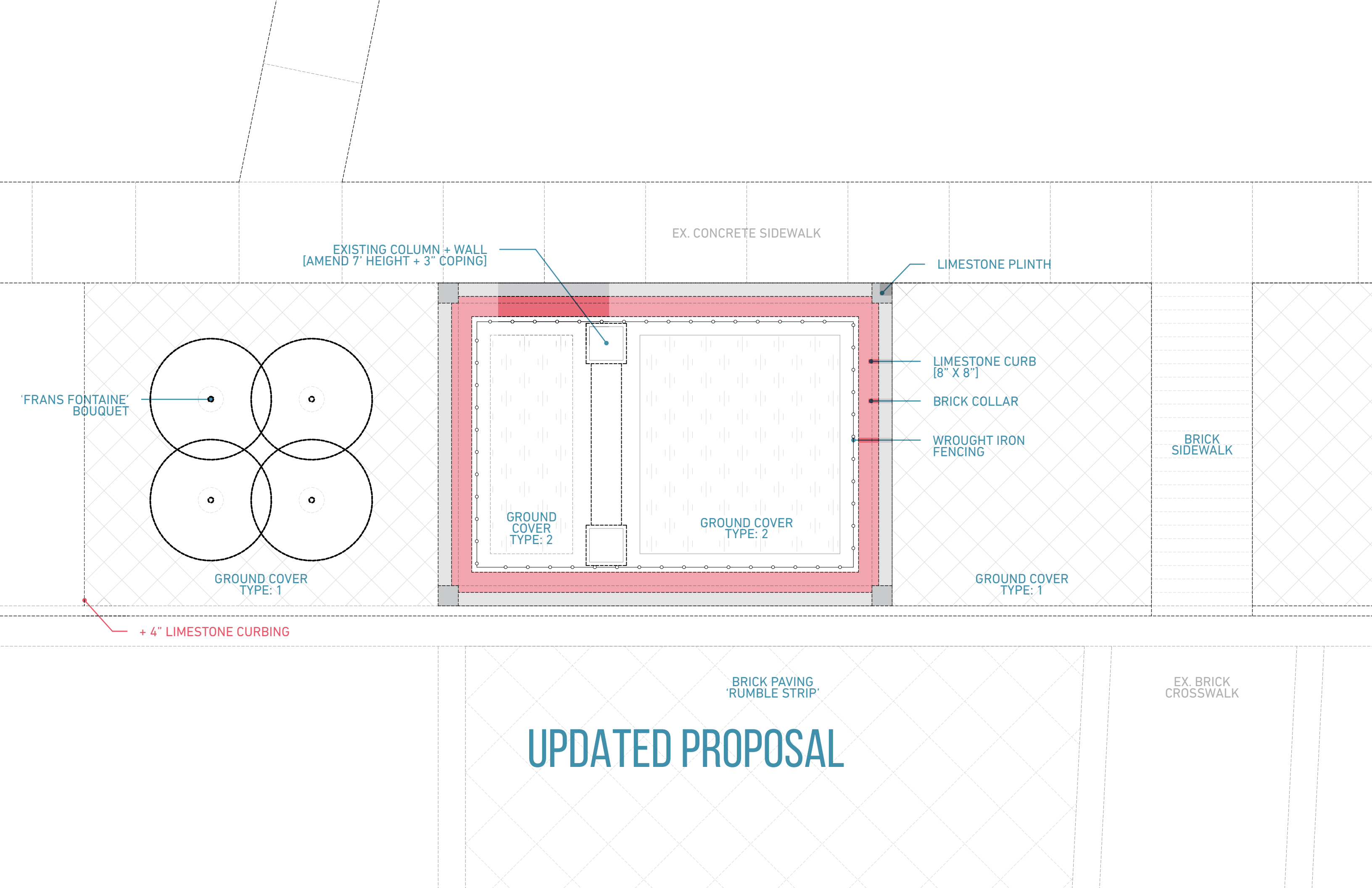

'FRANS FONTAINE'
BOUQUET

GROUND COVER
TYPE: 1

EXISTING COLUMN + WALL
[AMEND 7' HEIGHT + 3" COPING]

EX. CONCRETE SIDEWALK

LIMESTONE PLINTH

LIMESTONE CURB
[8" X 8"]

BRICK COLLAR

WROUGHT IRON
FENCING

BRICK
SIDEWALK

GROUND COVER
TYPE: 1

+ 4" LIMESTONE CURBING

BRICK PAVING
'RUMBLE STRIP'

EX. BRICK
CROSSWALK

UPDATED PROPOSAL

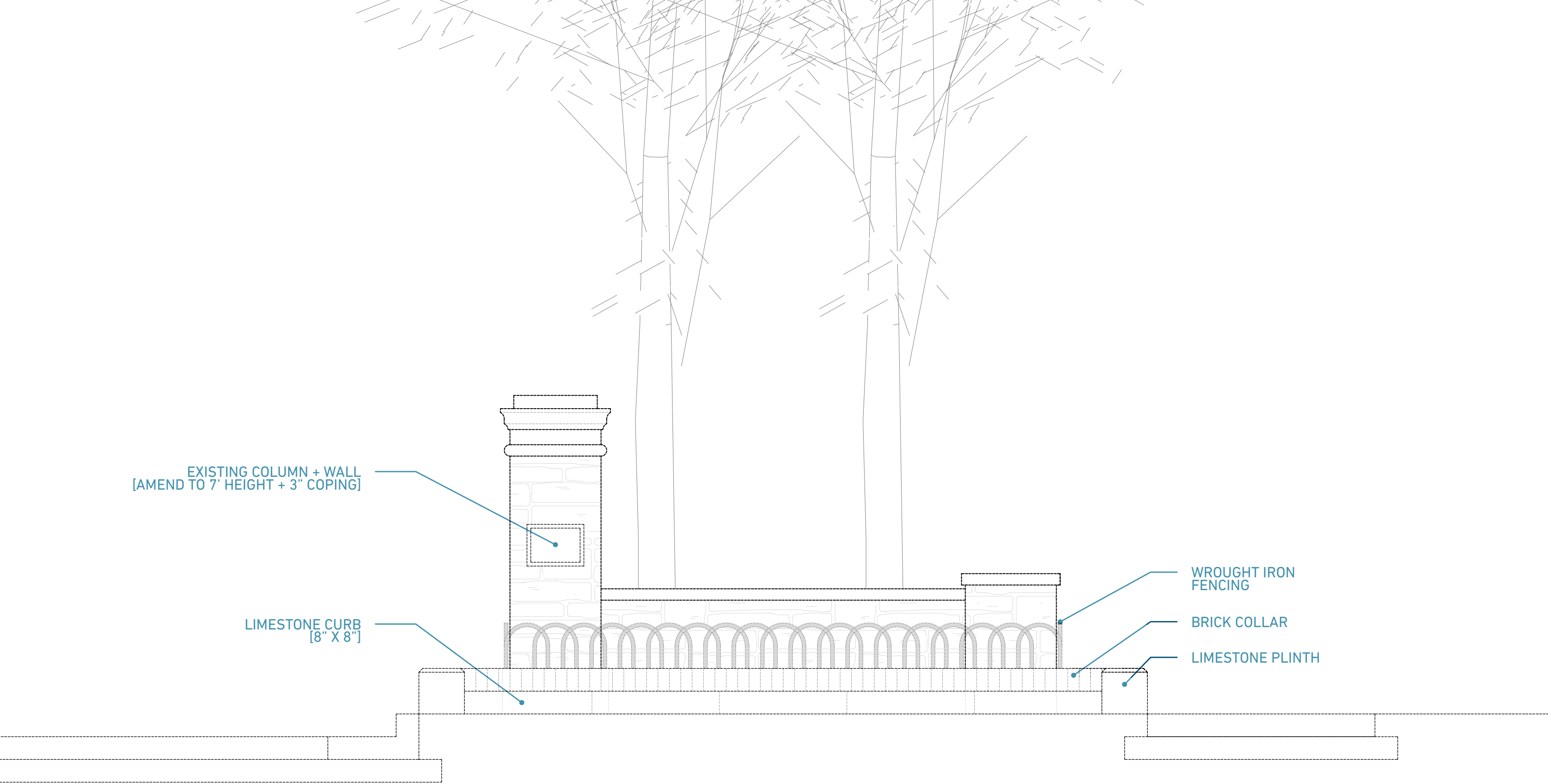

UPDATED PROPOSAL
HOOP FENCING

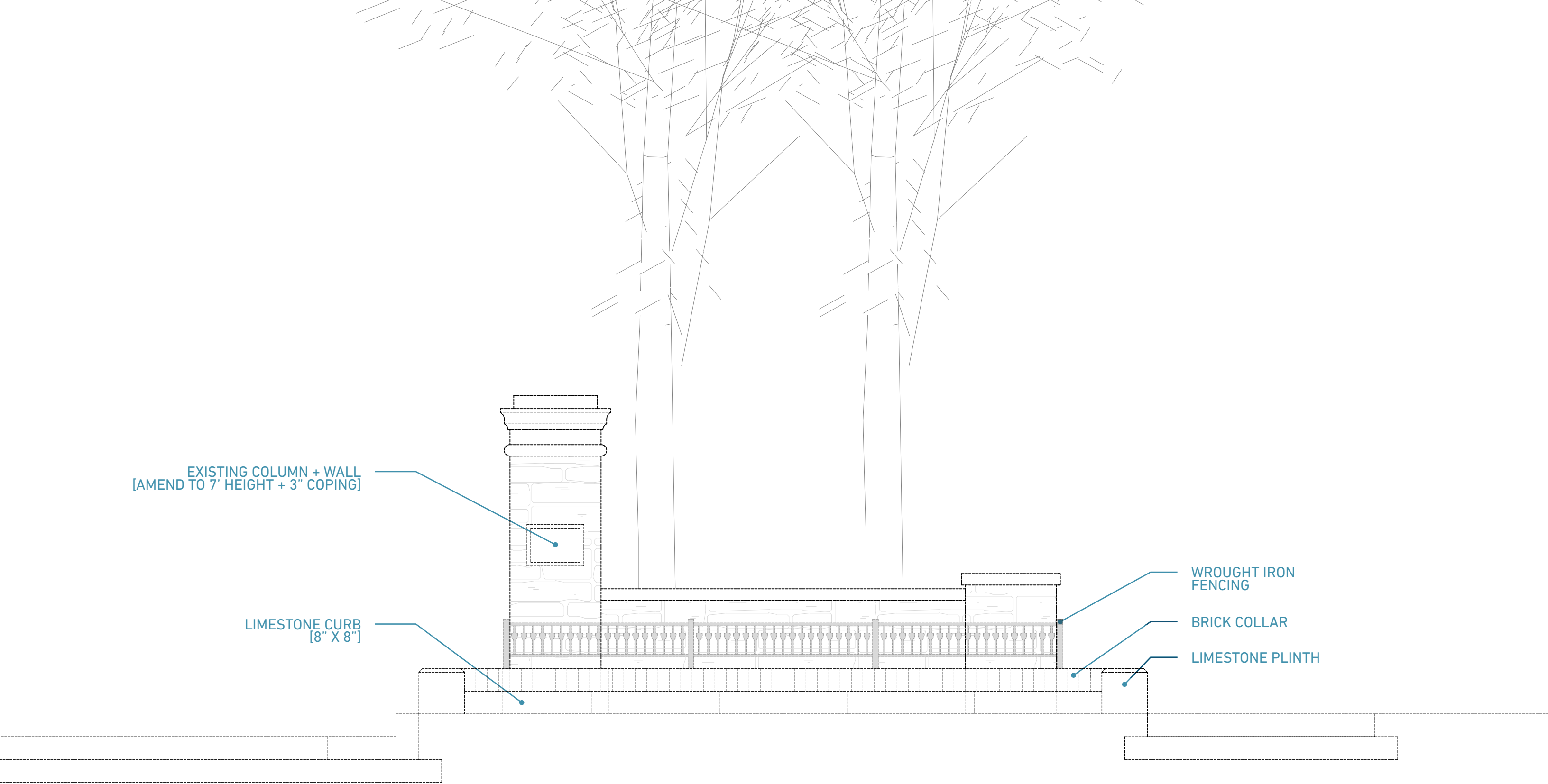

UPDATED PROPOSAL

FENCING TYPE: 2



DEMOLITION/REMOVALS VERTICAL VEGETATION GROUND COVERS/TURF LIMESTONE/BRICK COLLAR COLUMN CAP/COPING [CAP TO BE SALVAGED] CONCRETE WALKS/STREET	\$5,500 - \$8,500
EXCAVATION/CONCRETE + FOUNDATION WORK RESET STONE COLLARS BASE ALIGN PROPER INFRASTRUCTURE [TBD] SET SIDEWALK/RUMBLE STRIP BASE [TBD]	\$1,500 - \$2,500
MASONRY RESET COLUMN CAP [ADD 1' TO COLUMN HEIGHT = 7'] ADD 3" LIMESTONE COPING TO EXISTING WALL 'RE-TUCK' ENTIRE WALL [OR AS NEEDED TO STABALIZE] SET LIMESTONE PLINTHS/CURBING/BRICK COLLAR	\$12,000 - \$15,000
FLAT WORK [HARDSCAPE] SET BRICK SIDEWALKS/RUMBLE STRIP [TBD]	TBD
IRON WORK INSTALL SELECTED IRON FENCING	\$6,500 - \$8,000
LANDSCAPE/SOILS INSTALL TREES/GROUND COVERS TYPES/TURF REPAIR AMEND ALL GRADE TO TIE IN WITH EXISTING CONDITIONS	15,000 - \$20,000
DESIGN/PERMITTING/PROCESS/ADMIN. CONSTRUCTION DOCUMENTATION TO CITY'S DESIRE ALIGN PROPER ALLIED PROFESSIONALS STREET LANES/CONSTRUCTION PERMITS CONSTRUCTION ADMINISTRATION [AS NEEDED]	TBD

+ ADD UPLIGHTING AND POSSIBLE LIMESTONE CURBING AT
GROUND COVER-TURF INTERFACE.

COST ESTIMATING

A photograph of a street corner. In the foreground, a stone pillar with a plaque that reads "BEXLEY" stands next to a large, leafy tree. A bush of red flowers is in front of the pillar. To the left, a paved road with a white bicycle symbol is visible. In the background, there are more trees and a brick building. The text "NORTH SIDE" is overlaid in large, white, bold letters across the center of the image.

NORTH SIDE



BEXLEY













SOUTH SIDE



BEXLEY



