

# Capital Seminary Garden Landscape

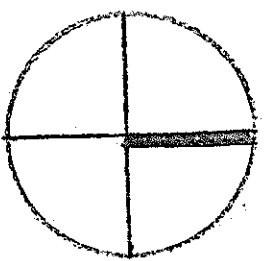

## Planting Plan

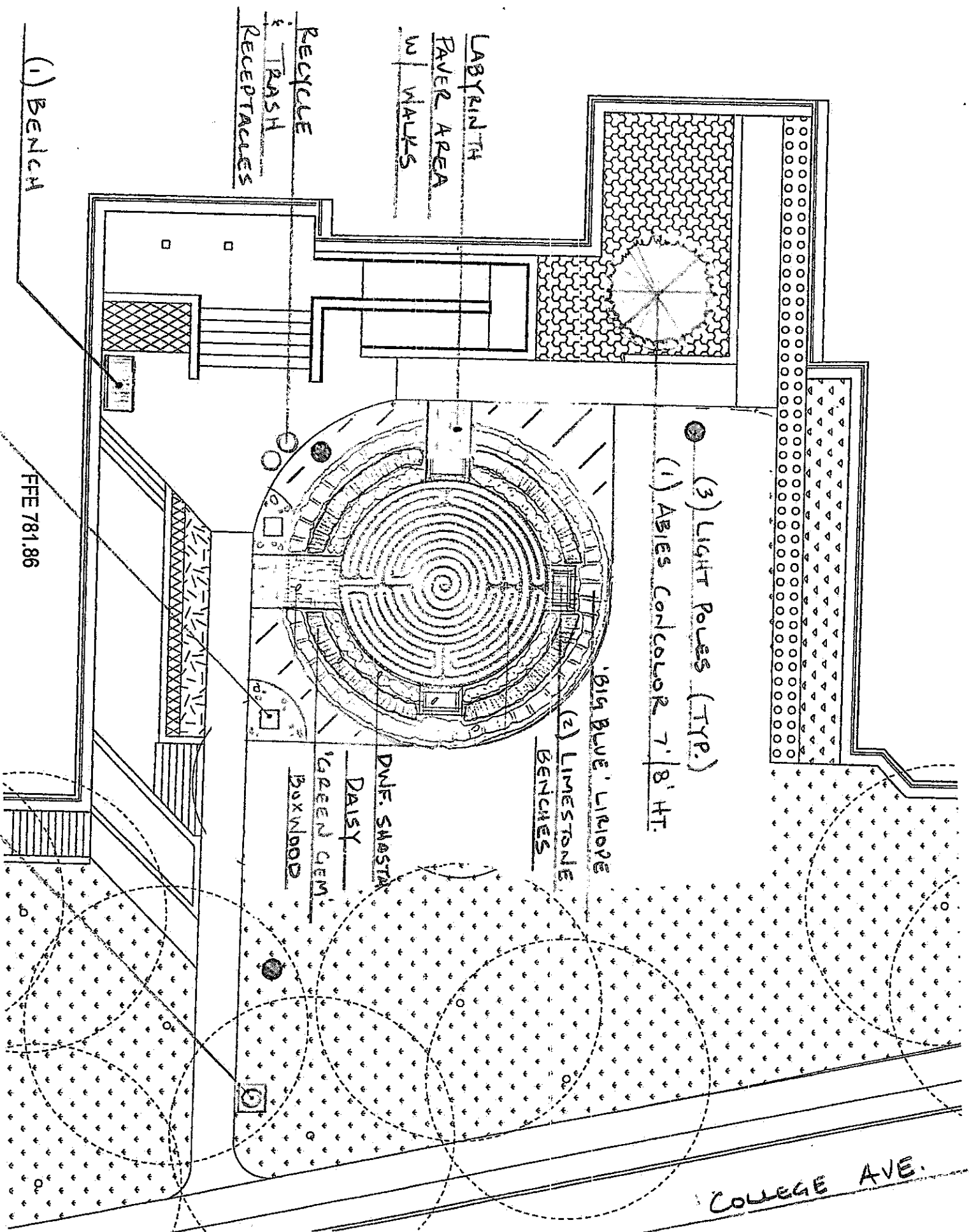

- TAXUS DENSIFORMIS (DENSE VIEW)**  
 HEIGHT: 3'-4' SPREAD: 8'  
 PLANTED 36" ON CENTER AND 24" AT INSTALLATION  
 ZONE 4
- LIRIOPÉ (CREEPING LILY TURF)**  
 HEIGHT: 12-18"  
 PLANTED 12" ON CENTER AND #1 CONTAINER  
 ZONE 4
- LAWN SODDED**  
 ZONE 4
- HOSTA 'PAUL'S GLORY' (PAUL'S GLORY HOSTA)**  
 HEIGHT: 24-30"  
 PLANTED 24" ON CENTER AND #1 CONTAINER  
 ZONE 4
- PACHYSANDRA TERMINALIS (PACHYSANDRA)**  
 HEIGHT: 6" SPREAD: GROUNDCOVER  
 #1 CONTAINER  
 ZONE 4
- PANICUM VIRGATUM V. SHEENANDAH (SHEENANDAH REED SWITCH GRASS)**  
 HEIGHT: 3-4'  
 PLANTED 18" ON CENTER AND #1 CONTAINER  
 ZONE 4
- GARRYANA BETULUS 'FASTIGIATA' (PYRAMIDAL EUROPEAN HORNBEECH)**  
 HEIGHT: 35' SPREAD: 25'  
 3" CALIPER  
 ZONE 4
- EXISTING TREES PRESERVE EXISTING**

(2) CATCH BASINS  
W/ RIVER ROCK

(1) TRASH RECEPTACLE  
ON STEPPING STONE PAD

(1) BENCH

FFE 781.86