

ORDINANCE NO. 25 - 07

By: Robyn Jones

An Ordinance to grant to Columbus Southern Power Company an easement for the installation of an electric transformer along Clifton Avenue in the approximate location as shown on the drawing marked Exhibit "A" which is attached to and made a part of this Ordinance and to declare an emergency.

*Whereas*, it is necessary to install an electric transformer to serve the new Bexley Municipal Pool facility; and,

*Whereas*, the location along Clifton avenue which is shown on the drawing marked Exhibit "A" has been determined to be the best location; and,

*Whereas*, the location shown on the drawing marked Exhibit "A" has been reviewed by and approved by the Bexley Planning Commission. **NOW, THEREFORE,**

**BE IT ORDAINED BY THE COUNCIL OF THE CITY OF BEXLEY, OHIO:**

Section 1. That an easement should be and hereby is granted to Columbus Southern Power Company for the installation of an electric transformer along Clifton Avenue in the approximate location as shown on the drawing marked Exhibit "A" which is attached to and made a part of this Ordinance and that the mayor is hereby authorized to execute and deliver an instrument granting said easement, in a form approved by the City Attorney.

Section 2. That this Ordinance is an emergency Ordinance necessary for the preservation of the public health and welfare, said emergency being the need to supply electric to the new pool facility immediately to coordinate with construction, and shall go into effect and be in force upon its passage and approval by the Mayor.

Passed: 3.27, 2007

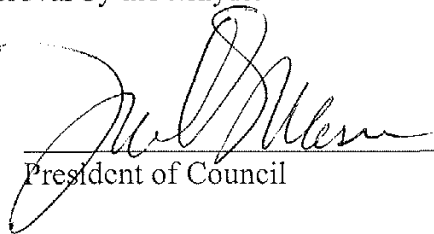
  
\_\_\_\_\_  
President of Council

Attest:   
\_\_\_\_\_  
Clerk of Council

Approved: 3.27, 2007

  
\_\_\_\_\_  
David H. Madison, Mayor

3.13.07 First Reading  
3.27.07 Second Reading  
3 Reading rule suspended.  
Passed.

# EXHIBIT "A"

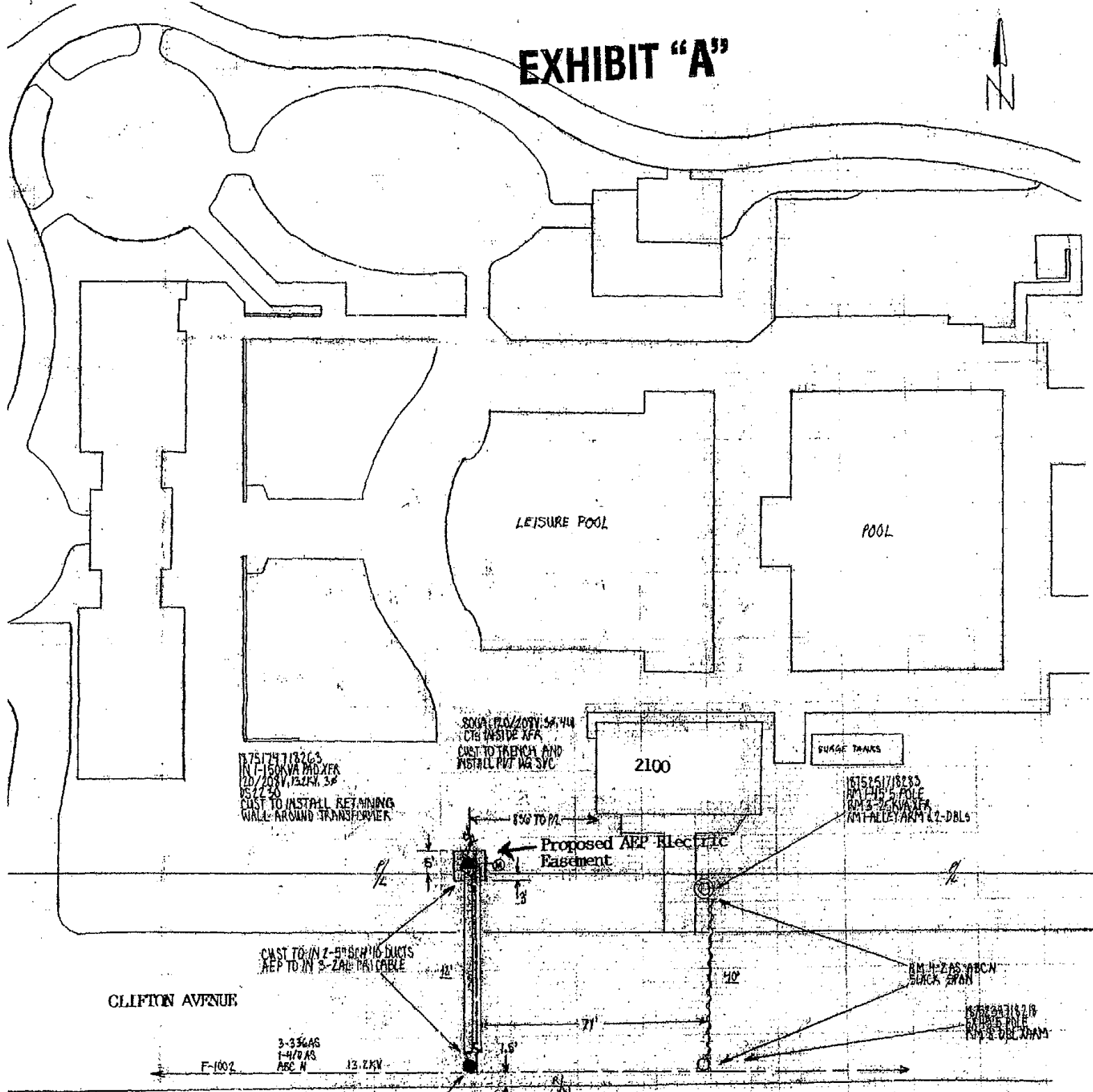

CLIFTON AVENUE

2100 CLIFTON AVENUE  
PRINT NO. 121784

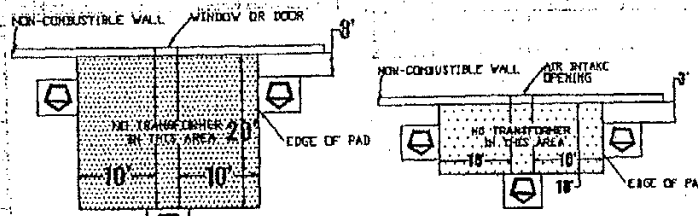
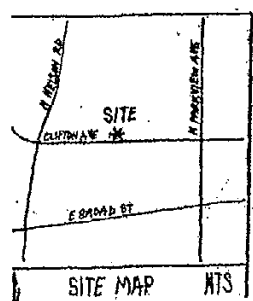

TRANSFORMER SHOULD NOT BE LOCATED WITHIN A ZONE EXTENDING 20' OUTWARD AND 10' TO EITHER SIDE OF AN AIR INTAKE OPENING. IF THE AIR INTAKE IS ABOVE THE TRANSFORMER, THERE MUST BE A 20' VERTICAL DISTANCE FROM THE OPENING TO THE TRANSFORMER.

TRANSFORMER SHOULD NOT BE LOCATED WITHIN A ZONE EXTENDING 20' OUTWARD AND 10' TO EITHER SIDE OF AN AIR INTAKE OPENING. IF THE AIR INTAKE IS ABOVE THE TRANSFORMER, THERE MUST BE A 20' VERTICAL DISTANCE FROM THE OPENING TO THE TRANSFORMER.