

Meadow Park Avenue

Exhibits for BZAP Meeting February 25, 2021

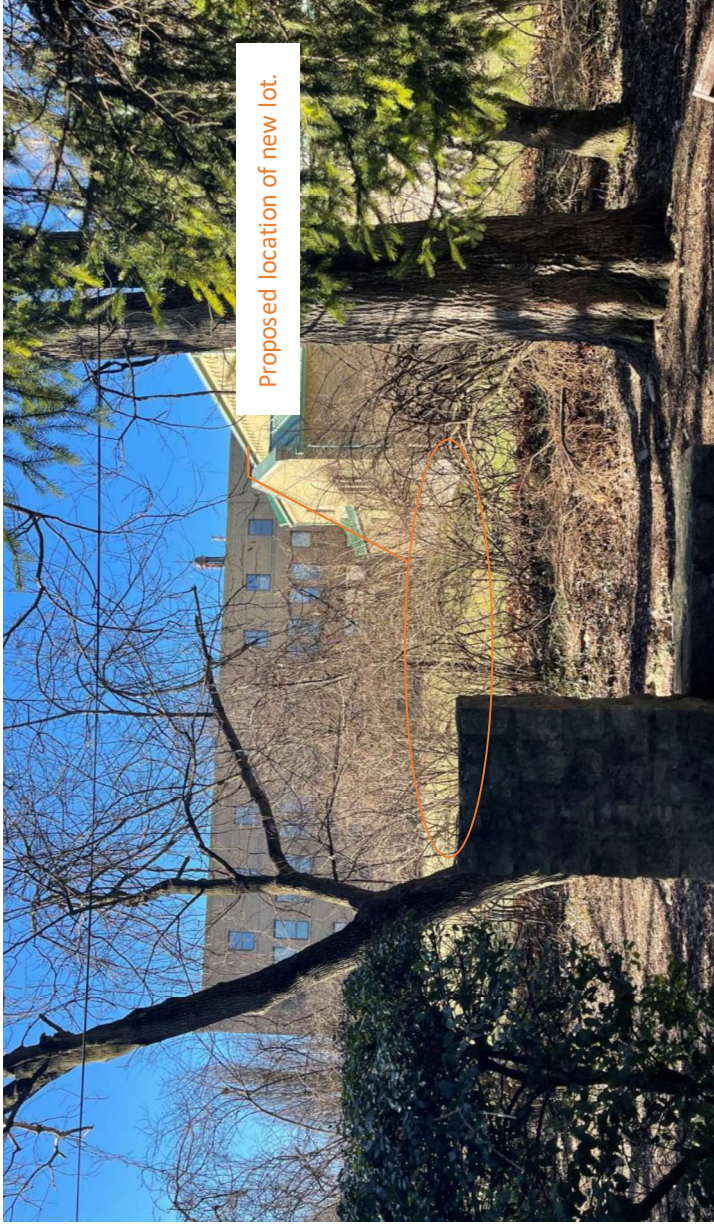

- Photo taken 1/30/2021
12:58 PM
- No Privacy at rear of property during fall/winter.
- No current or proposed safety measures between property line and proposed lot.

31 Meadow Park

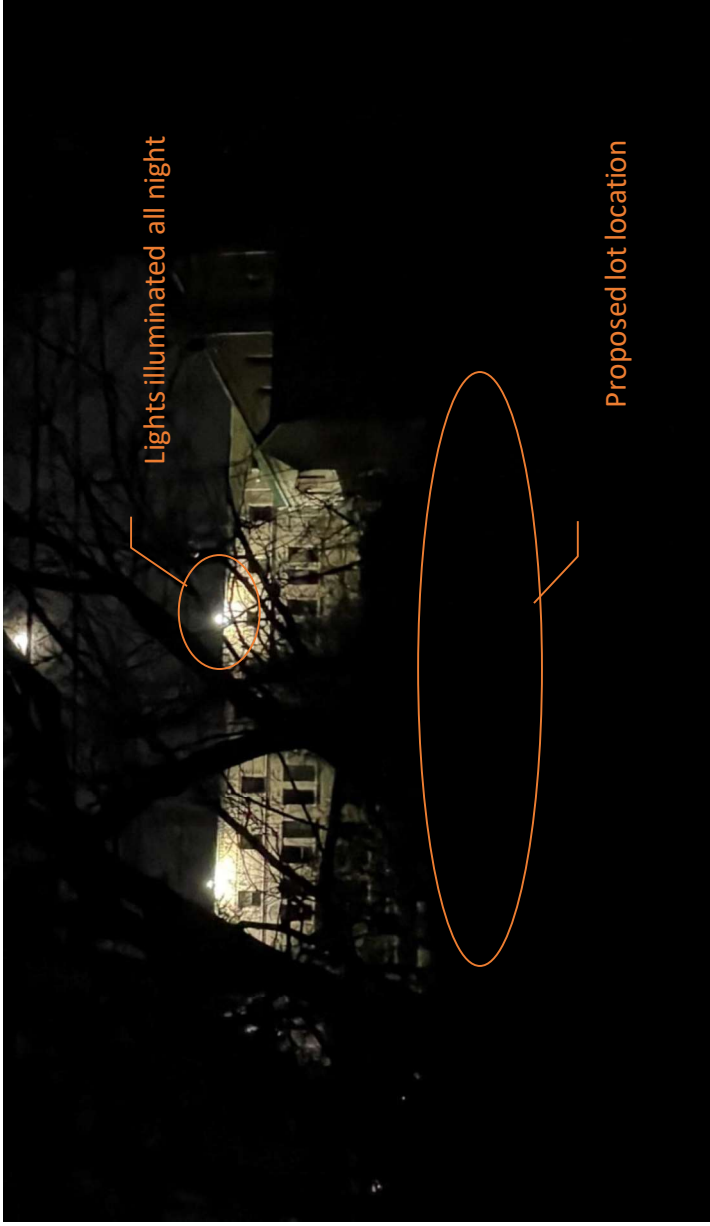

Lights illuminated all night

Proposed lot location

31 Meadow Park

- Photo taken 1/30/2021 6:54 AM
- Inadequate lighting at proposed lot.
- Existing lights illuminated all night.

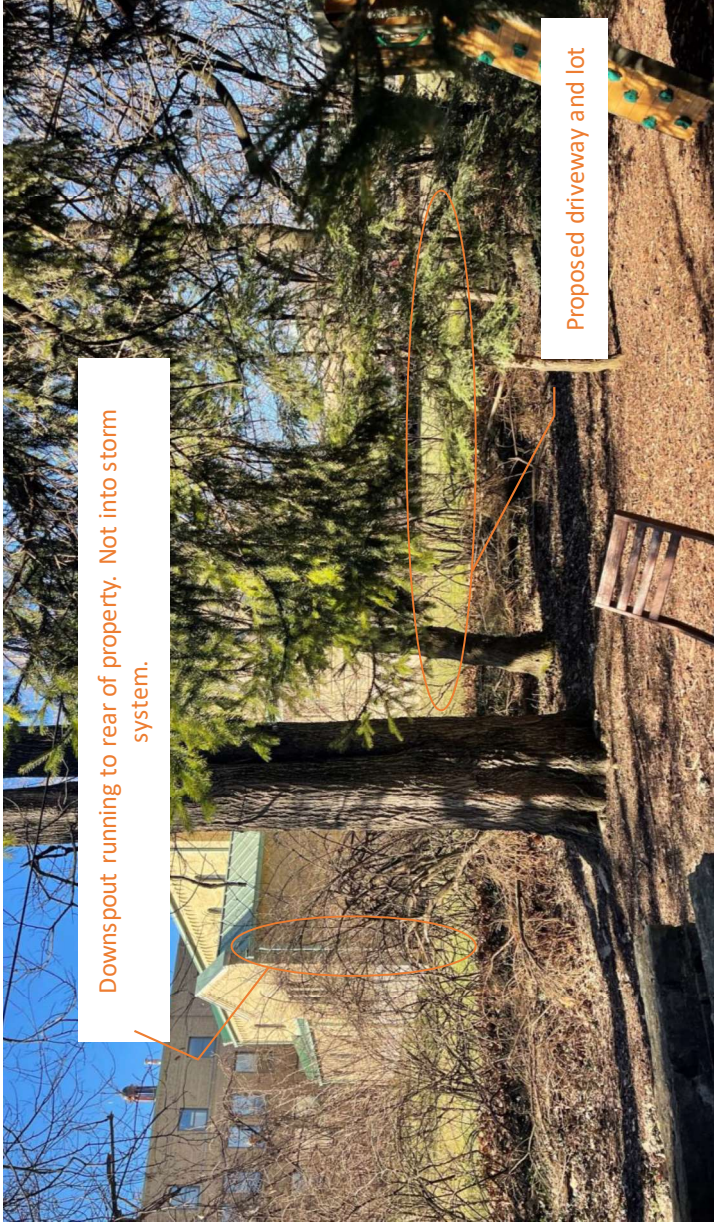

31 Meadow Park

- Photo taken 1/30/2021
12:58 PM
- No Privacy at rear of property during fall/winter.
- No current or proposed safety at rear of property between property line and proposed driveway.

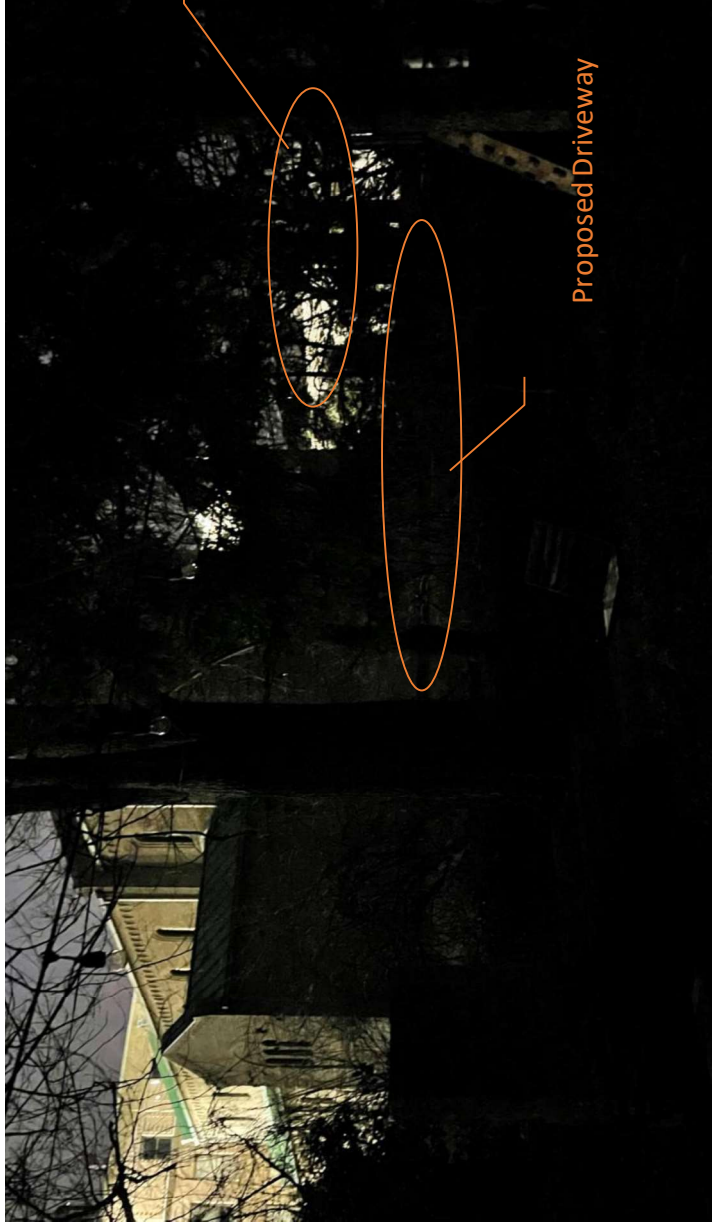

Lights at Northeast side of school illuminated all night.

- Photo taken 1/30/2021 6:54 AM
- Inadequate existing or proposed lighting for driveway.

31 Meadow Park



- Drainage issue at rear of property.

51 Meadow Park



No safety mitigation or light mitigation from existing lot to rear of property. Existing lot was never approved.

- Standing water at rear of property.
- Dead evergreen pine trees provide no privacy.
- Unable to grow grass at rear of property due to drainage issues.

55 Meadow Park

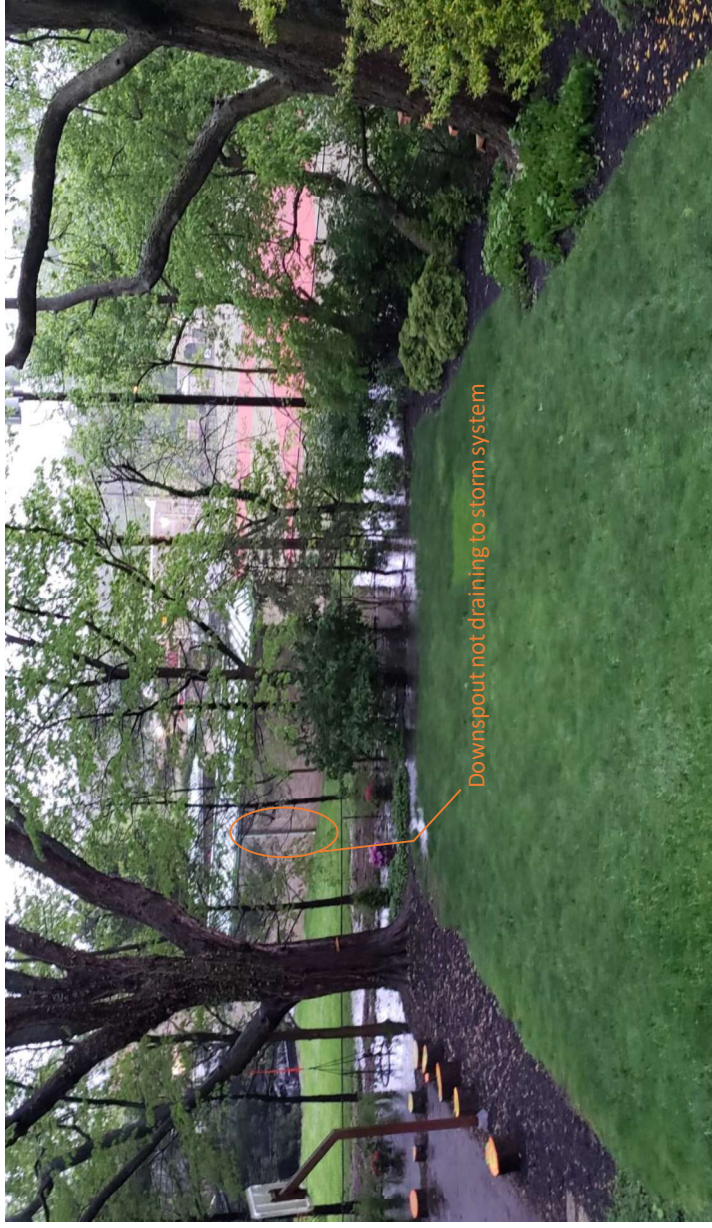

75 Meadow Park

- Taken May 19, 2020
- Standing water at rear of property due to improper drainage
- Chain link fence:
 - 1264.05(b): Any fence or wall erected along the property lines of the commercial use must have the finished and not the structural side facing the adjacent property.
 - 1264.05(d): No chain link, wire mesh or other similar material shall be installed.
 - 1264.05(e): The fence design shall be 100-percent opaque from any viewing angle, and approved by the Building Department.

Trees offer no privacy



Downspout runoff to back of property

- Taken May 19, 2020
- Standing water at rear of property due to improper drainage
- Chain link fence:
 - 1264.05(b): Any fence or wall erected along the property lines of the commercial use must have the finished and not the structural side facing the adjacent property.
 - 1264.05(d): No chain link, wire mesh or other similar material shall be installed.
 - 1264.05(e): The fence design shall be 100-percent opaque from any viewing angle, and approved by the Building Department.

75 Meadow Park



75 Meadow Park

- Taken May 19, 2020
- Standing water at rear of property due to improper drainage
- Chain link fence:
 - 1264.05(b): Any fence or wall erected along the property lines of the commercial use must have the finished and not the structural side facing the adjacent property.
 - 1264.05(d): No chain link, wire mesh or other similar material shall be installed.
 - 1264.05(e): The fence design shall be 100-percent opaque from any viewing angle, and approved by the Building Department.

Storm Drainage

