

House Band-attached to house with 1/2" x 4" lag bolts with flashing behind house band and L-flashing on top of house band tucking up under siding

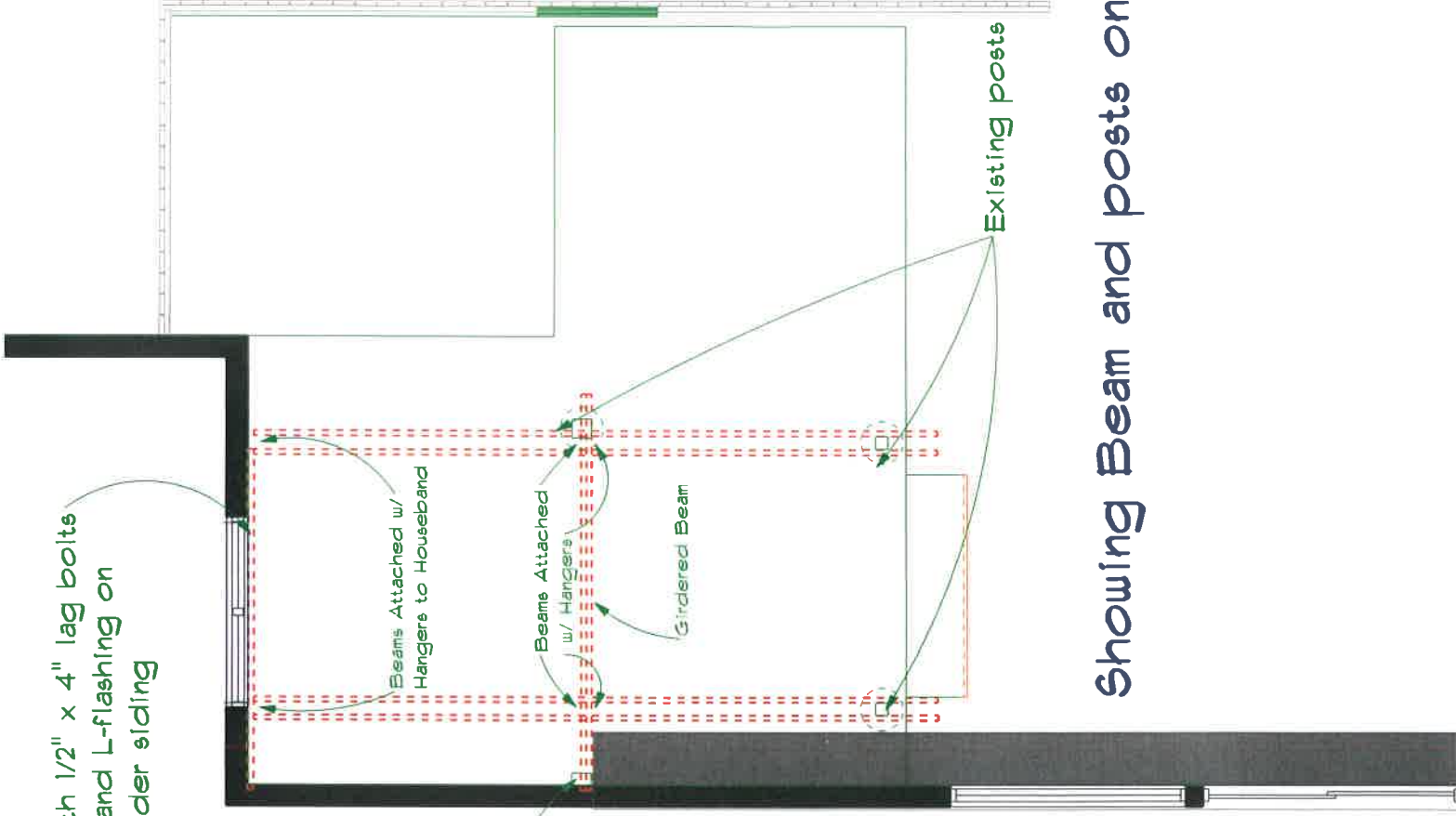

New pocketed post

Existing posts

Showing Beam and posts only



House

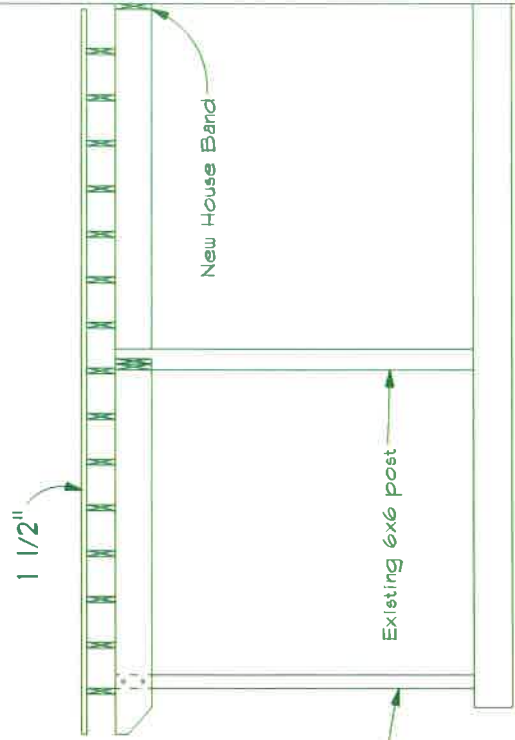

New House Band

Existing 6x6 post

1 1/2"

7 1/2"

9 1/2"

1'-0"

8'-6 1/2"

Existing 4x4 post

View from Side Yard

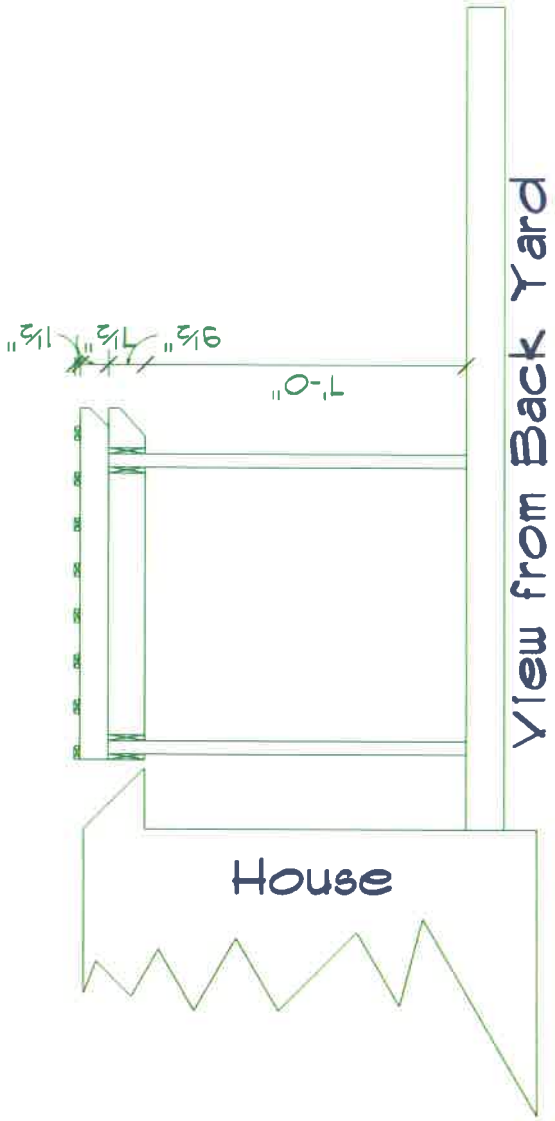



close up side view



VIEW OF UNDER SIDE



Back yard view



VIEW OF HOUSE BAND



SIDE VIEW