

BEXLEY PARK RD.

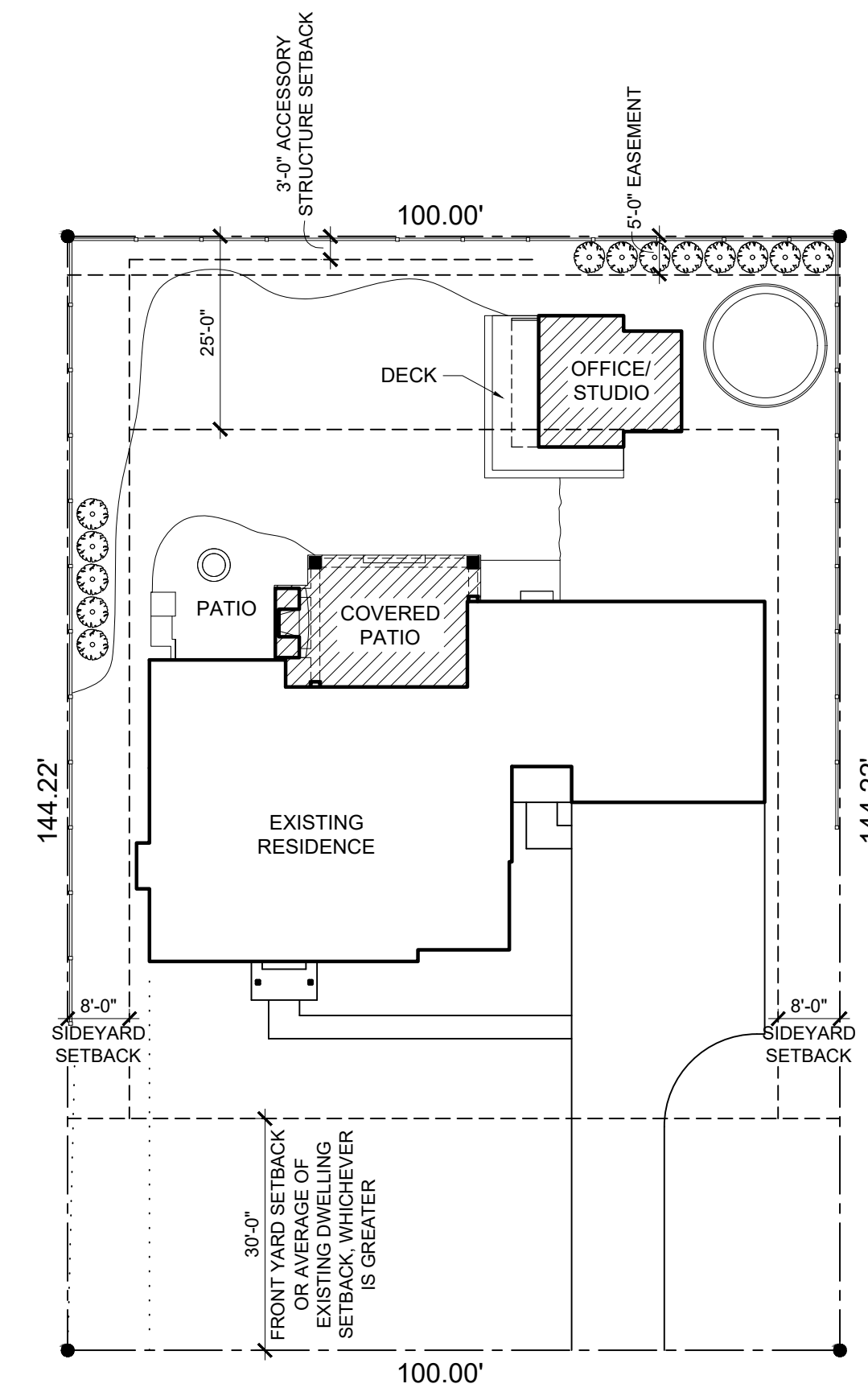

BEXLEY PARK RD.

**SITE PLAN**  
EXISTING  
SCALE: 1" = 20'-0"

ZONING INFORMATION

ZONING DISTRICT	R-6 HIGH DENSITY RESIDENTIAL
PARCEL ID:	020-002703-00
LOT AREA	14,422 SQ. FT.
EXISTING BUILDING COVERAGE	2,632 SQ. FT.
PERMITTED BUILDING COVERAGE	5,048 SQ. FT.
EXISTING DEVELOPMENT COVERAGE	4,853 SQ. FT.
PERMITTED DEVELOPMENT COVERAGE	8,653 SQ. FT.
ACCESSORY STRUCTURE	35% FOOTPRINT (908.6) OF PRINCIPAL STRUCTURE OR 624 SQ. FT.

**SITE PLAN**  
PROPOSED  
SCALE: 1" = 20'-0"

ZONING INFORMATION

ZONING DISTRICT	R-6 HIGH DENSITY RESIDENTIAL
PARCEL ID:	020-002703-00
LOT AREA	14,422 SQ. FT.
PROPOSED BUILDING COVERAGE	3,627 SQ. FT.
PERMITTED BUILDING COVERAGE	5,048 SQ. FT.
PROPOSED DEVELOPMENT COVERAGE	5,351 SQ. FT.
PERMITTED DEVELOPMENT COVERAGE	8,653 SQ. FT.
ACCESSORY STRUCTURE	475 SQ. FT.

COPYRIGHT 2021

THE DRAWINGS, SPECIFICATIONS AND OTHER DOCUMENTS GENERATED SHALL REMAIN THE PROPERTY OF GARY J. ALEXANDER, ARCHITECT AND MAY NOT BE USED, DUPLICATED, OR ALTERED, WITHOUT WRITTEN CONSENT OF THE ARCHITECT.

ADDITIONS TO THE  
THE MUGLER RESIDENCE  
2562 BEXLEY PARK RD

Gary J. Alexander,  
Architect  
1265 Neil Avenue, Columbus, Ohio 43201  
(614) 487-0637

PROGRESS: 02-11-2021

A-1