

ALL CONSTRUCTION PLANS ARE PROVIDED AS IS. ARCHADECK FRANCHISING CORPORATION DISCLAIMS ALL OTHER WARRANTIES, EXPRESS OR IMPLIED, INCLUDING MERCHANTABILITY OR FITNESS OF PURPOSE. ARCHADECK FRANCHISING CORPORATION IS NOT LIABLE FOR INCIDENTAL, SPECIAL, CONSEQUENTIAL, OR INDIRECT DAMAGES OF ANY KIND, INCLUDING, BUT NOT LIMITED TO, LOSS OF ANTICIPATED PROFITS, BUSINESS OPPORTUNITY OR OTHER ECONOMIC LOSS ARISING OUT OF THE USE OF SERVICES OR ANY CONSTRUCTION PLANS RECEIVED FROM ARCHADECK FRANCHISING CORPORATION, EVEN IF ARCHADECK FRANCHISING CORPORATION HAS BEEN ADVISED OF THE POSSIBILITY OF SUCH DAMAGE. IT IS THE BUILDER'S RESPONSIBILITY TO ENSURE THE ACCURACY, COMPLIANCE WITH APPLICABLE STATUTE(S) OR REGULATION(S), AND FITNESS OF PURPOSE OF ANY PLANS OR CONSTRUCTION INFORMATION RECEIVED FROM ARCHADECK FRANCHISING CORPORATION PRIOR TO THE USE THEREOF.

ARCHADECK FRANCHISING CORPORATION IS NOT ENGAGED IN RENDERING PROFESSIONAL SERVICES OR ADVICE. USE OF ANY CONSTRUCTION INFORMATION PROVIDED BY ARCHADECK FRANCHISING CORPORATION IS SUBJECT TO THE ADDITIONAL DISCLAIMERS AND CAVEATS THAT MAY APPEAR THROUGHOUT THE CONSTRUCTION PLANS, CONTRACTS AND OTHER DOCUMENTS PROVIDED TO THE BUILDER AND CUSTOMER.

DESIGN LOAD CRITERIA

| FOOTING/FOUNDATION LOADS | P.S.F. | CEILING | P.S.F. |
|---------------------------|--------|-------------------------|--------|
| LIVE LOAD | 50 | WITH STORAGE (L/240) | 20 |
| DEAD LOAD | 10 | WITHOUT STORAGE (L/240) | 10 |
| TOTAL DESIGN LOAD | 60 | | |
| DECK LOADS (L/240) | P.S.F. | WITH STORAGE (L/360) | P.S.F. |
| (DECK FRAMING) | | WITHOUT STORAGE (L/360) | 10 |
| FRAMING DESIGN LIVE LOAD | 60 | DEAD LOAD | 10 |
| FRAMING DESIGN DEAD LOAD | 10 | | |
| TOTAL FRAMING DESIGN LOAD | 70 | ROOF LOADS (L/240) | P.S.F. |
| FLOOR LOADS (L/360) | P.S.F. | SNOW LOAD | 20 |
| LIVE LOAD (LIVING) | 40 | DEAD LOAD | 10 |
| LIVE LOAD (SLEEPING) | 30 | TOTAL DESIGN LOAD | 30 |
| DEAD LOAD | 10 | PERGOLA LOADS (L/240) | P.S.F. |
| SPA LOADS (L/240) | P.S.F. | LIVE LOAD | 10 |
| LIVE LOAD | 100 | DEAD LOAD | 5 |
| DEAD LOAD | 10 | TOTAL DESIGN LOAD | 15 |
| TOTAL DESIGN LOAD | 110 | | |



ASSUMED OPEN FRAMED PERGOLA, NOT DESIGNED FOR SNOW LOADS

ABRAMS
#56-101426
929 VERNON ROAD
BEXLEY, OH, 43209

ABBREVIATIONS:

| | | | |
|---------|--------------------------|--------|---------------------------|
| #B | - BEAM | GLU. | - GLULAM |
| #BB | - BAND BOARD | H.D.G. | - HOT DIPPED GALVANIZED |
| #C | - RAIL CAP LENGTH | HDR. | - HEADER |
| #CB | - COLLAR BEAM | INT. | - INTERIOR |
| #DB | - DOUBLE BAND | IN. | - INCH |
| #DJ | - DOUBLE JOIST | LBS. | - POUNDS |
| #DR | - DOUBLE RAFTER | L.L. | - LIVE LOAD |
| #F | - FENCE CAP LENGTH | L.V.L. | - LAMINATED VENEER LUMBER |
| #G | - GIRDER | LWR. | - LOWER |
| #HB | - HOUSE BAND | MANUF. | - MANUFACTURER |
| #HBE | - HOUSE BAND EXTENSION | MAX. | - MAXIMUM |
| #KB | - KING BEAM | MIN. | - MINIMUM |
| #QJ | - QUAD JOIST | MOD. | - MODIFIED |
| #RB | - RIDGE BEAM | N.T.S. | - NOT TO SCALE |
| #RP | - ROOF PLATE | O.C. | - ON CENTER |
| #TB | - TRIPLE BAND | OPT. | - OPTIONAL |
| #TJ | - TRIPLE JOIST | O.S.B. | - ORIENTED STRAND BOARD |
| ALT. | - ALTERNATE | P.L. | - POINT LOAD |
| ALUM. | - ALUMINUM | P.L.F. | - POUNDS PER LINEAR FOOT |
| APPROX. | - APPROXIMATE | P.S.F. | - POUNDS PER SQUARE FOOT |
| BD. | - BOARD | P.S.I. | - POUNDS PER SQUARE INCH |
| B.O.B. | - BOTTOM OF BEAM | P.S.L. | - PARALLEL STRAND LUMBER |
| ☉ | - CENTER LINE | P.T. | - PRESSURE TREATED |
| CJ | - CEILING JOIST | P.T.T. | - POUR TO TOP |
| C.M.U. | - CONCRETE MASONRY UNIT | P.V.C. | - POLY VINYL CHLORIDE |
| CONC. | - CONCRETE | RBD. | - RIDGE BOARD |
| CONT. | - CONTINUOUS | REQD. | - REQUIRED |
| DBL. | - DOUBLE | R.O. | - ROUGH OPENING |
| DIA. | - DIAMETER | RSW | - RIDGE SUPPORT WALL |
| DIM. | - DIMENSION | S.F. | - SQUARE FOOT/FEET |
| D.L. | - DEAD LOAD | S.S. | - STAINLESS STEEL |
| DN. | - DOWN | SQ. | - SQUARE |
| DTL. | - DETAIL | T&G | - TONGUE & GROOVE |
| ELEC. | - ELECTRICAL | T.O.B. | - TOP OF BEAM |
| ELEV. | - ELEVATION (SEE T.O.D.) | T.O.C. | - TOP OF CONCRETE |
| EQUIV. | - EQUIVALENT | T.O.D. | - TOP OF DECK |
| EXT. | - EXTERIOR | TYP. | - TYPICAL |
| FIN. | - FINISH | U.N.O. | - UNLESS NOTED OTHERWISE |
| FLR. | - FLOOR | UPR. | - UPPER |
| FND. | - FOUNDATION | W/ | - WITH |
| FT. | - FOOT/FEET | W/O | - WITHOUT |
| F.V. | - FOUNDATION VENT | | |

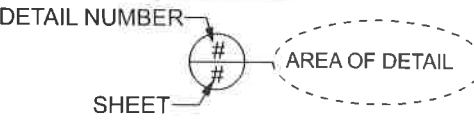
SYMBOL LEGEND

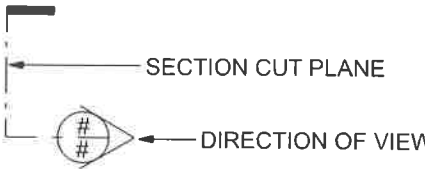
| | |
|---|--|
|  T.O.D. TAG ELEVATION AT POINT OF TAG |  DETAIL TAG DETAIL NUMBER SHEET AREA OF DETAIL |
|  STAIR TAG # DN |  SECTION TAG SECTION CUT PLANE DIRECTION OF VIEW |
| <ul style="list-style-type: none"> ■ - 4 x 4 DECK COLUMN ■ - 4 x 6 DECK COLUMN ■ - 6 x 6 DECK COLUMN | <ul style="list-style-type: none"> □ - RAIL POST ☒ - FENCE POST ☒ - ROOF POST/ PERGOLA POST ☒ - STUD LOCATION X - X BRACING Ⓟ - PARTING BOARD LOCATION AND CENTER LINE |

DESIGN CRITERIA:

- NOTES:**
- THIS PROJECT HAS BEEN DESIGNED FOLLOWING THE REGULATIONS OF THE 2019 ORC (OHIO RESIDENTIAL CODE).
 - WORK TO MEET LOCAL, STATE AND APPLICABLE RULES AND REGULATIONS.
 - IN-GRADE DESIGN VALUES BASED ON AF&PA.
 - PROVIDE JOIST HANGERS @ ALL FLUSH FRAME CONDITIONS.
 - PRESUMPTIVE SAFE SOIL BEARING CAPACITY IS 1500 PSF.
 - FROST LINE 36".
 - CONNECTIONS TO EXISTING STRUCTURE FLASHED PER LOCAL CODE

LUMBER:

- ALL FRAMING LUMBER TO BE #2 S.P. (SOUTHERN PINE) OR BETTER, TREATED FOR EXTERIOR USE, PER LOCAL CODE U.N.O.
- ALL PSL ENGINEERED TYPE LUMBER TO BE TREATED FOR EXTERIOR USE: P.S.L. STRESS CLASS (2.0E, 2900Fb) P.S.I.
- ALL GLULAM ENGINEERED TYPE LUMBER TO BE TREATED FOR EXTERIOR USE: GLULAM STRESS CLASS (1.9E, 2600Fb) P.S.I.
- ALL LVL/MICROLAM ENGINEERED TYPE LUMBER TO BE INTERIOR USE ONLY: L.V.L. STRESS CLASS (1.8E, 2600Fb) P.S.I.

CONCRETE:

- MINIMUM 28 DAY COMPRESSIVE STRENGTH = 3000 PSI.

Climatic and Geographic Design Criteria (2013 RCO Table 301.2 (1))

| Roof Snow Load (lb per sq. ft.) | Wind Design | Seismic Design Category | Ice Shield Required | Flood Hazards | Winter Design Temp. |
|---------------------------------|-------------|-------------------------|---------------------|---------------------------|---------------------|
| 20 | 90 mph | A | Yes | A. 7/16/79 B. 10/18/83 | 6 deg. F |

| Subject to Damage From | | | | Air Freezing Index | Mean Actual Temp. |
|------------------------|-------------|----------|-------|--------------------|-------------------|
| Weathering | Frost Depth | Termites | Decay | | |
| Severe | 36" | Yes | Yes | 1396 | 50.1 F |

SHEET INDEX

ST -SITE NOTE THAT NOT ALL JOBS REQUIRE ALL SHEETS

| | |
|---------------------------|----------------------|
| FD-# -FOUNDATION/FOOTINGS | RF-# -ROOF FRAMING |
| FF-# -FLOOR FRAMING | EV-# -ELEVATION |
| FP-# -FLOOR PLAN | SD-# -SECTION/DETAIL |
| CF-# -CEILING FRAMING | PL-# -PLAN |

DRAWINGS PREPARED BY: ARCHADECK FRANCHISING CORPORATION
 CONSTRUCTION & DRAFTING DEPARTMENT
 2924 EMERYWOOD PARKWAY, SUITE 101
 RICHMOND, VA 23294

© 2020 ARCHADECK FRANCHISING CORPORATION
 UNAUTHORIZED DUPLICATION IS A VIOLATION OF ALL APPLICABLE LAWS

CONTACT

FOR ANY QUESTIONS OR CONCERNS PLEASE CONTACT:
 OUTDOOR LIFE, LLC.
 1491 Polaris Parkway, Suite #172, Columbus, OH 43240
 PHONE: (740) 879-3730

ENGINEER OF RECORD (AS APPLICABLE)

EXISTING RESIDENCE

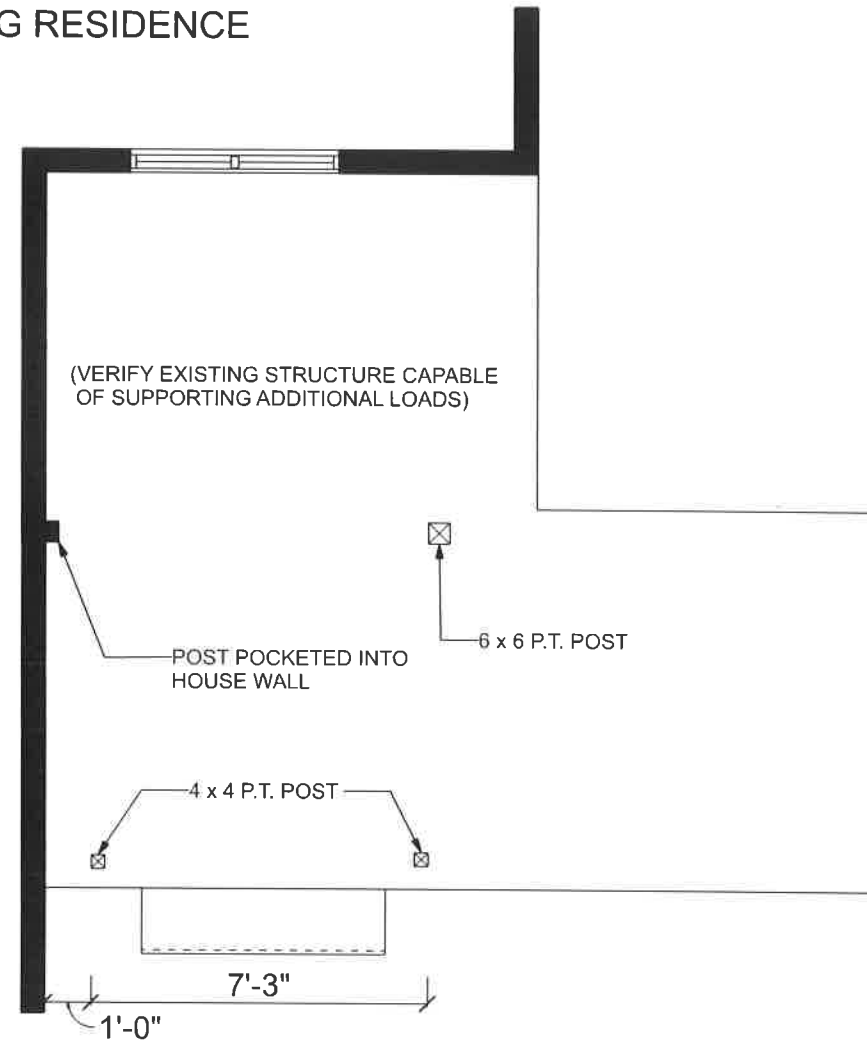

GENERAL DECK NOTES

4 x 6 P.T. COLUMN (TYPICAL), TREATED FOR GROUND CONTACT #207

archadeck®
outdoor living
of
West Columbus

SHEET DESCRIPTION

SHEET:

2/4

FD-1

SCALE: 1/4" = 1'-0"

Prepared by:
Archadeck Franchising Corporation
2924 Emerywood Parkway
Suite 101
Richmond, VA 23294

Construction & Drafting Department
©2020 Archadeck Franchising Corporation
All rights reserved. Unauthorized
duplication is a violation of
all applicable laws.

#56-ABRAMS-101426
929 VERNON ROAD
BEXLEY, OH 43209
DRAWN BY: DMB EXT: 234
JANUARY 6, 2021

EXISTING RESIDENCE

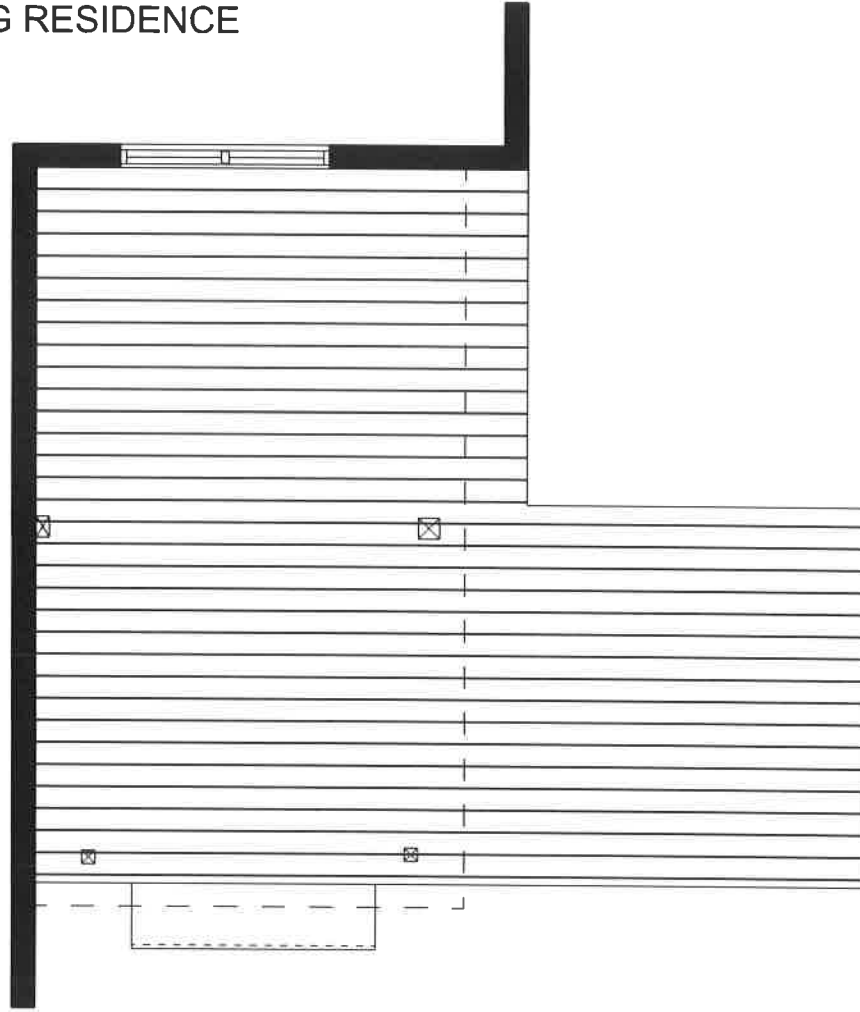

archadeck[®]

outdoor living

of
West Columbus

SHEET DESCRIPTION

SHEET:

3/4

FP-1

SCALE: 1/4" = 1'-0"

Prepared by:
Archadeck Franchising Corporation
2924 Emerywood Parkway
Suite 101
Richmond, VA 23294

Construction & Drafting Department
©2020 Archadeck Franchising Corporation
All rights reserved. Unauthorized
duplication is a violation of
all applicable laws.

#56-ABRAMS-101426
929 VERNON ROAD
BEXLEY, OH 43209
DRAWN BY: DMB EXT: 234
JANUARY 6, 2021

SHEET DESCRIPTION

SHEET:
4/4
 RF-1
 SCALE: 1/4" = 1'-0"

Prepared by:
 Archadeck Franchising Corporation
 2924 Emerywood Parkway
 Suite 101
 Richmond, VA 23294
 Construction & Drafting Department
 ©2020 Archadeck Franchising Corporation
 All rights reserved. Unauthorized
 duplication is a violation of
 all applicable laws.

#56-ABRAMS-101426
 929 VERNON ROAD
 BEXLEY, OH 43209
 DRAWN BY: DMB EXT: 234
 JANUARY 6, 2021

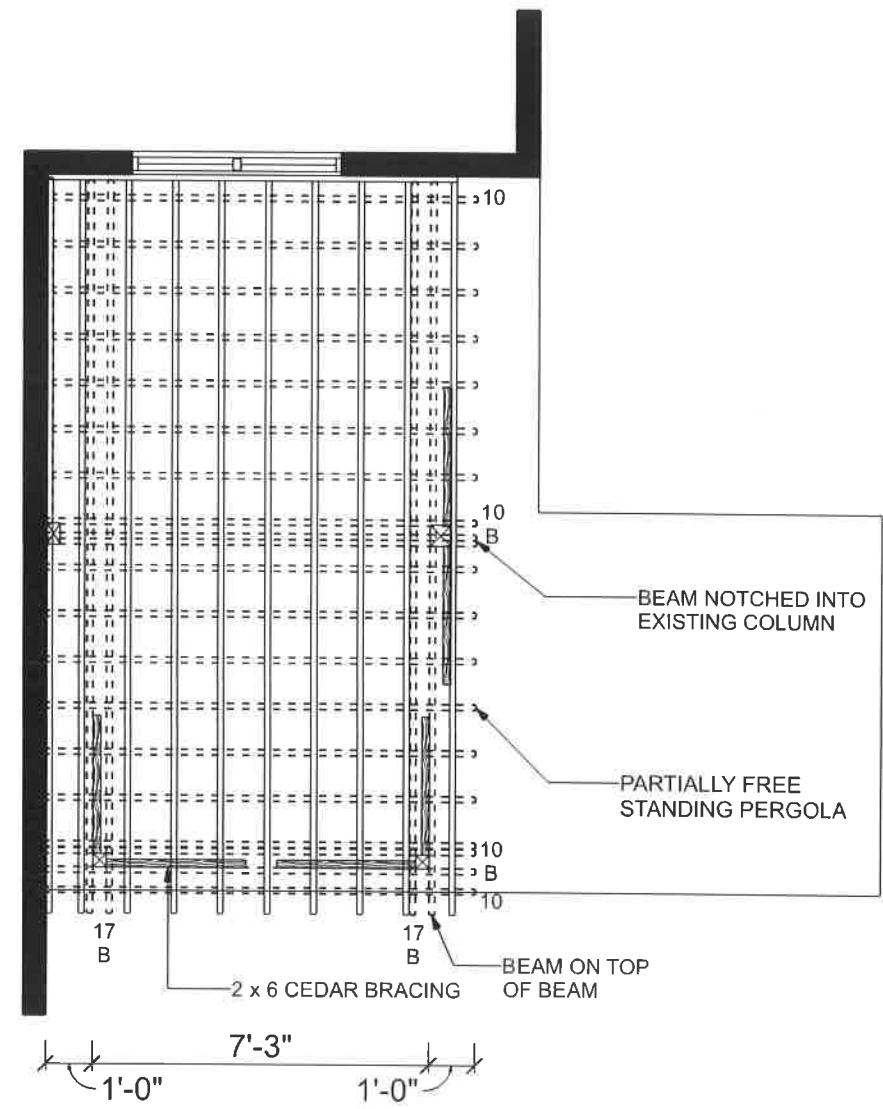

14'-10 1/2"
 1'-0"

| GENERAL PERGOLA NOTES |
|--|
| 9'-0" h. CEDAR ATTACHED PERGOLA #1000-A |
| (2) 2 x 10 CEDAR BEAM |
| 2 x 8 JOISTS @ 12" O.C. (TYP) |
| 2 x 4 LATHING @ 12" O.C. |
| 2 x 6 CEDAR BRACING (TYPICAL), SEE PLAN FOR LOCATION(S) |
| 2 x 10 P.T. HOUSE BAND w/ JOIST HANGERS & LEDGERLOKS STAGGERED @ 8" O.C. (PER MANUFACTURER'S SPECIFICATIONS) PER DETAIL #V-202-B |

4 x 6 COLUMN NOTCH

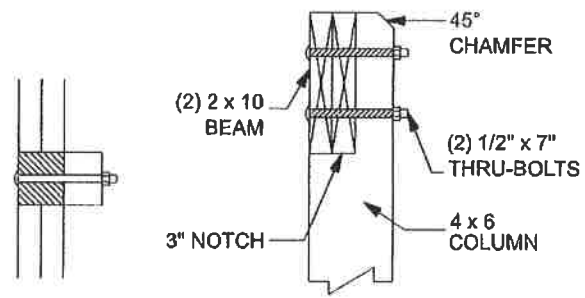

6 x 6 COLUMN NOTCH

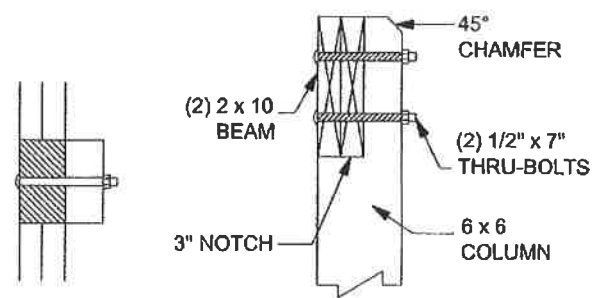

archadeck[®]

© 2016 Archadeck Franchising Corporation

DETAIL #207-B COLUMN TO BEAM CONNECTION,
4 x 6 & 6 x 6

SCALE: 1" = 1'

REVISION DATE: 01/15/2018

These drawings are intended only as a guide for the construction of certain generic elements in building codes and regulations, and specific site conditions. These drawings may need to be modified by the builder to comply with such local codes, regulations, and site conditions. Due to the generic nature of these drawings certain items may not be intended for use on a specific project.

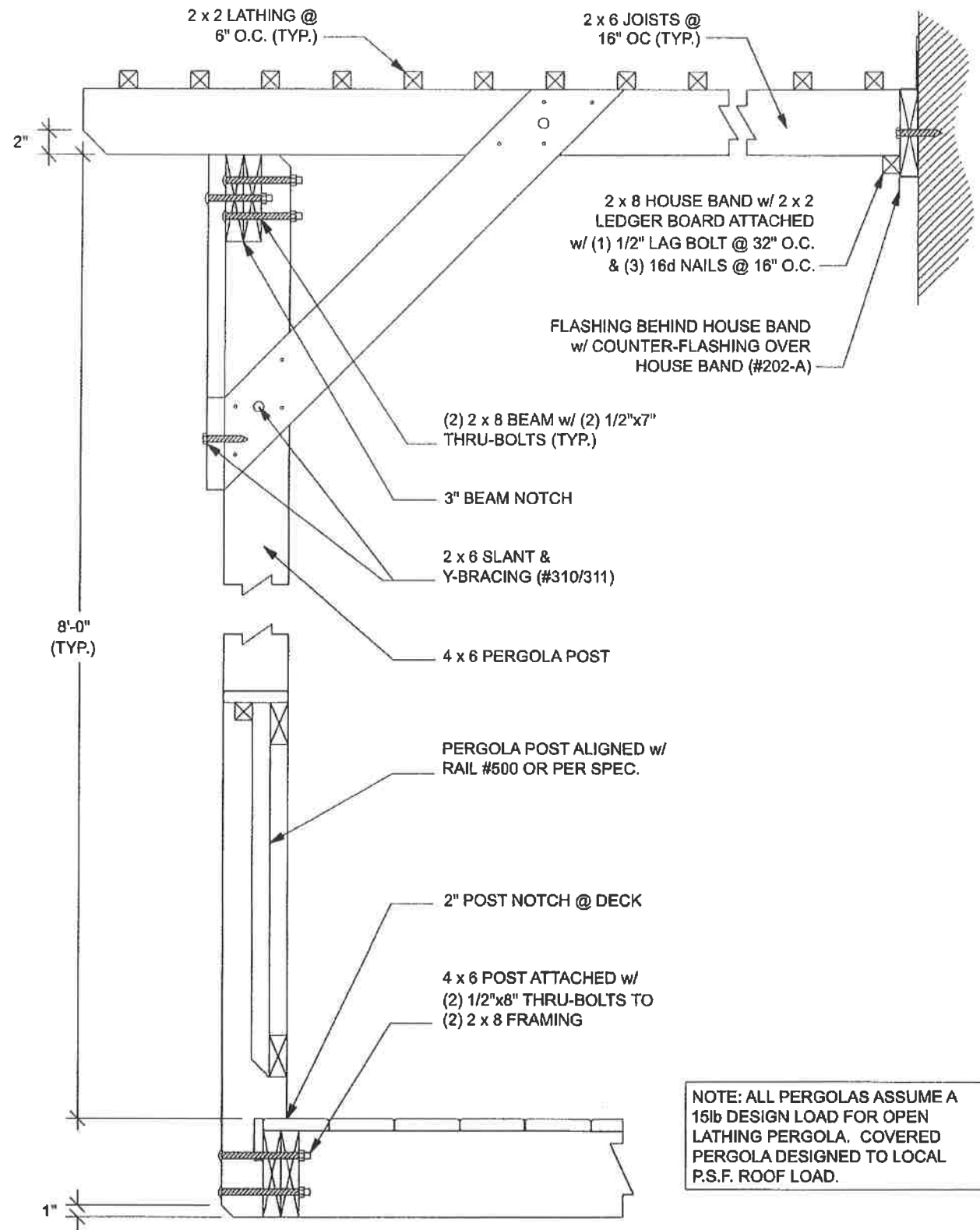

NOTE: ALL PERGOLAS ASSUME A 15lb DESIGN LOAD FOR OPEN LATHING PERGOLA. COVERED PERGOLA DESIGNED TO LOCAL P.S.F. ROOF LOAD.

archadeck®

DETAIL #1000-A TYPICAL ATTACHED PERGOLA

©2016 Archadeck Franchising Corporation

SCALE: 1" = 1'

REVISION DATE: 01/15/2018

These drawings are intended only as a guide for the construction of certain generic elements in building codes and regulations, and specific site conditions. These drawings may need to be modified by the builder to comply with such local codes, regulations, and site conditions. Due to the generic nature of these drawings certain items may not be intended for use on a specific project.

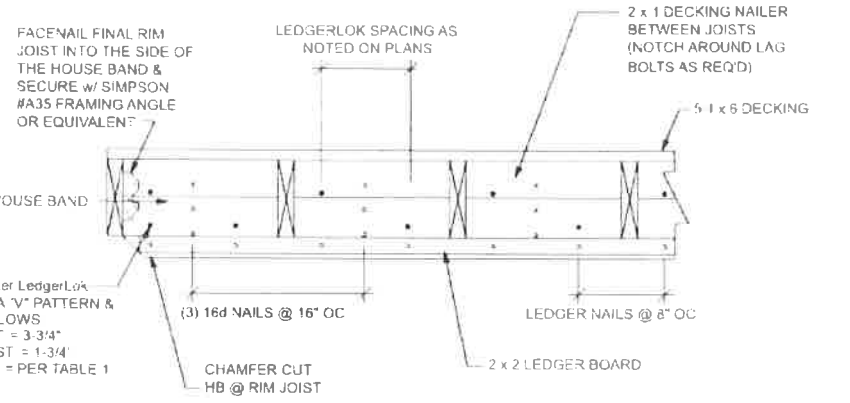
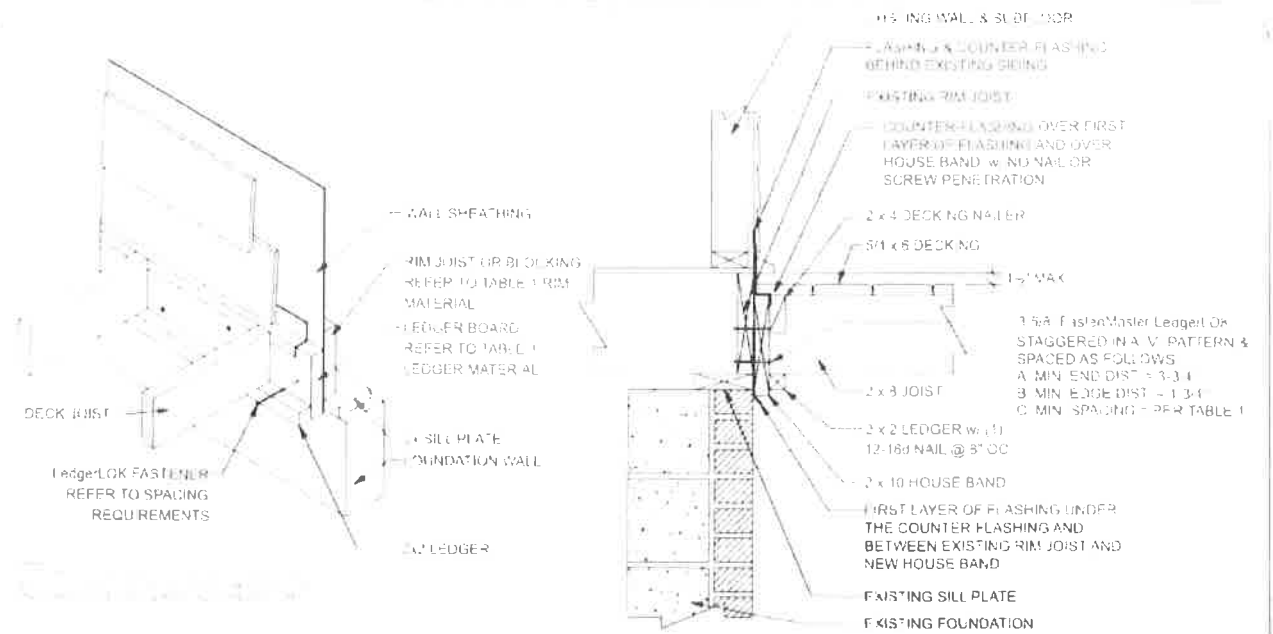

TABLE 1 FASTENING PATTERN FOR ATTACHMENT OF LEDGER TO RIM BOARD USING LedgerLok

| LIVE LOAD | LEDGER MATERIAL | RIM MATERIAL | SPACING BETWEEN FASTENERS (IN INCHES) BASED ON JOIST SPANS OF: | | | | | | |
|-----------|--------------------|--------------|--|----------|-----------|-----------|-----------|-----------|-----------|
| | | | 6' OR LESS | UP TO 8' | UP TO 10' | UP TO 12' | UP TO 14' | UP TO 16' | UP TO 18' |
| 40 PSF | DOUG FIR OR S PINE | 2x LUMBER | 24 | 18 | 14 | 12 | 10 | 9 | 8 |
| | | EW RIM | 25 | 19 | 15 | 12 | 10 | 9 | 8 |
| | HEM FIR | 2x LUMBER | 20 | 15 | 12 | 10 | 8 | 7 | 6 |
| | | EW RIM | 25 | 19 | 15 | 12 | 10 | 9 | 8 |
| 60 PSF | DOUG FIR OR S PINE | 2x LUMBER | 17 | 13 | 10 | 8 | 7 | 6 | 5 |
| | | EW RIM | 18 | 13 | 10 | 9 | 7 | 6 | 5 |
| | HEM FIR | 2x LUMBER | 14 | 11 | 8 | 7 | 6 | 5 | 4 |
| | | EW RIM | 18 | 13 | 10 | 9 | 7 | 6 | 6 |

NOTE: WHEN INSTALLED AS INSTRUCTED, THE LedgerLok CAN BE USED TO REPLACE THE 1/2" LAG SCREWS CALLED FOR IN TABLE 502.2.2.1 OF THE 2009 INTERNATIONAL RESIDENTIAL CODE (IRC) OR TABLE 507.2 OF THE 2012 IRC.

NOTE: DETAIL IS BASED ON TYPICAL ARCHADECK DESIGN LOADS, AND STANDARD APPLICATIONS. ADDITIONAL REINFORCEMENT AND STRUCTURE MAY BE REQUIRED FOR NON-STANDARD LOAD OR SITE CONDITIONS.



archadeck
© 2018 Archadeck Franchising Corporation

DETAIL #V-202-A HOUSE BAND W/ 2 x 2 LEDGER
w/ FASTENMASTER CONNECTORS

SCALE: 3/4" = 1'

REVISION DATE: 02/05/2018

These drawings are for informational purposes only and are not to be used for construction. They are subject to change without notice. These drawings are intended to be used in conjunction with the manufacturer's instructions and applicable building codes and regulations. All specifications are subject to change without notice. These drawings are intended to be used in conjunction with the manufacturer's instructions and applicable building codes and regulations. All specifications are subject to change without notice.