

ADDITION & RENOVATION FOR: THE EISLEY RESIDENCE

833 VERNON ROAD
BEXLEY, OHIO 43209

ALLEY
(16' R.O.W.)

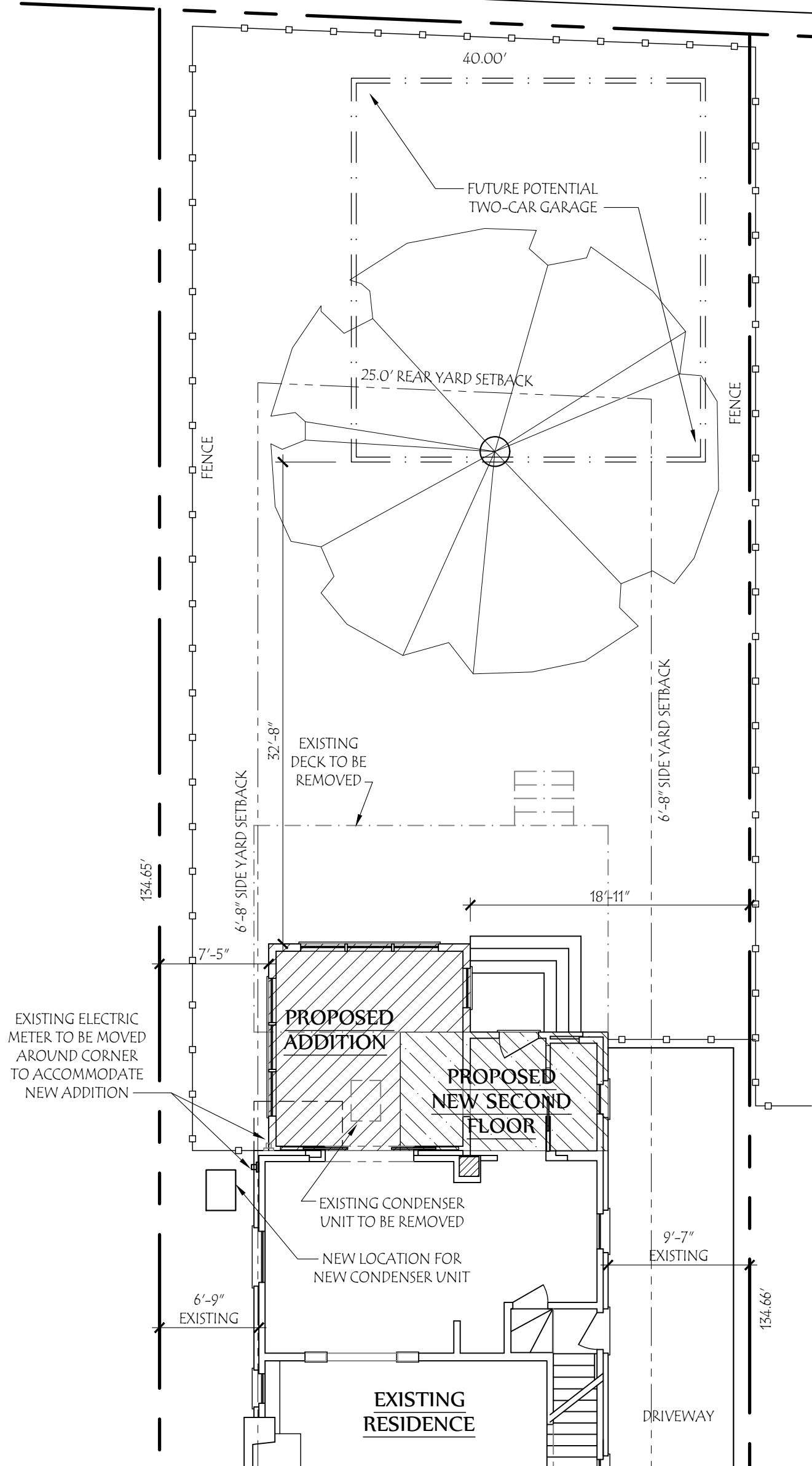

DEVELOPMENT INFORMATION	
ZONING DESIGNATION	= R-6
TOTAL LAND AREA	= 5386SF
MAXIMUM BUILDING COVER	35% = 1885 SF
PROPOSED LOT COVER:	
EXISTING HOUSE + PORCH	= 950 SF
PROPOSED ADDITION	= 153 SF
POSSIBLE FUTURE GARAGE	= 624 SF
TOTAL BUILDING COVER	32% = 1727 SF
MAXIMUM DEVELOP. COVER	60% = 3231 SF
PROPOSED DEVELOP. COVER:	
BUILDING COVER	= 1727 SF
SIDEWALKS	= 67 SF
DRIVEWAY	= 570 SF
NEW PATIO	= 382 SF
TOTAL	50% = 2746 SF



Lauerhass Architecture
 RENOVATION - ADDITION - NEW HOME
 753 Francis Ave. Bexley, OH 43209 614-371-3523