

SOUTH CASSINGHAM ROAD

GRASS

PUBLIC SIDEWALK

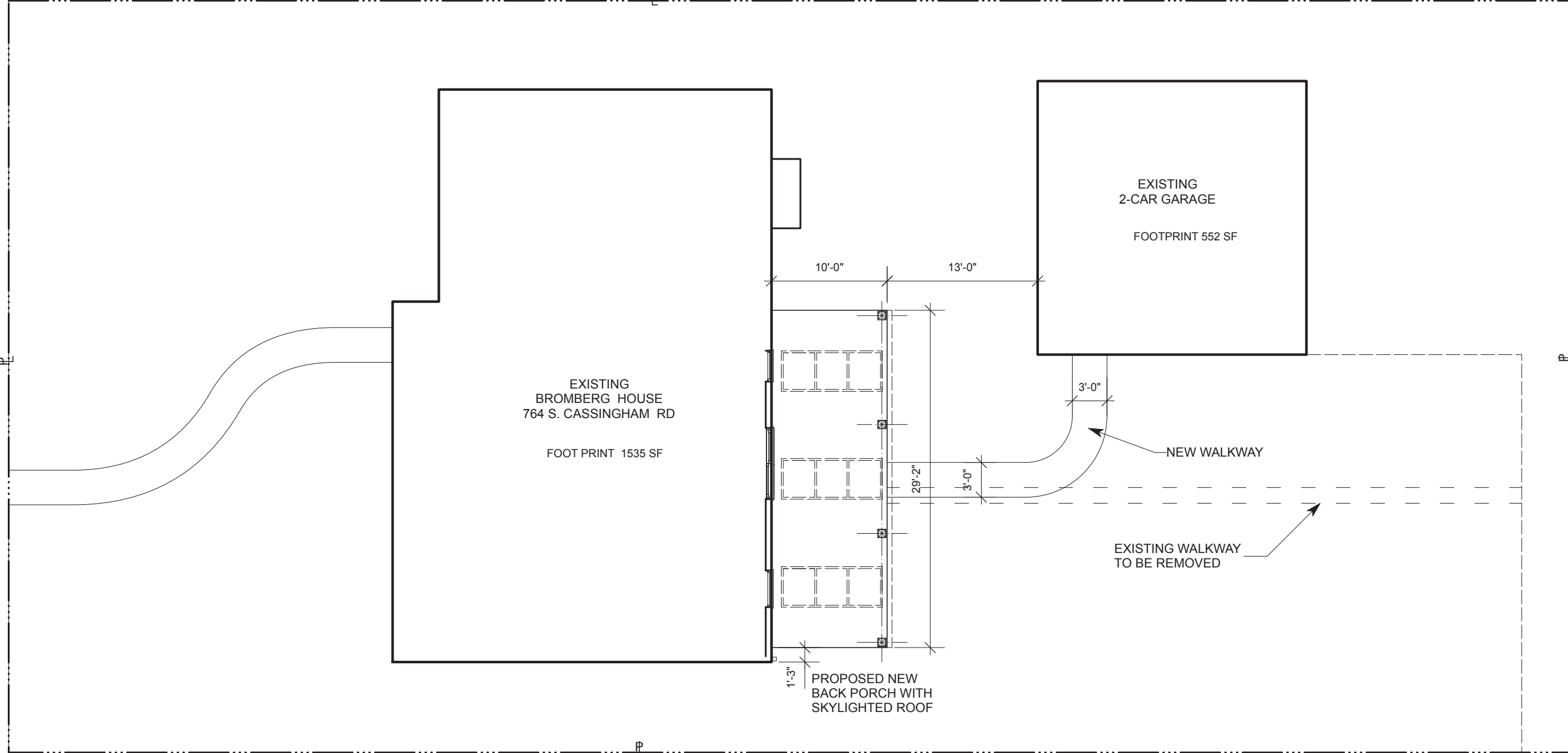

EXISTING  
BROMBERG HOUSE  
764 S. CASSINGHAM RD  
FOOT PRINT 1535 SF

EXISTING  
2-CAR GARAGE  
FOOTPRINT 552 SF

1'-3"  
PROPOSED NEW  
BACK PORCH WITH  
SKYLIGHTED ROOF

NEW WALKWAY

EXISTING WALKWAY  
TO BE REMOVED

SERVICE ALLEY

PROPOSED SITE PLAN

Sep 15, 2020



1"=10'