

FRONT PORCH ADDITION FOR:
Molly & Keith Kim
 2815 DALE AVENUE
 BEXLEY, OHIO 43209

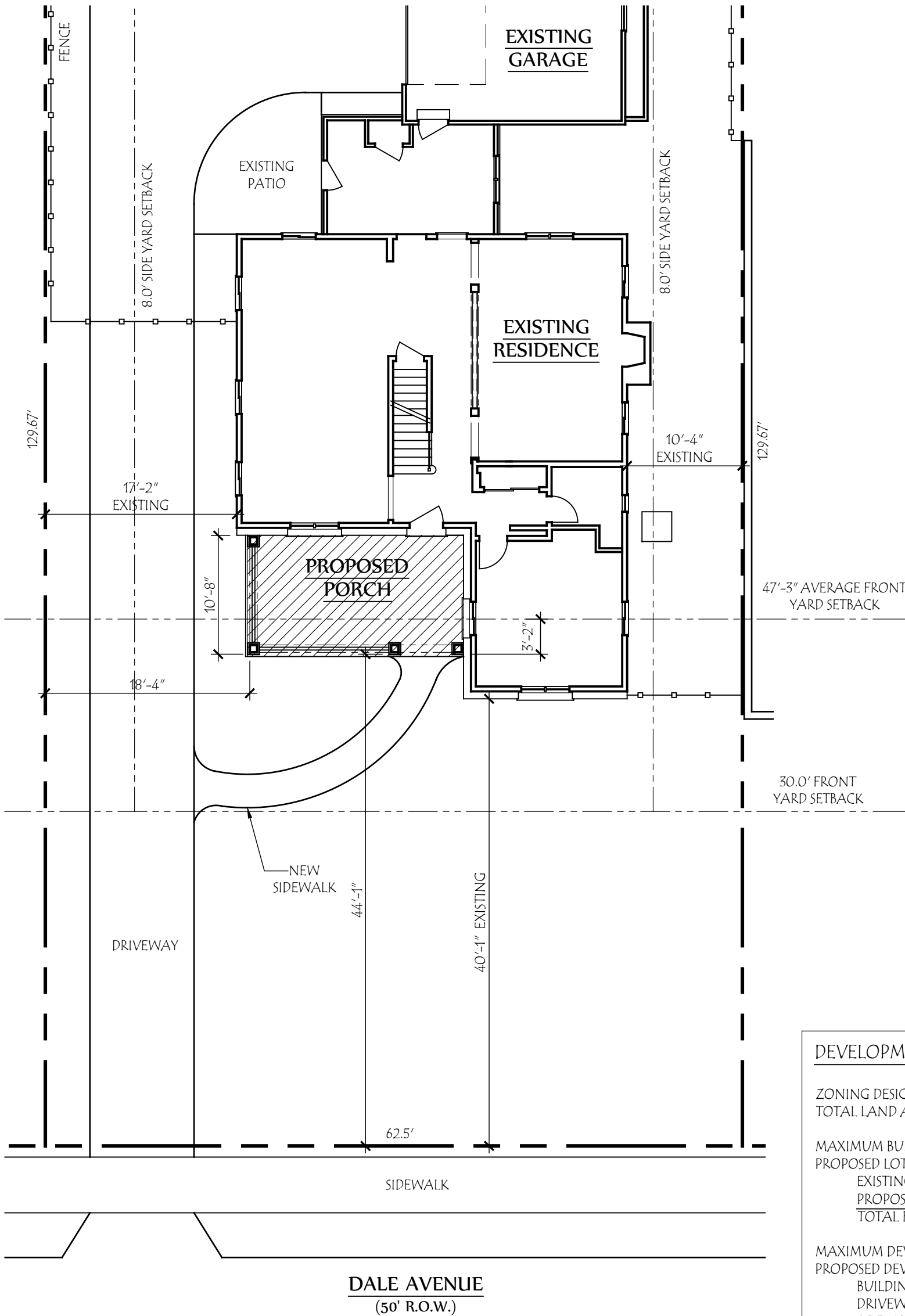

DEVELOPMENT INFORMATION

ZONING DESIGNATION	= R-6
TOTAL LAND AREA	= 8,104 SF
MAXIMUM BUILDING COVER	35 % = 2836 SF
PROPOSED LOT COVER:	
EXISTING HOUSE + GARAGE	= 1769 SF
PROPOSED PORCH	= 210 SF
TOTAL BUILDING COVER	24.4 % = 1979 SF
MAXIMUM DEVELOP. COVER	60 % = 4862 SF
PROPOSED DEVELOP. COVER:	
BUILDING COVER	= 1979 SF
DRIVEWAY	= 1573 SF
SIDEWALK	= 81 SF
PATIO	= 121 SF
TOTAL	46.3 % = 3754 SF

AVERAGE EXISTING SETBACKS
 (BETWEEN GOULD RD. & MERKLE AVE.)

2831 DALE AVENUE	= 56'-0"
2825 DALE AVENUE	= 55'-8"
2815 DALE AVENUE	= 40'-1"
328 SOUTH MERKLE	= 37'-2"
AVERAGE EXISTING FRONT YARD SETBACK	= 47'-3"



Site Plan

SCALE: 1" = 10'-0"



Lauerhass Architecture

RENOVATION - ADDITION - NEW HOME

753 Francis Ave. Bexley, OH 43209 614-371-3523