

# ADDITION & RENOVATION FOR: THE REISER RESIDENCE

725 S. CASSINGHAM RD.  
BEXLEY, OHIO 43209

DEVELOPMENT INFORMATION	
ZONING DESIGNATION	= R-6
TOTAL LAND AREA	= 5400 SF
MAXIMUM BUILDING COVER	35 % = 1890 SF
PROPOSED LOT COVER:	
EXISTING HOUSE + PORCH	= 1046 SF
EXISTING GARAGE	= 400 SF
PROPOSED ADDITION	= 200 SF
TOTAL BUILDING COVER	30 % = 1646 SF
MAXIMUM DEVELOP. COVER	60 % = 3240 SF
PROPOSED DEVELOP. COVER:	
BUILDING COVER	= 1646 SF
SIDEWALKS	= 374 SF
DRIVEWAY	= 133 SF
PROPOSED DECK	= 252 SF
TOTAL	44.5 % = 2405 SF

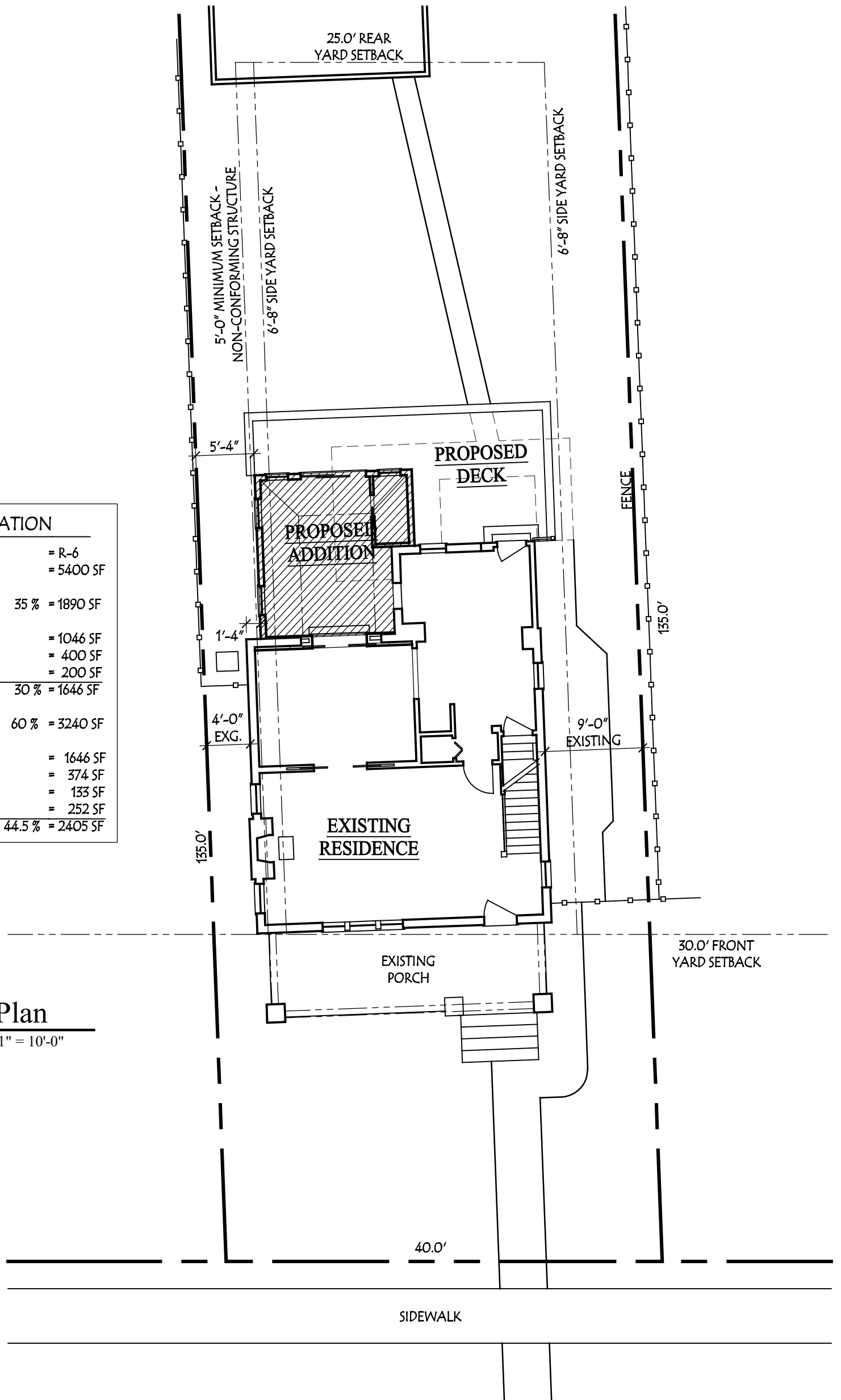

**Lauerhass Architecture**  
RENOVATION - ADDITION - NEW HOME

753 Francis Ave. Bexley, OH 43209 614-371-3523

**SOUTH CASSINGHAM ROAD**  
(50' R.O.W.)