

GENERAL PLANTING NOTES:

1. SURVEY INFORMATION OBTAINED ELECTRONICALLY. KLA STUDIOS CANNOT ATTEST TO THE ACCURACY OR RELIABILITY OF LEGAL BOUNDARIES, EASEMENTS OR FIELD GATHERED DATA.
2. THE LOCATION OF THE EXISTING UNDERGROUND UTILITIES ARE SHOWN IN AN APPROXIMATE WAY ONLY AND HAVE NOT BEEN INDEPENDENTLY VERIFIED BY THE OWNER OR ITS REPRESENTATIVE. THE CONTRACTOR SHALL DETERMINE THE EXACT LOCATION OF ALL EXISTING UTILITIES PRIOR TO COMMENCING WORK AND AGREES TO BE FULLY RESPONSIBLE FOR ANY AND ALL DAMAGES WHICH MIGHT BE OCCASIONED BY THE CONTRACTOR'S FAILURE TO EXACTLY LOCATE AND PRESERVE ANY AND ALL UNDERGROUND UTILITIES.
3. ALL DIMENSIONS ARE TAKEN TO FACE OF CURB OR BUILDING WHERE APPLICABLE UNLESS OTHERWISE NOTED. USE DIMENSIONAL INFORMATION GIVEN. DO NOT SCALE DRAWINGS.
4. CONTRACTOR SHALL REFER QUESTIONS ON MATERIALS, FINISHES, LABOR, AND/OR PERFORMANCE STANDARDS NOT SPECIFIED HEREIN TO THE LANDSCAPE ARCHITECT.
5. ALL CHANGES TO DESIGN OR PLANT SUBSTITUTIONS ARE TO BE AUTHORIZED BY THE LANDSCAPE ARCHITECT.
6. CONSULT PLANT SCHEDULE FOR PLANT SIZES AND SPECIFICATIONS. CONTRACTOR IS RESPONSIBLE FOR ALL PLANTS DRAWN ON PLANS. PLANT LIST QUANTITIES ARE FOR CONVENIENCE ONLY.
7. ALL PLANTS TO CONFORM TO THE AMERICAN STANDARD FOR NURSERY STOCK (ANSI-Z60.1-2014) IN REGARDS TO SIZING, GROWING AND B&B SPECIFICATIONS.
8. ALL PROPOSED PLANTING BEDS TO BE TILLED TO A MINIMUM DEPTH OF 12".
9. ALL PLANTING BEDS TO BE FERTILIZED WITH 10-10-10 OR APPROVED EQUAL.
10. PLANTING HOLES TO BE DUG A MINIMUM OF TWICE THE WIDTH AND 6-8 INCHES DEEPER THAN THE SIZE OF THE ROOT BALL OF BOTH SHRUB AND TREE AND TO BE AMENDED WITH ORGANIC SOIL CONDITIONER.
11. IN AREAS WHERE BEDROCK OR HEAVILY COMPACTED ROCK FILL IS ENCOUNTERED, THE PLANTING HOLES ARE TO BE DUG TO A MINIMUM OF THREE TIMES THE WIDTH AND ONE FOOT DEEPER THAN THE SIZE OF THE ROOT BALL. NOTIFY LANDSCAPE ARCHITECT IF FIELD CONDITIONS WARRANT ADJUSTMENT OF PLANT LOCATIONS.
12. CONTRACTOR TO PROVIDE A FULL 1 YEAR GUARANTEE ON ALL PLANTS INSTALLED AND PROVIDE COMPLETE MAINTENANCE ON ALL WORK DONE BEGINNING ON THE DAY OF APPROVAL FROM OWNER'S REPRESENTATIVE AND CONTINUING FOR A THREE MONTH DURATION AT WHICH TIME OWNER'S REPRESENTATIVE WILL DECLARE JOB ACCEPTANCE
13. ALL EXISTING PLANT MATERIAL SHOWN ON THIS PLAN IS TO BE PRESERVED UNLESS SPECIFICALLY NOTED OTHERWISE.
14. ALL SHRUBS AND GROUND COVER BEDS (EXISTING AND NEW), PLANTING BEDS, AND SHRUB MASSES SHALL HAVE A MINIMUM 3" DEEP SHREDDED HARDWOOD BARK MULCH. MULCH HEDGES IN A CONTINUOUS BED.
15. ALL AREAS DISTURBED BY CONSTRUCTION ARE TO BE RESTORED, FINE GRADED AND SEEDED. (SEE LANDSCAPE PLANS) . SEEDING OR SODDING BY LANDSCAPE CONTRACTOR.

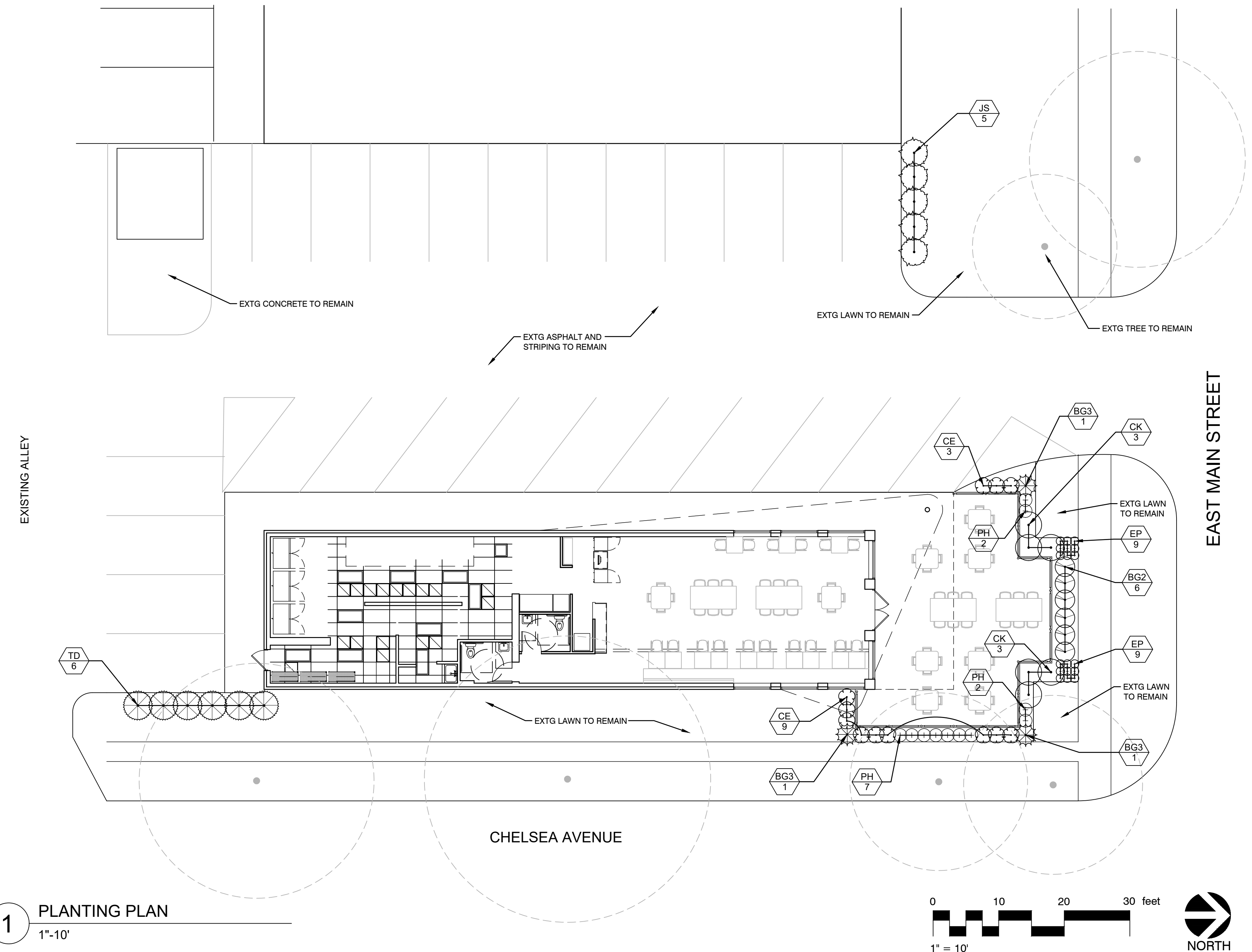

1 PLANTING PLAN
1"=10'

PLANT SCHEDULE

CODE	BOTANICAL NAME	COMMON NAME	SIZE	CONTAINER	QTY	REMARKS
SHRUBS						
BG2	Buxus x 'Green Gem'	Green Gem Boxwood	3 gal	Cont.	6	
BG3	Buxus x 'Green Mountain'	Pyramidal Boxwood	4' Ht.	B&B	3	
CK	Calamagrostis x acutiflora 'Karl Foerster'	Feather Reed Grass	3 gal	Cont.	6	
CE	Chamaecyparis pisifera 'Lime Pie'	'Lime Pie' Sawara Cypress	3 gal	Cont.	12	
EP	Echinacea purpurea	Purple Coneflower	4"pot		18	
JS	Juniperus chinensis 'Sea Green'	Sea Green Juniper	24" HT MIN		5	USED FOR SCREENING
PH	Pennisetum alopecuroides 'Hamein'	Hamein Dwarf Fountain Grass	1 gal	Cont.	11	
TD	Taxus x media 'Densiformis'	Dense Yew	24" HT MIN		6	USED FOR SCREENING

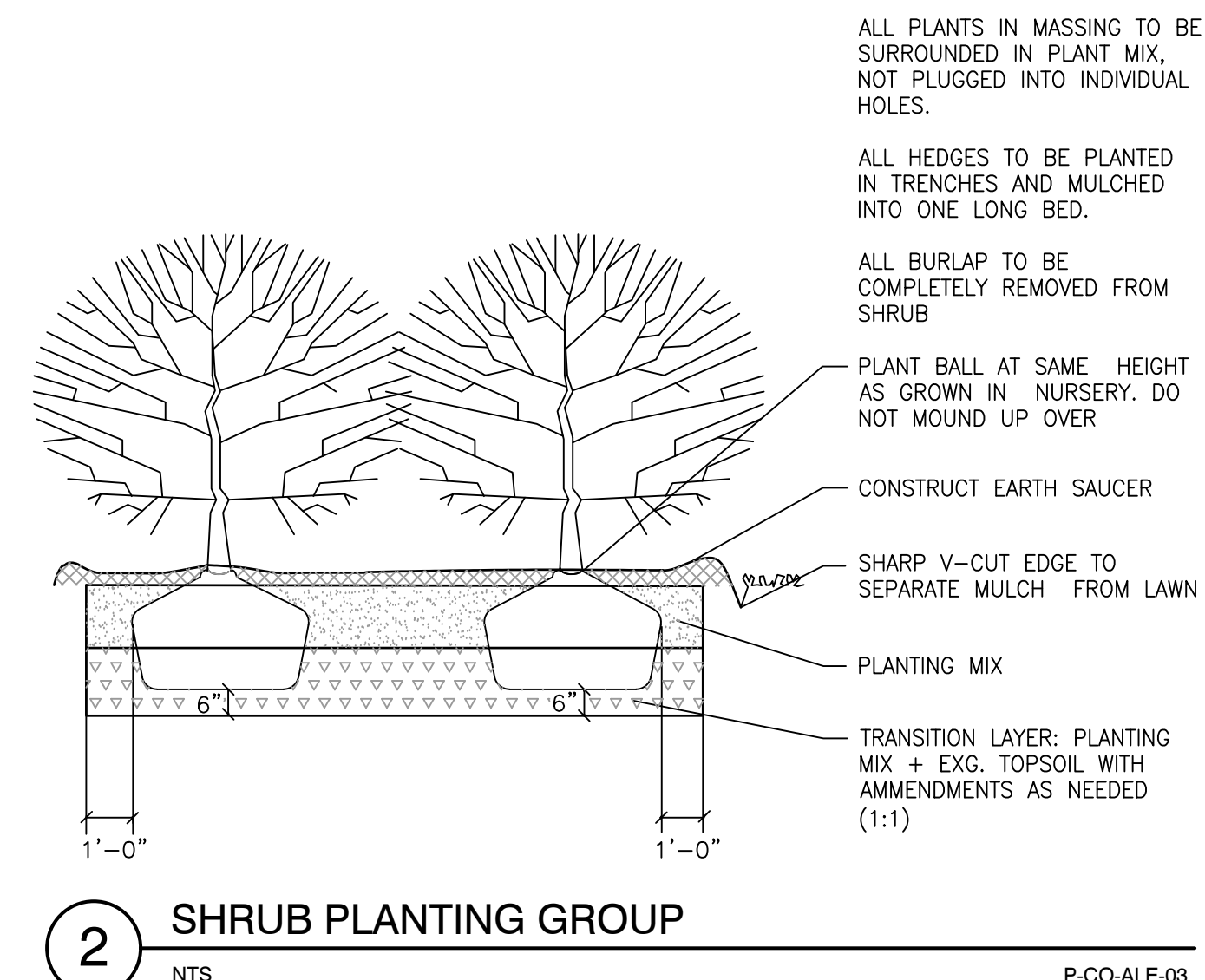

2 SHRUB PLANTING GROUP
NTS

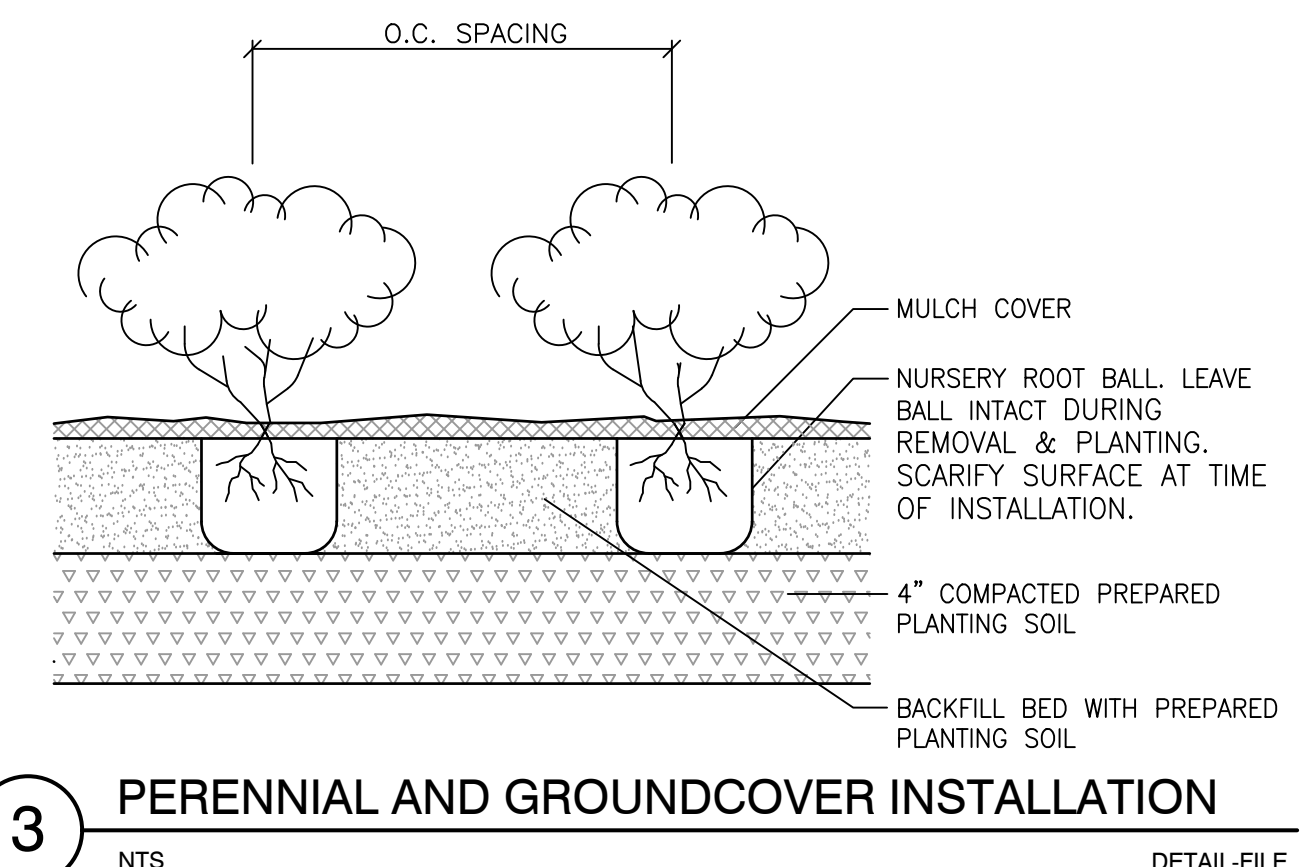

3 PERENNIAL AND GROUNDCOVER INSTALLATION
NTS

SHEET INFORMATION

DRAWN BY
BAK

REVISIONS

SHEET TITLE
Landscape Plan

SCALE
AS NOTED

SHEET NO.