

$12.2 \times 3.8 = 46.3$
 $23.8 \times 24.5 = 583$
 1396 HOUSE 6029.3
 $\frac{378}{1774} \rightarrow$ DECK \rightarrow 308
 \rightarrow 346 = 620. Allowed

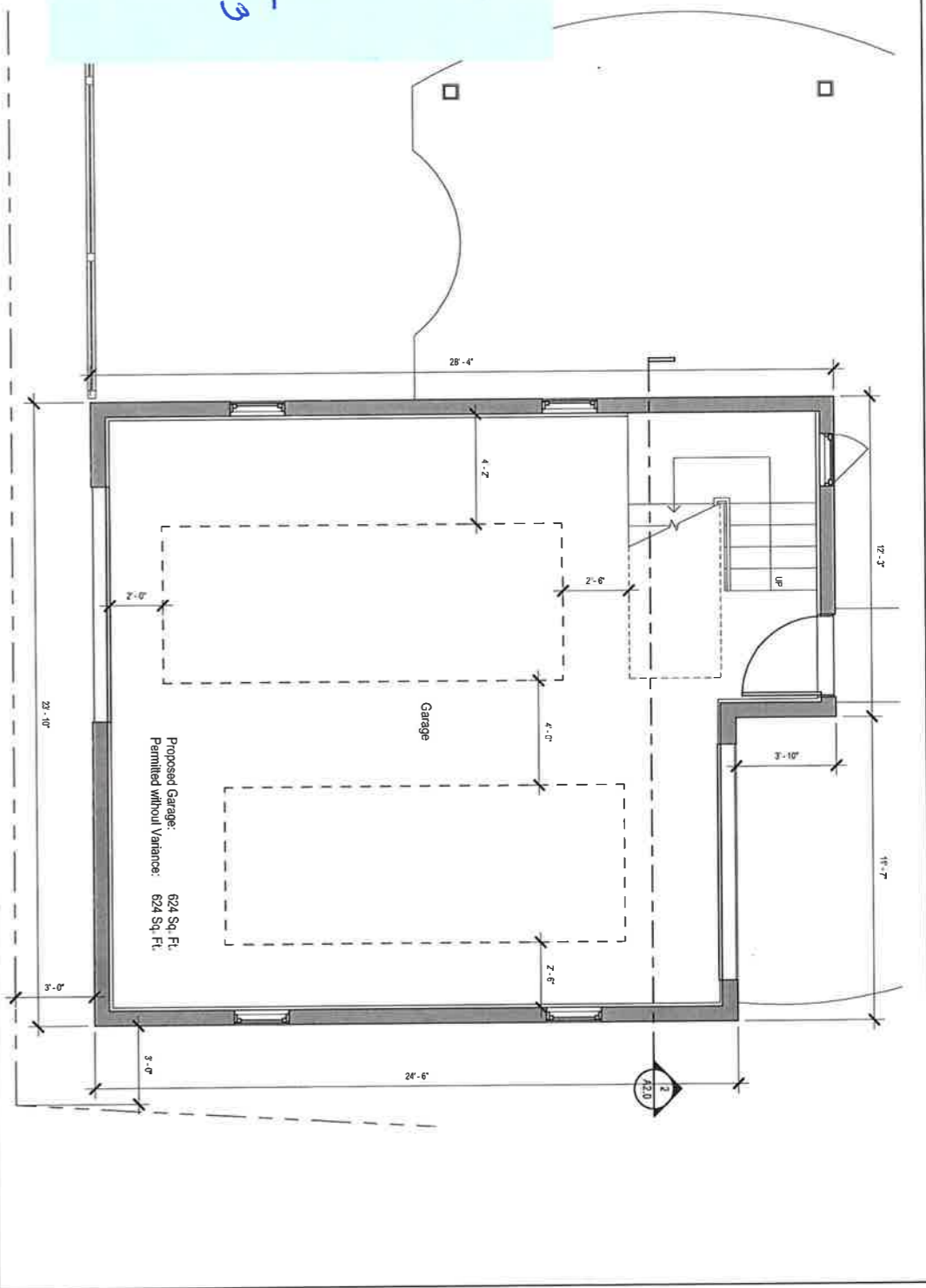

1 Proposed First Floor Plan
 1/4" = 1'-0"

See Foreground Site Plans and other Foreground documents for all Site Information.

The Rankin Residence - New Garage 2467 Sherwood Road, Bexley, Ohio 43209	
	246 Sherwood Road Bexley, Ohio 43209 Telephone: 614.461.0244 www.rogerskrainak.com
03.11.21 Final Schematic Design	A1.0 RAK Project #20013

© Copyright 2001-2021 Rogers Krainak Architects, Incorporated. The Drawing (Document) and the related depicting items contain the original and unpublished work of Rogers Krainak Architects, Inc. and may not be used on any project for any purpose, nor may the same be copied (except by those governmental agencies required by law), or displayed without written consent of Rogers Krainak Architects, Inc.