

Planimetric Legend

Source: 2021 Aerial Photography

- Edge of Pavement
- Roadway Centerlines
- Railroad Centerlines
- Building Footprints
- Building Under Construction
- Creeks, Streams, Ditches
- Rivers & Ponds

Topographic Legend

Source: OSIP - 2019 LiDAR Collection

- Spot Elevation
- Index Contour
- Intermediate Contour

Appraisal Legend

Source: Franklin County Auditor & Engineer

- Parcel IDs
- Parcel Dimensions
- Lot Numbers
- Site Address
- Parcel Boundary
- Subdivision Boundary
- Condominium Boundary
- County Boundary
- City or Village Boundary
- Tax District Boundary
- School District Boundary
- Zip Code Boundary

This map is prepared for the real property inventory within the county. It is compiled from record deeds, survey plats, and other public records and data. Users of this map are notified that the public primary information sources should be considered for verification of the information contained on this map. The county and the mapping companies assume no legal responsibility for the information contained on this map. Please notify the Franklin County Auditor's GIS Department of any discrepancies.

The data on this map was originally compiled at 1"=100' based on the Ohio State Plane South Coordinate System, North American Datum 1983 with 2' contours based on the North American Vertical Datum 1988 (when displayed).



**Franklin County
Auditor's Office
Auditor**

Michael Stinziano
Map Produced June 9, 2025



NATE GREEN AND HEATHER CUNNINGHAM
377 S. ROOSEVELT AVE BEXLEY, OH 43209

*PROJECTED CONSTRUCTION START: 9-09-25

OVERALL SCOPE: SUNROOM REMODEL

DRAWING DATE: 06-05-25

GREEN REMODEL

PRE CONSTRUCTION PHOTOS

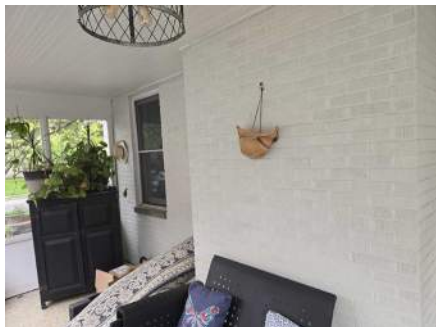

GREEN REMODEL

PRE CONSTRUCTION PHOTOS- INTERIOR SPACES FOR REFERENCE

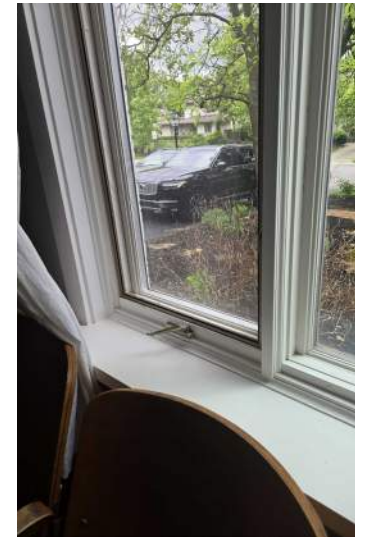

GREEN REMODEL

EXISTING PLAN

*ALL DIMENSIONS TO BE VERIFIED IN FIELD

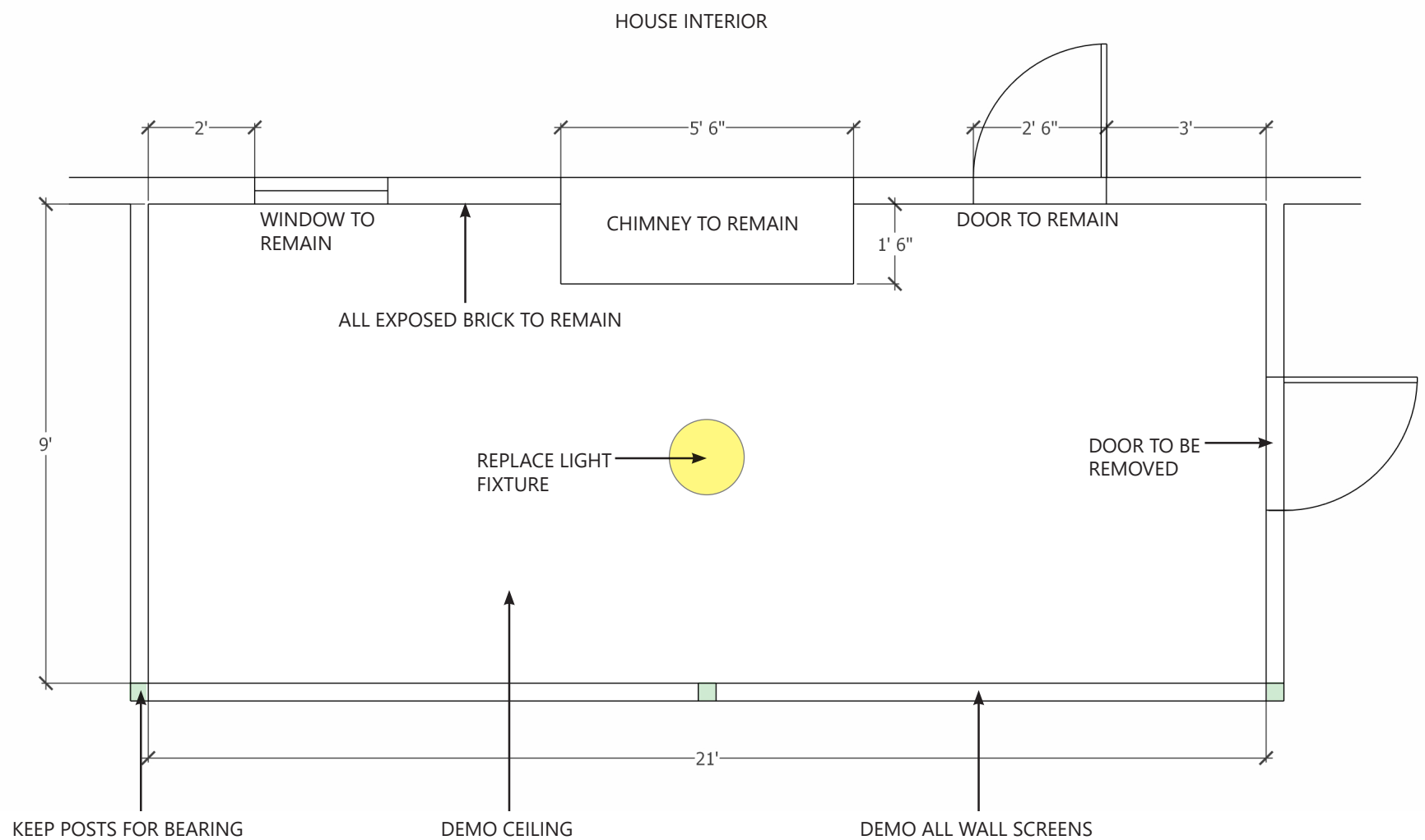

PROPOSED PLAN

-ALL NEW OUTLETS TO BE INSTALLED PER CODE
-SWITCH LOCATIONS TO BE DETERMINED ON SITE BY HOMEOWNER AND ELECTRICIAN

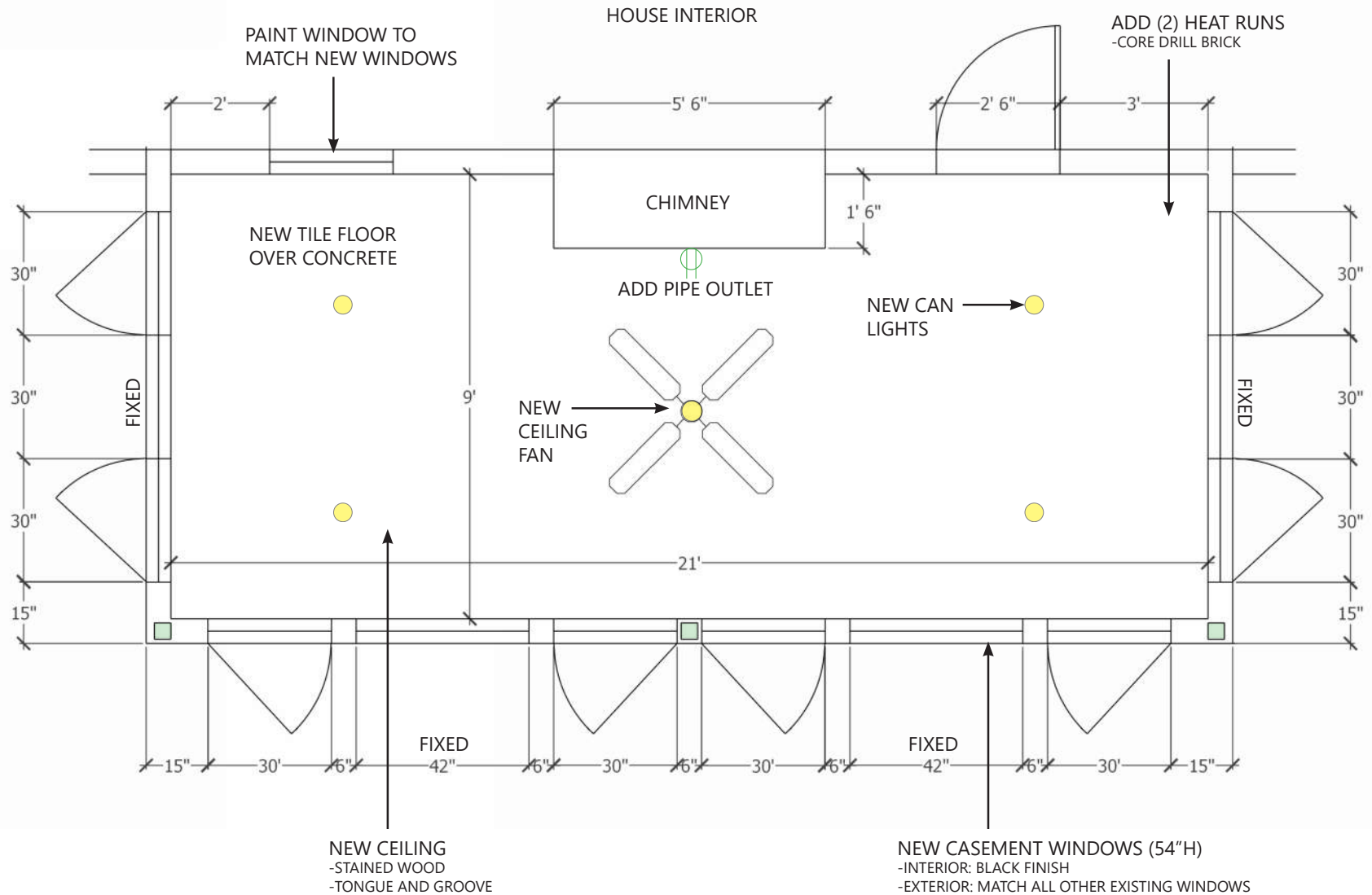

GREEN REMODEL

EXTERIOR- FRONT VIEW

***ALL RENDERINGS ARE CONCEPTUAL**- REQUIREMENTS AND SPECIFICS TO BE DETERMINED IN FIELD. REFER TO CABINET DRAWINGS FOR FINAL LAYOUT AND DIMENSIONS

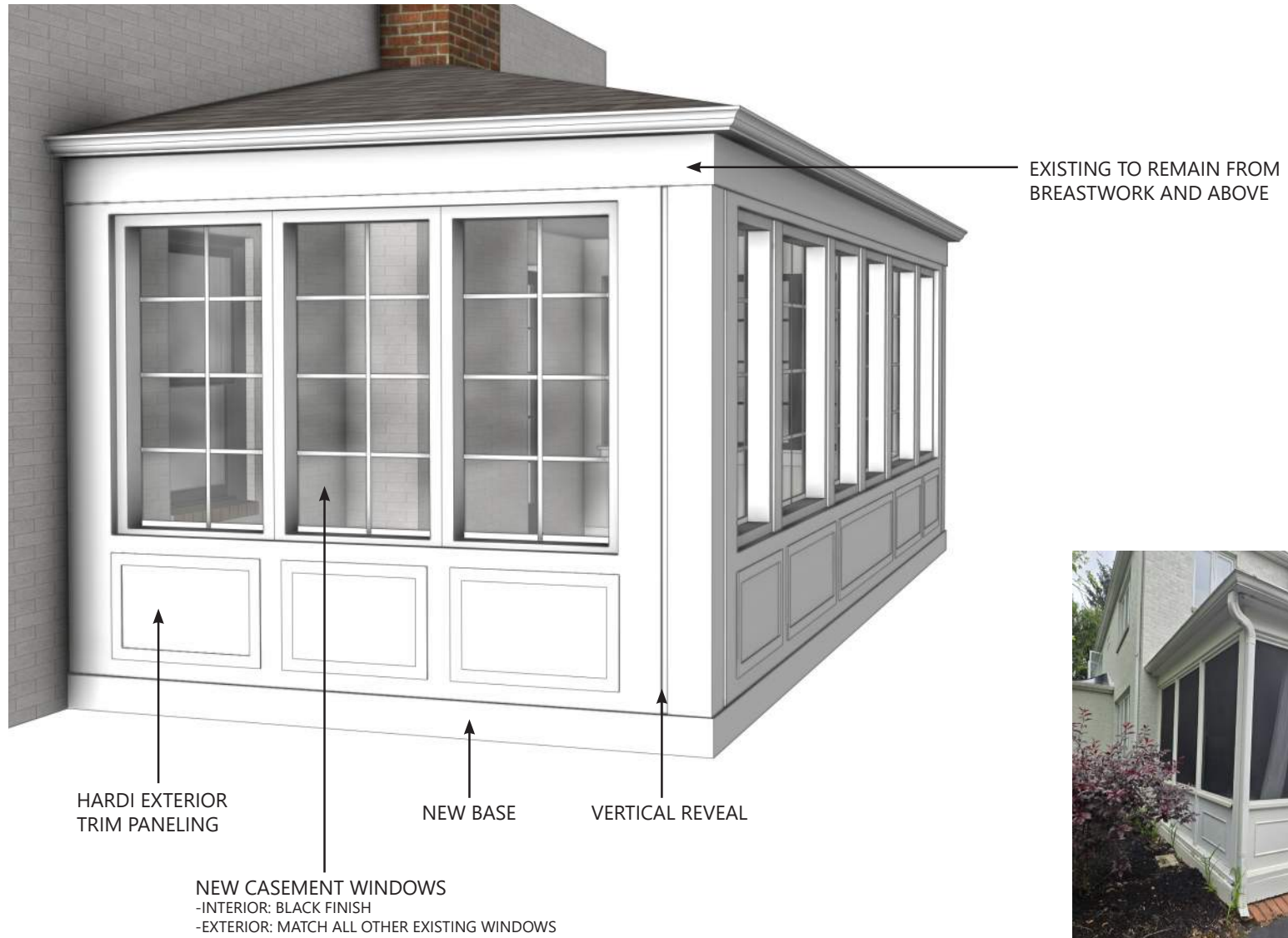

EXISTING FOR REFERENCE

GREEN REMODEL

EXTERIOR- SIDE VIEW



↑
VERTICAL REVEAL

↑
HARDI EXTERIOR
TRIM PANELING



EXISTING FOR REFERENCE

GREEN REMODEL

EXTERIOR- BACK VIEW



EXISTING DOOR TO BE
REMOVED AND REPLACE
WITH WINDOW



EXISTING FOR REFERENCE

GREEN REMODEL

INTERIOR VIEW

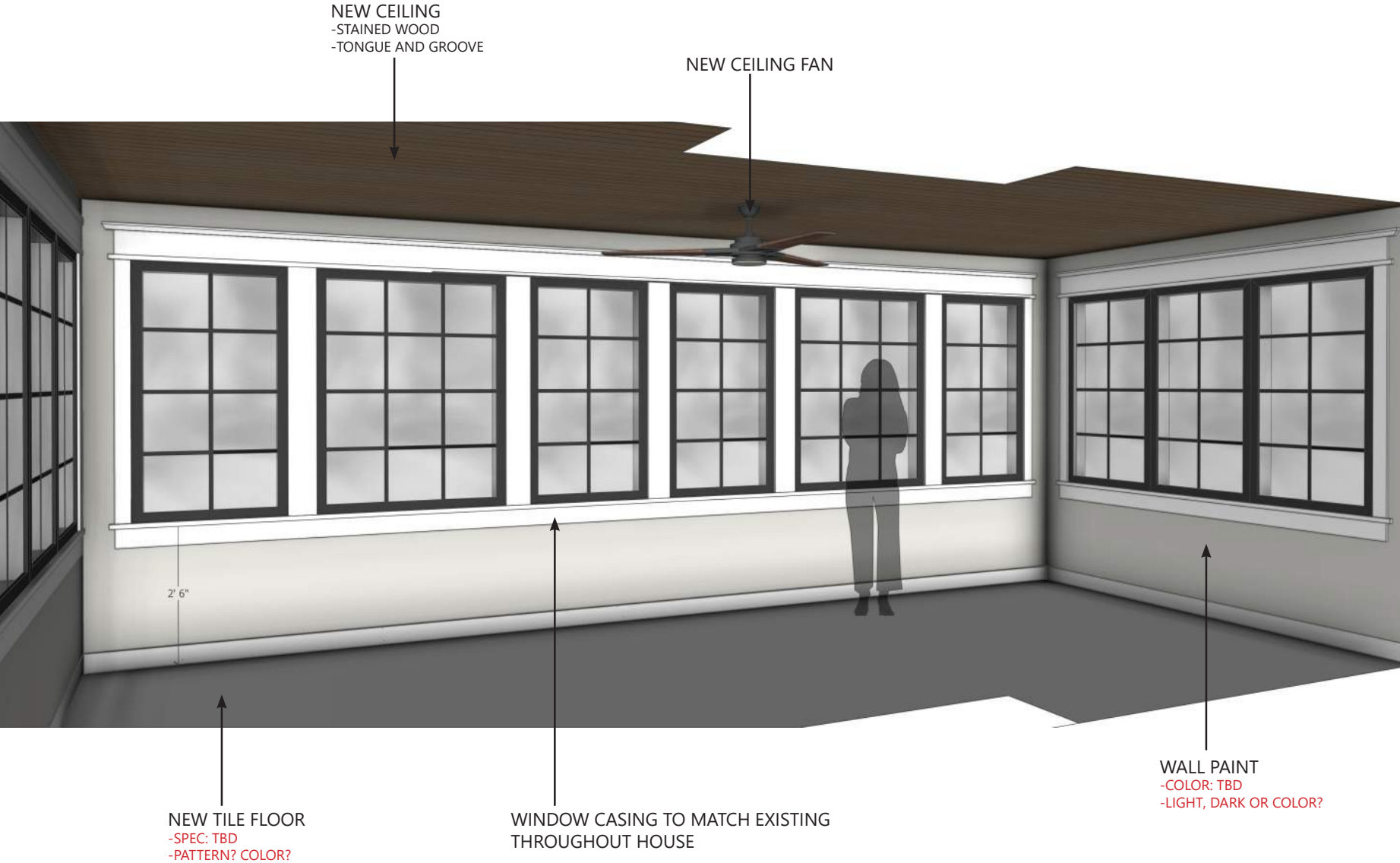



NATE GREEN AND HEATHER CUNNINGHAM
377 S. ROOSEVELT AVE BEXLEY, OH 43209

*PROJECTED CONSTRUCTION START: 9-09-25

OVERALL SCOPE: SUNROOM REMODEL

DRAWING DATE: 06-05-25

GREEN REMODEL

PRE CONSTRUCTION PHOTOS

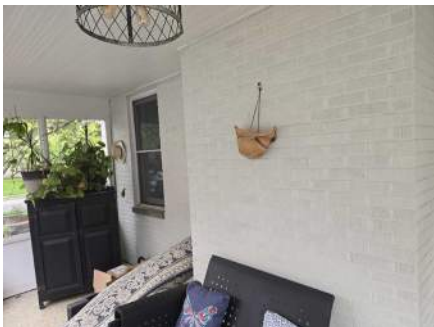

GREEN REMODEL

PRE CONSTRUCTION PHOTOS- INTERIOR SPACES FOR REFERENCE

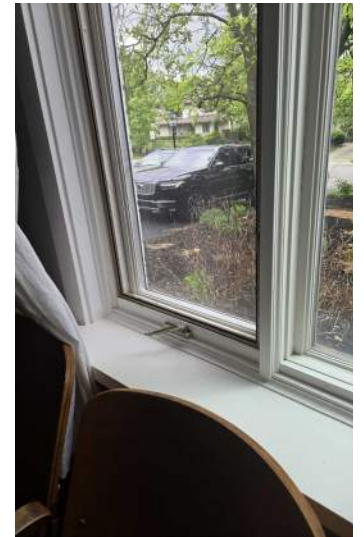

GREEN REMODEL

EXISTING PLAN

*ALL DIMENSIONS TO BE VERIFIED IN FIELD

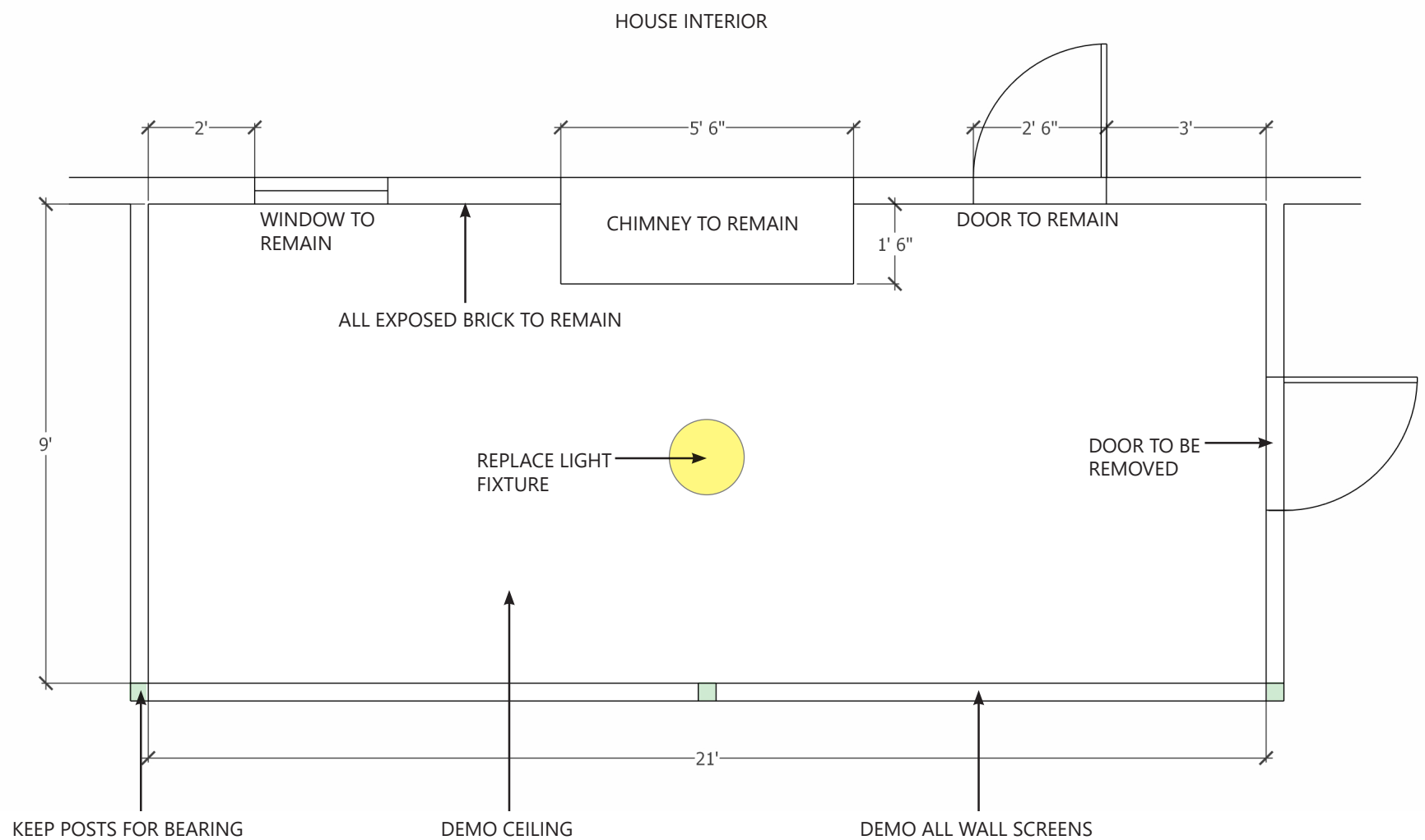

GREEN REMODEL

PROPOSED PLAN

- ALL NEW OUTLETS TO BE INSTALLED PER CODE
- SWITCH LOCATIONS TO BE DETERMINED ON SITE BY HOMEOWNER AND ELECTRICIAN

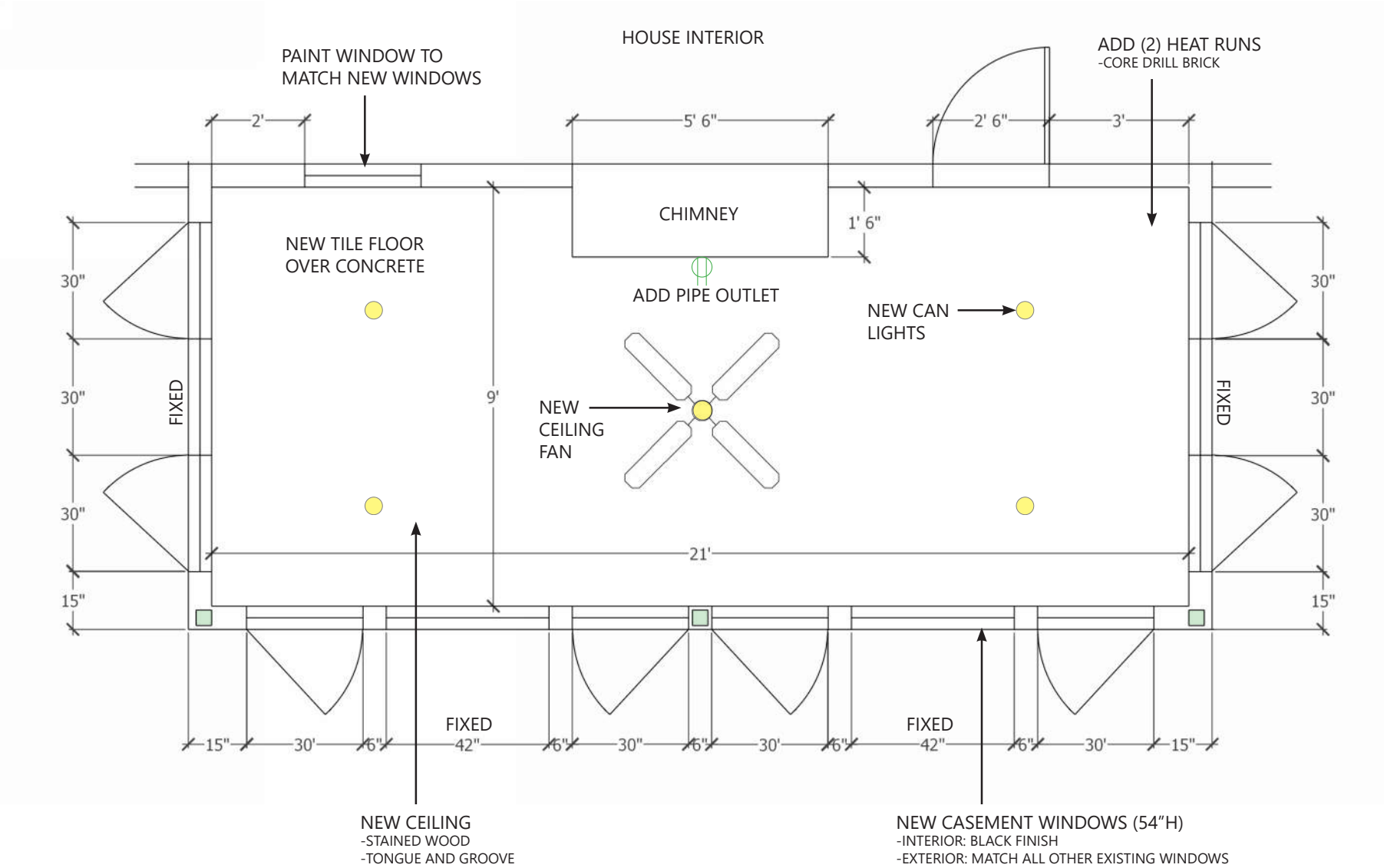

GREEN REMODEL

EXTERIOR- FRONT VIEW

***ALL RENDERINGS ARE CONCEPTUAL-** REQUIREMENTS AND SPECIFICS TO BE DETERMINED IN FIELD. REFER TO CABINET DRAWINGS FOR FINAL LAYOUT AND DIMENSIONS

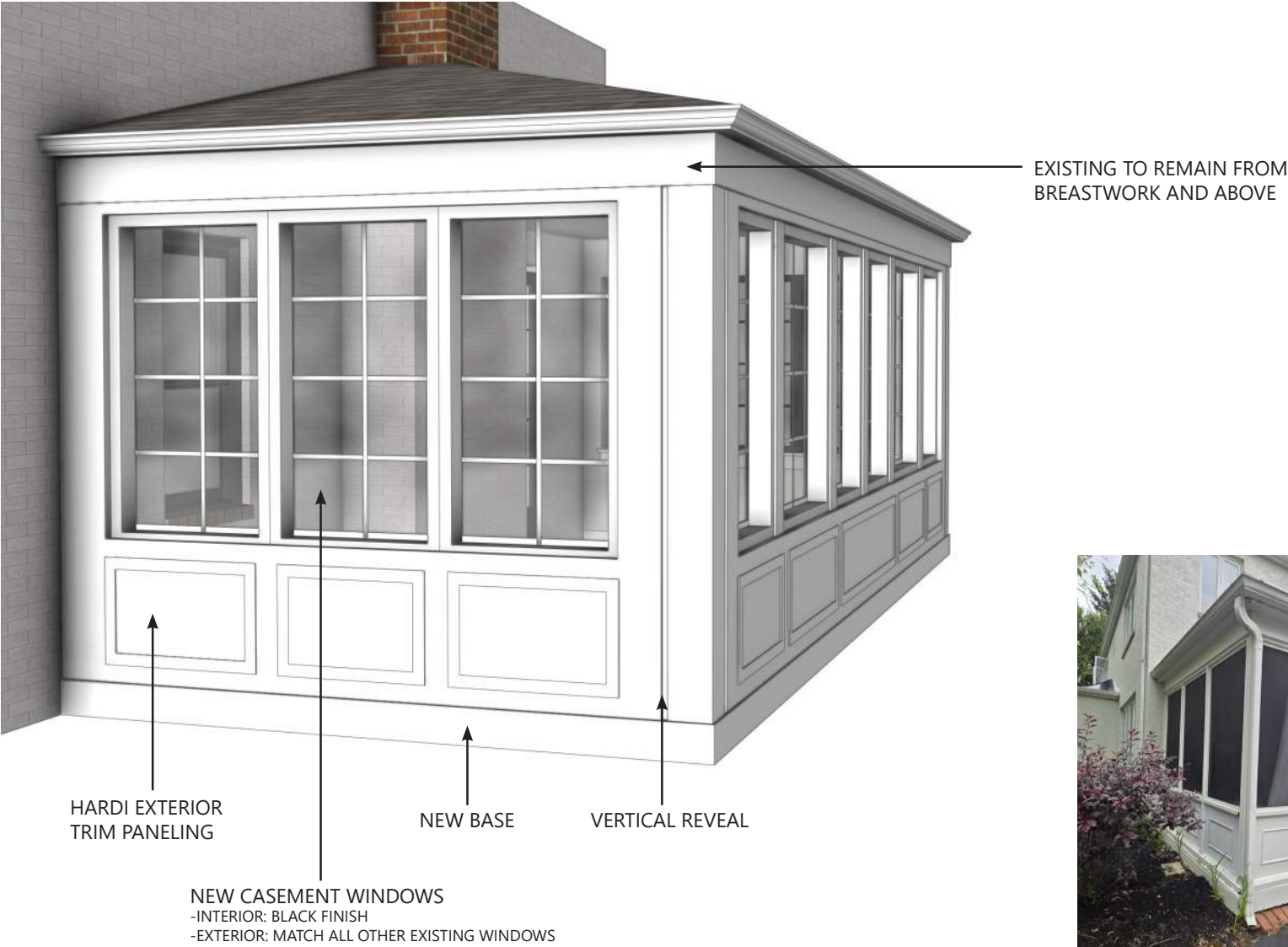

EXISTING FOR REFERENCE

GREEN REMODEL

EXTERIOR- SIDE VIEW



↑
VERTICAL REVEAL

↑
HARDI EXTERIOR
TRIM PANELING



EXISTING FOR REFERENCE

GREEN REMODEL

EXTERIOR- BACK VIEW



EXISTING DOOR TO BE
REMOVED AND REPLACE
WITH WINDOW



EXISTING FOR REFERENCE

GREEN REMODEL

INTERIOR VIEW

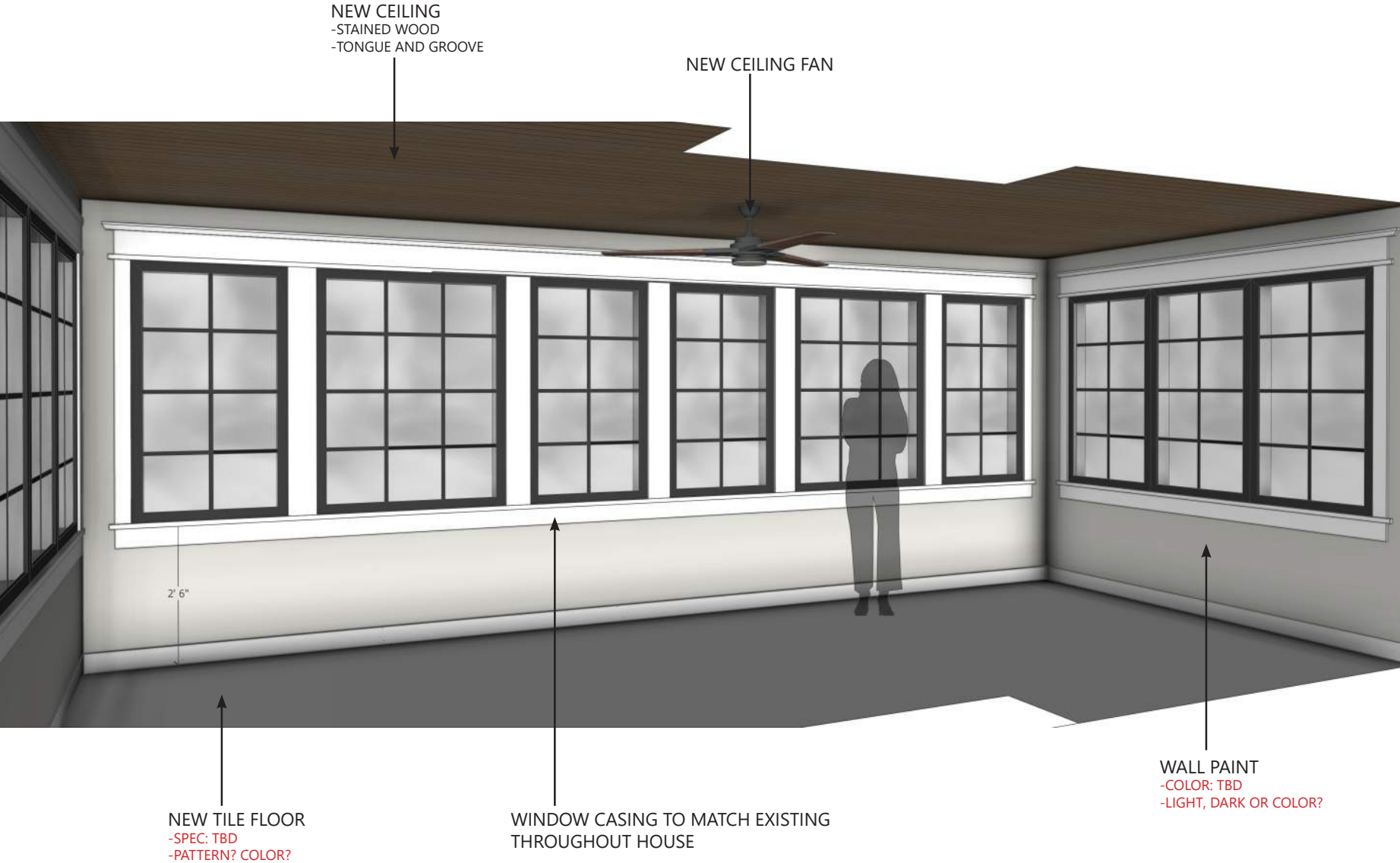



NATE GREEN AND HEATHER CUNNINGHAM
377 S. ROOSEVELT AVE BEXLEY, OH 43209

*PROJECTED CONSTRUCTION START: 9-09-25

OVERALL SCOPE: SUNROOM REMODEL

DRAWING DATE: 06-05-25

GREEN REMODEL

PRE CONSTRUCTION PHOTOS

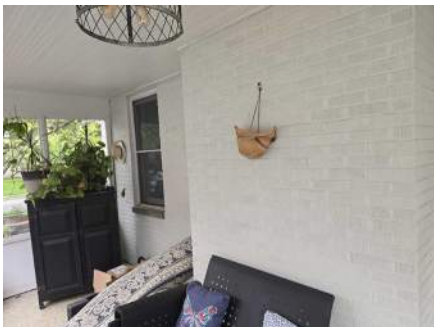

GREEN REMODEL

PRE CONSTRUCTION PHOTOS- INTERIOR SPACES FOR REFERENCE

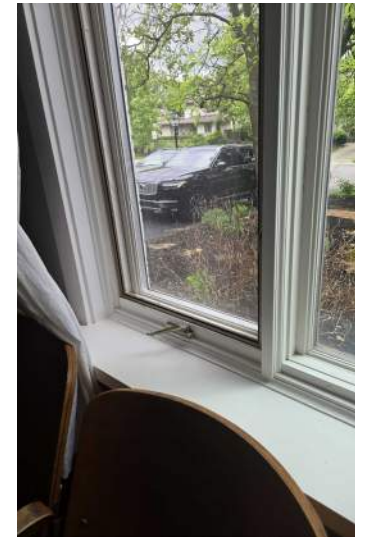

GREEN REMODEL

EXISTING PLAN

*ALL DIMENSIONS TO BE VERIFIED IN FIELD

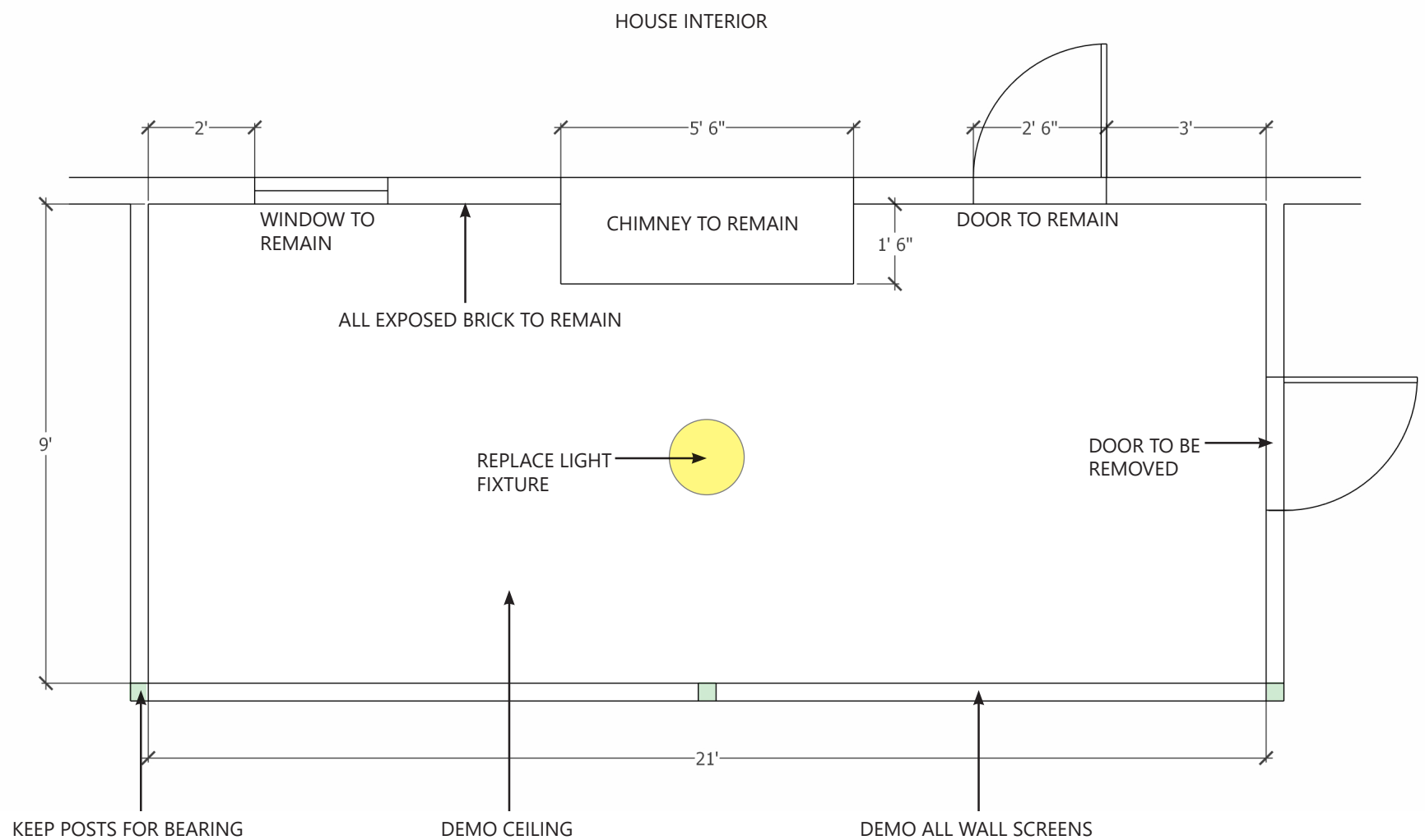

GREEN REMODEL

PROPOSED PLAN

- ALL NEW OUTLETS TO BE INSTALLED PER CODE
- SWITCH LOCATIONS TO BE DETERMINED ON SITE BY HOMEOWNER AND ELECTRICIAN

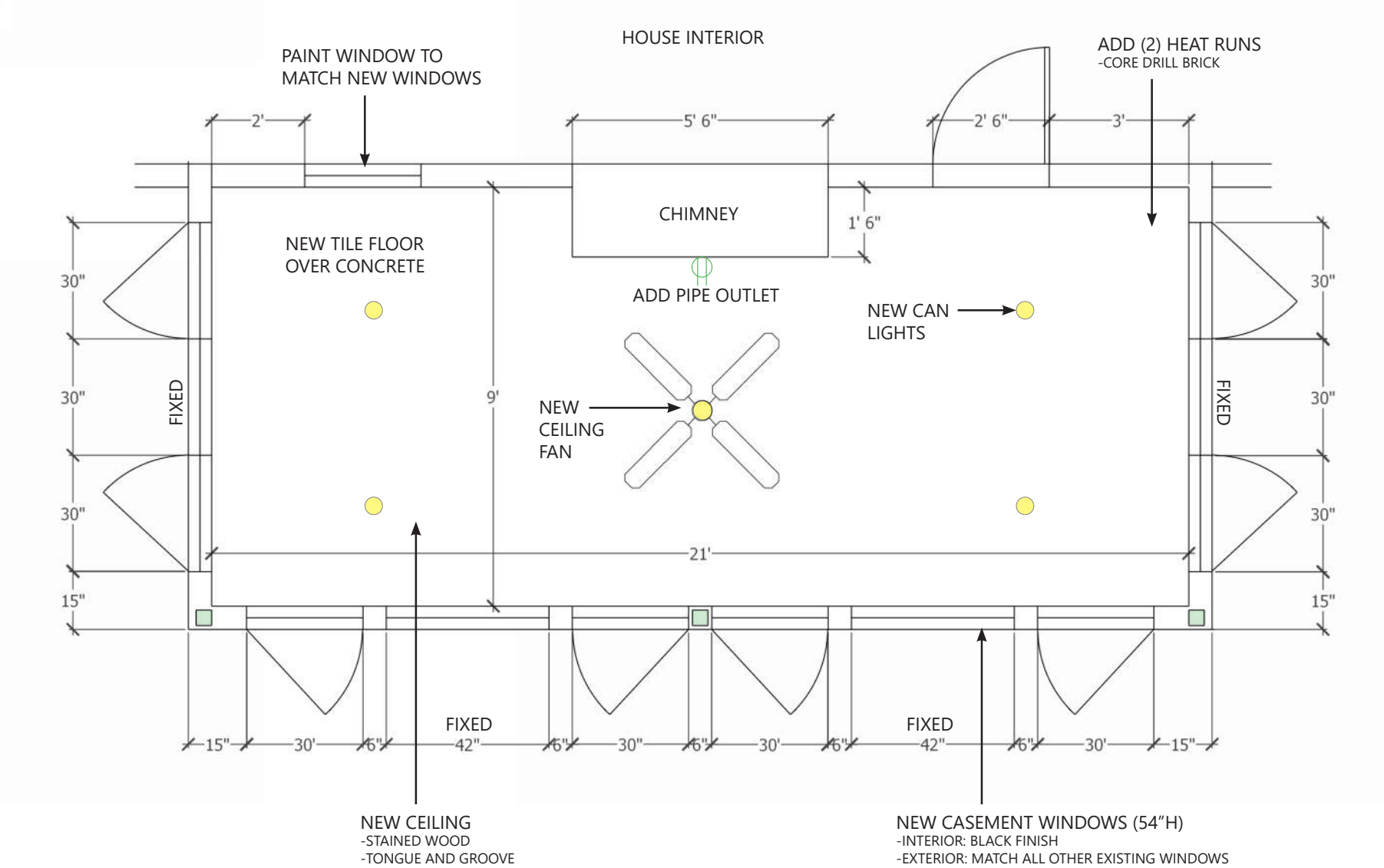

GREEN REMODEL

EXTERIOR- FRONT VIEW

***ALL RENDERINGS ARE CONCEPTUAL**- REQUIREMENTS AND SPECIFICS TO BE DETERMINED IN FIELD. REFER TO CABINET DRAWINGS FOR FINAL LAYOUT AND DIMENSIONS

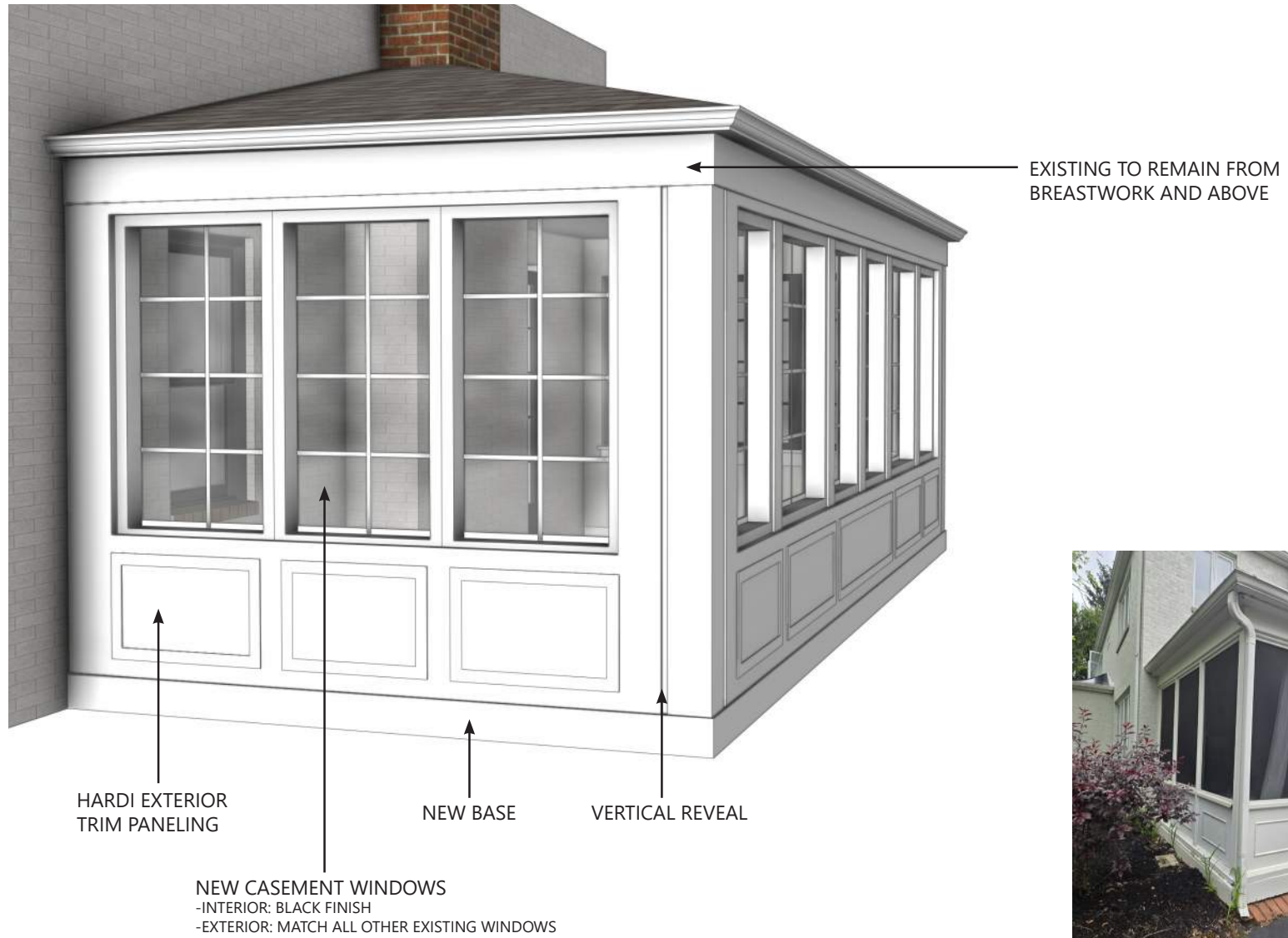

EXISTING FOR REFERENCE

GREEN REMODEL

EXTERIOR- SIDE VIEW



↑
VERTICAL REVEAL

↑
HARDI EXTERIOR
TRIM PANELING



EXISTING FOR REFERENCE

GREEN REMODEL

EXTERIOR- BACK VIEW



EXISTING DOOR TO BE
REMOVED AND REPLACE
WITH WINDOW



EXISTING FOR REFERENCE



GREEN REMODEL

INTERIOR VIEW

