

**PROJECT TITLE: SWIMMING POOL DESIGN AND LANDSCAPE**

**DESCRIPTION:** 9'8" X 7'8" FIBERGLASS SPA LATHAM ROYAL, COLOR: NIGHT SKY (OUTDOOR SPA) AND PAVER PATIO

**PROJECT ADDRESS:** 680 GRANDON AVENUE BEXLEY, OH 43209

**PROJECT OWNER:** SLENKOVICH

**OWNER'S ADDRESS:** 680 GRANDON AVENUE BEXLEY, OH 43209

**PROJECT CONTRACTOR:** OMNI POOLS & SCAPES

**PROJECT CONTRACTOR ADDRESS:** 4445 WEAVER COURT N, HILLIARD, OH 43026

Sheet List	
Sheet Number	Sheet Name
A101	COVER PAGE
A102	DEMO SITE LAYOUT
A103	SITE LAYOUT
A104	SWIMMING POOL LAYOUT
A105	SWIMMING POOL DIMENSION
A106	POOL SECTIONS
A107	DETAILS
A108	SPA COVER DETAILS
A109	ELECTRICAL LAYOUT
A110	PLUMBING PLAN
A111	TYPICAL POOL & SPA PLUMBING LAYOUT WITH HEATER & SALT CELL
A112	POOL DECK EQUIPMENT AND SCHEDULE
A113	FUTURE PERGOLA DETAILS



<u>General Contractor</u>	<u>Pool Contractor</u>	<u>Project Address</u>
	Omni Pools & Scapes 4445 Weaver Court N Hilliard, OH 43026	680 Grandon Ave, Bexley, OH 43209

Drawn by: Omni Pools  
 Date: 01-13-2025  
 Project #: Slenkovich  
 Sheet Name: Cover Page

A101

Scale:

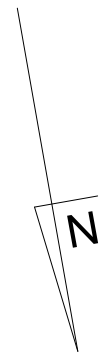

PROPERTY LINE

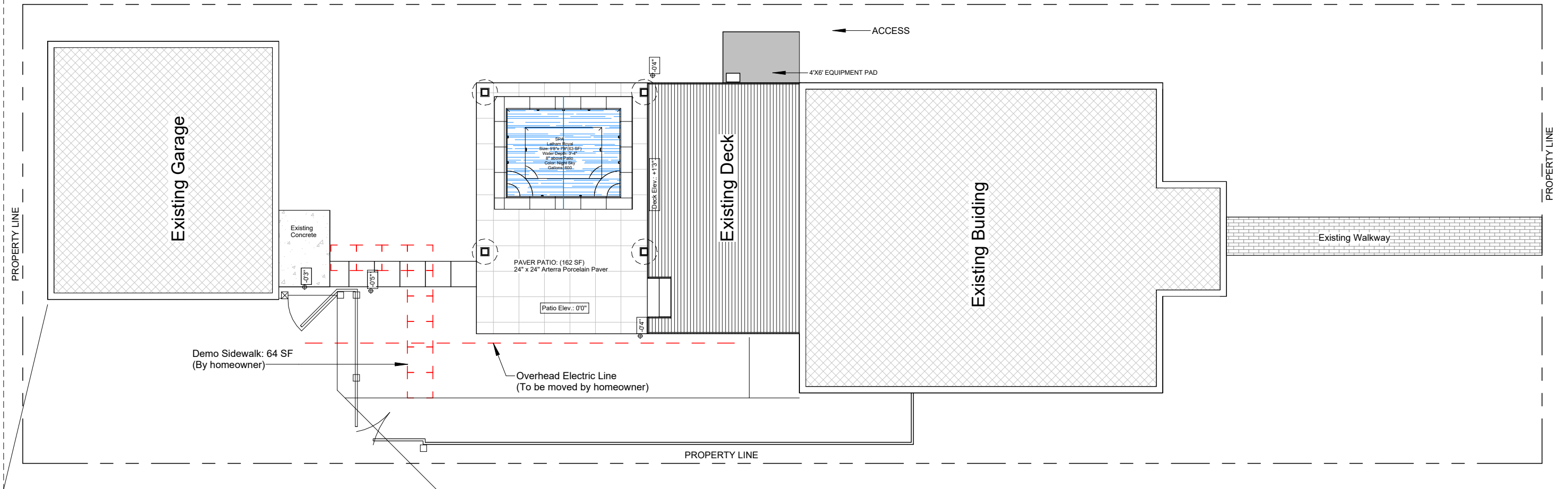

PROPERTY LINE

GRANDON AVE



General Contractor

Pool Contractor

Project Address

Omni Pools & Scapes  
4445 Weaver Court N  
Hilliard, OH 43026

680 Grandon Ave,  
Bexley, OH 43209

Drawn by: Omni Pools

Date: 01-13-2025

Project #: Slenkovich

Sheet Name: Demo Site Layout

A102

Scale: 1/8" = 1'-0"

**LOT COVERAGE:**

Lot = 4290.14 SF

**Existing Impervious Area**

Existing Building: = 738.23 SF

Existing Garage: = 367.38 SF

Existing Concrete Patio: = 24 SF

Existing Concrete Walkway: = 74.25 SF

Existing Concrete Drive: = 331.45 SF

Existing Step: = 5.54 SF

Existing Deck: = 230.71 SF (Not Included in the Calculation)

**Total Existing Impervious Area = 1771.56 SF**

**Total Existing Impervious Area = 1540.85 SF (without Existing Deck)**

**New Impervious Area**

Spa Surface Area: = 63 SF

Spa Coping Area: = 32.70 SF

Paver Patio: = 168.45 SF

Paver Block Walkway: = 23 SF

Equipment Pad: = 24 SF

**Total New Impervious Area = 311.15 SF**

**Total Lot Coverage = 2082.71 SF**

**Total Lot Coverage Percentage = 48.55%**

**Total Lot Coverage without Existing Deck: = 1852 SF**

**Total Lot Coverage Percentage = 43.17% (without Existing Deck)**

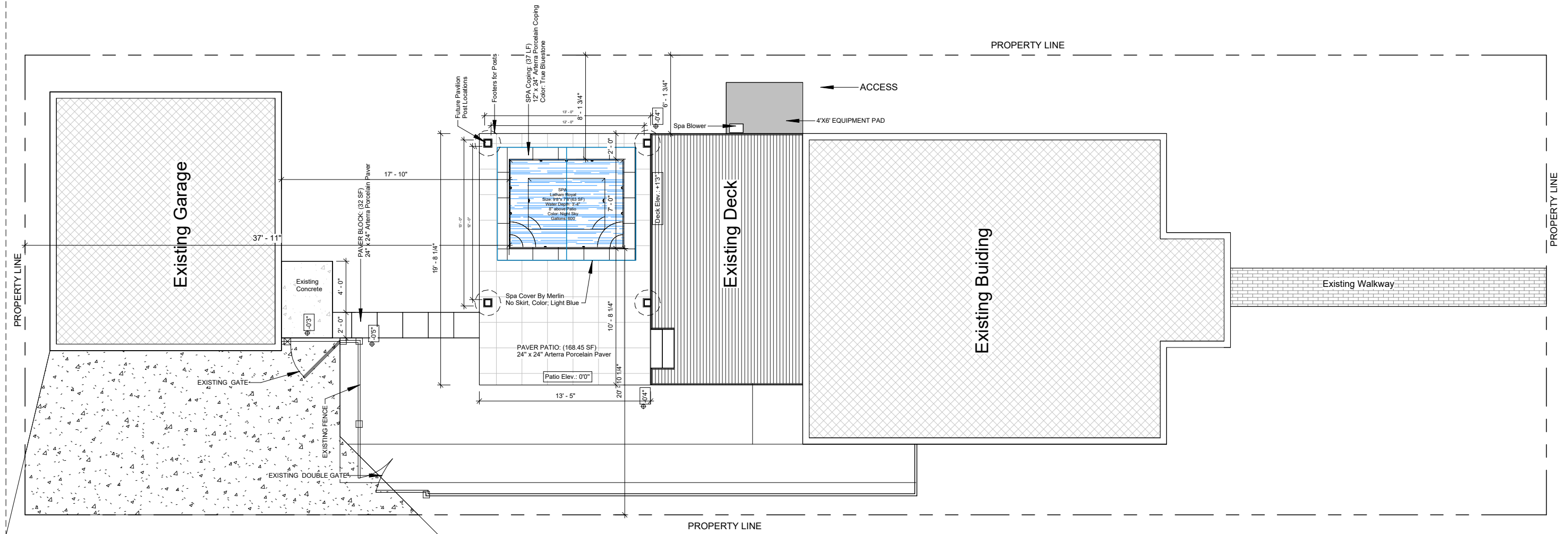

General Contractor

Pool Contractor

Project Address

Omni Pools & Scapes  
4445 Weaver Court N  
Hilliard, OH 43026

680 Grandon Ave,  
Bexley, OH 43209

Drawn by: Omni Pools

Date: 01-13-2025

Project #: Slenkovich

Sheet Name: Site Layout

A103

Scale: 1/8" = 1'-0"

GRANDON AVE

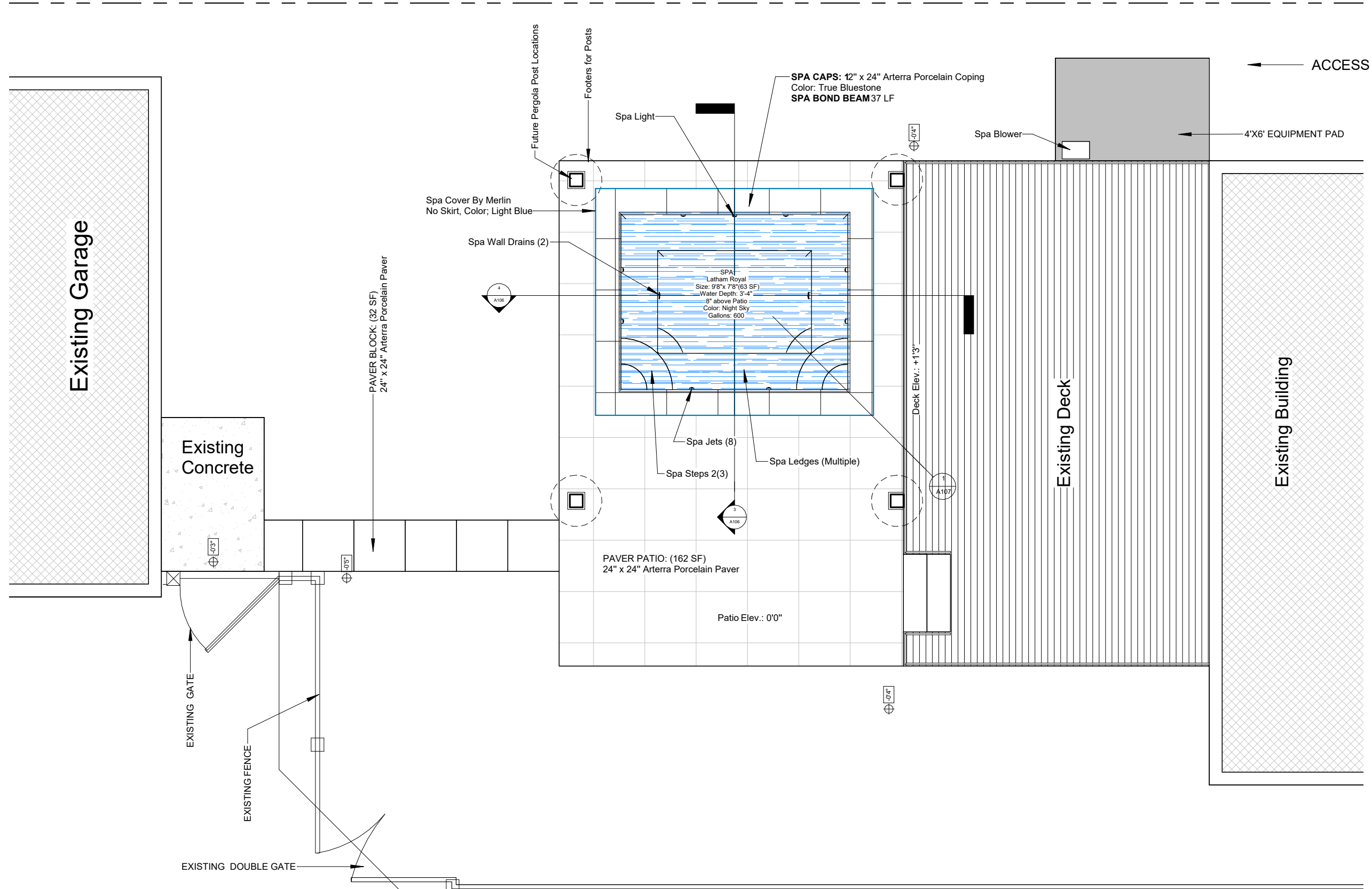

General Contractor

Pool Contractor

Project Address

Drawn by: Omni Pools

PROPERTY LINE

Date: 01-13-2025

Project #: Slenkovich

Sheet Name: Swimming Pool Layout

Omni Pools & Scapes  
4445 Weaver Court N  
Hilliard, OH 43026

680 Grandon Ave,  
Bexley, OH 43209

A104

Scale: 1/4" = 1'-0"

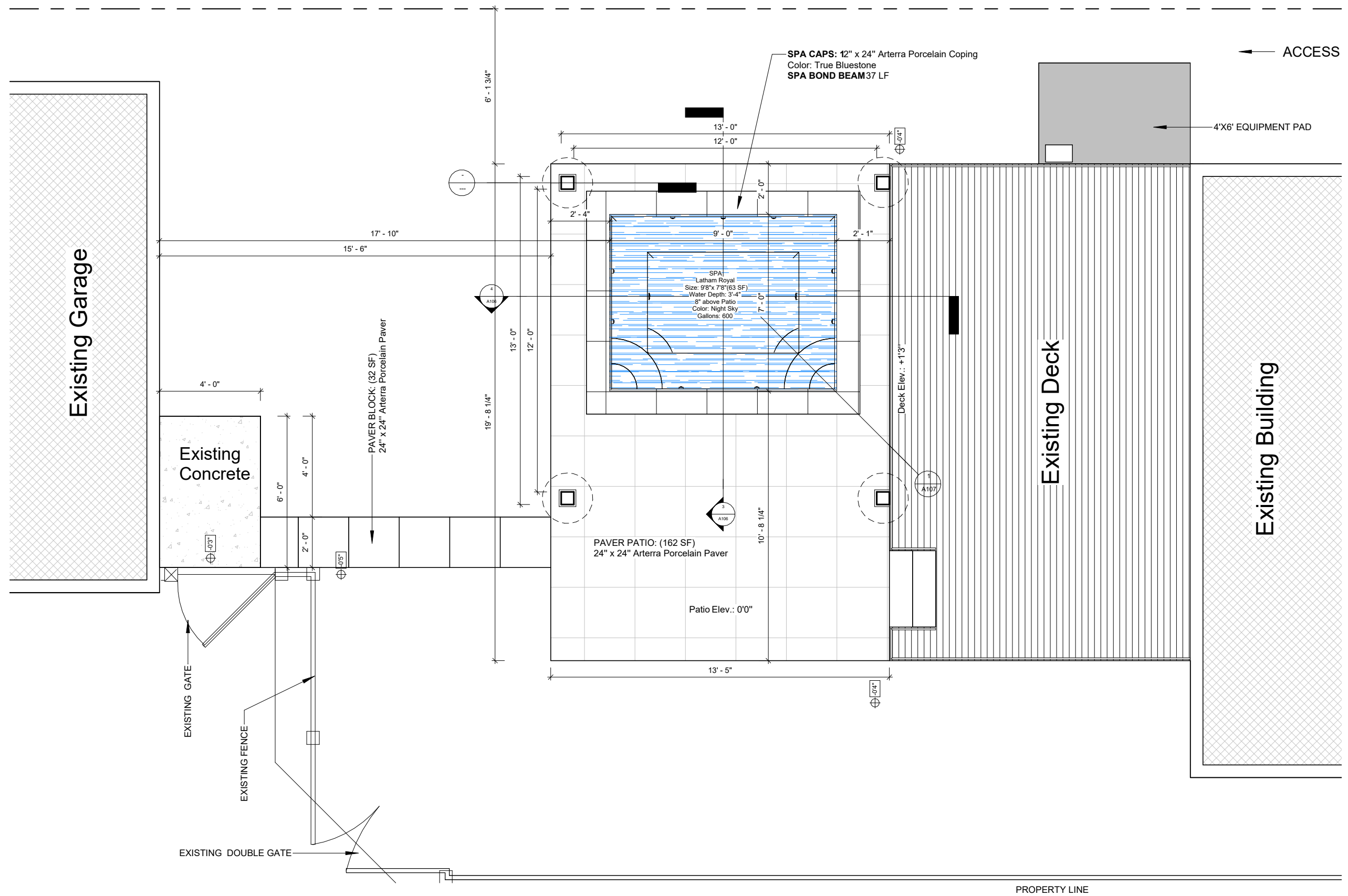

General Contractor  
Pool Contractor  
 Omni Pools & Scapes  
 4445 Weaver Court N  
 Hilliard, OH 43026

Project Address  
 680 Grandon Ave,  
 Bexley, OH 43209

Drawn by: Omni Pools  
 Date: 01-13-2025  
 Project #: Slenkovich  
 Sheet Name: Swimming Pool Dimension

A105

Scale: 1/4" = 1'-0"

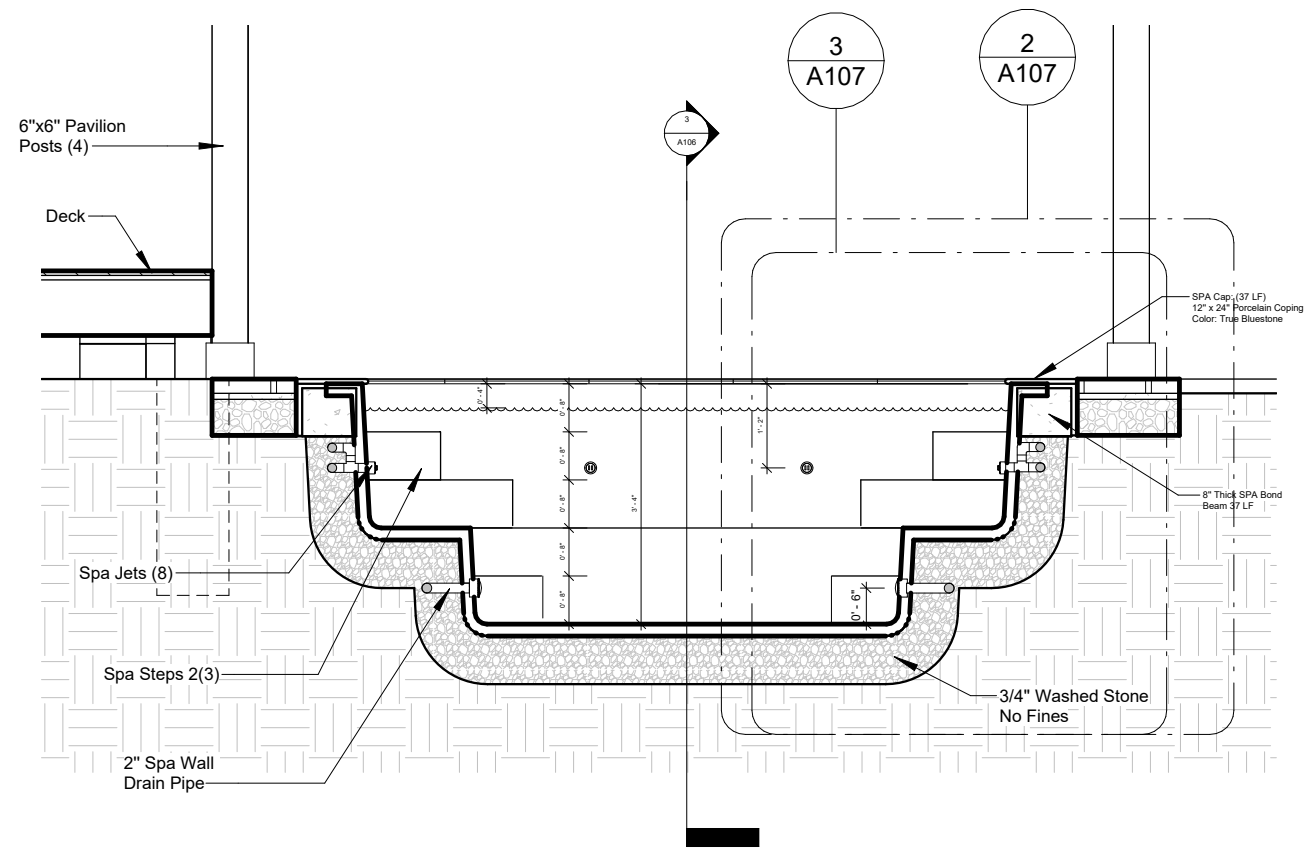

4 Spa Section 2  
3/8" = 1'-0"

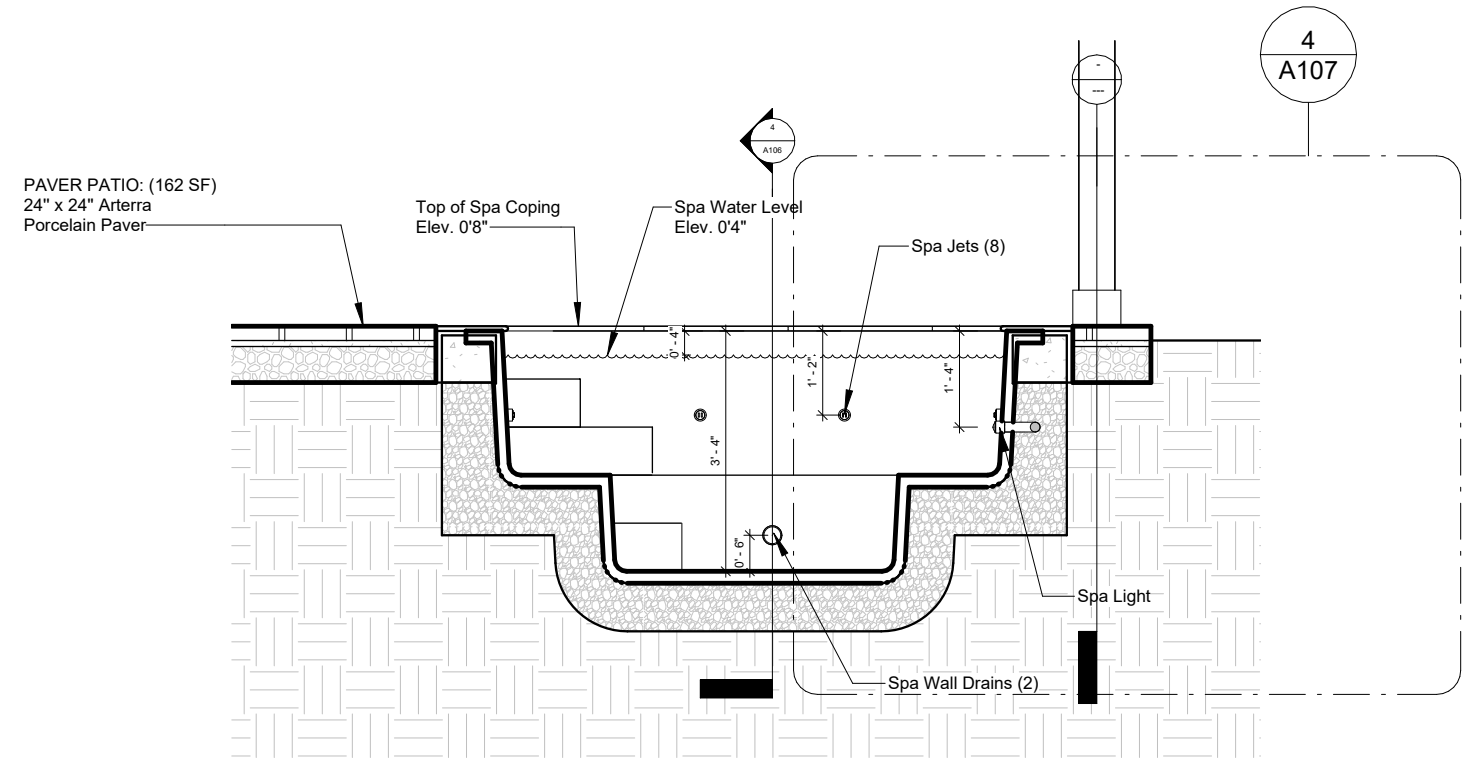

3 Spa Section 1  
3/8" = 1'-0"



<u>General Contractor</u>	<u>Pool Contractor</u>	<u>Project Address</u>
	Omni Pools & Scapes 4445 Weaver Court N Hilliard, OH 43026	680 Grandon Ave, Bexley, OH 43209

Drawn by: Omni Pools  
Date: 01-13-2025  
Project #: Slenkovich  
Sheet Name: Pool Sections

A106

Scale: 3/8" = 1'-0"

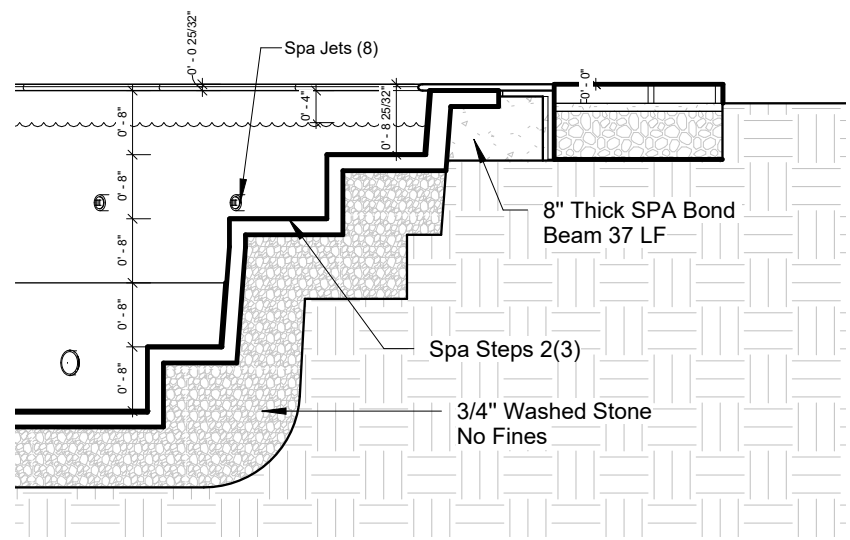

1 Spa Step Detail  
1/2" = 1'-0"

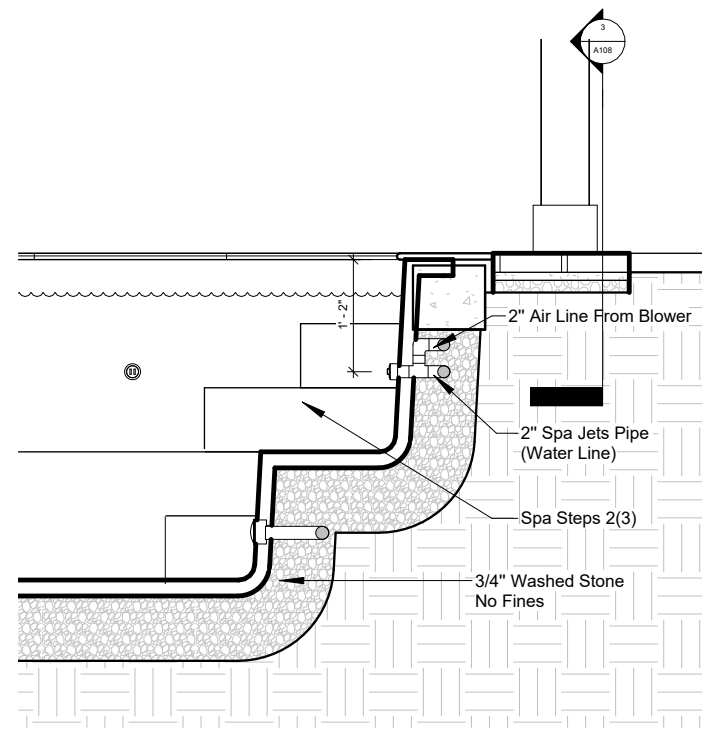

2 Spa Jet & Blower Detail  
1/2" = 1'-0"

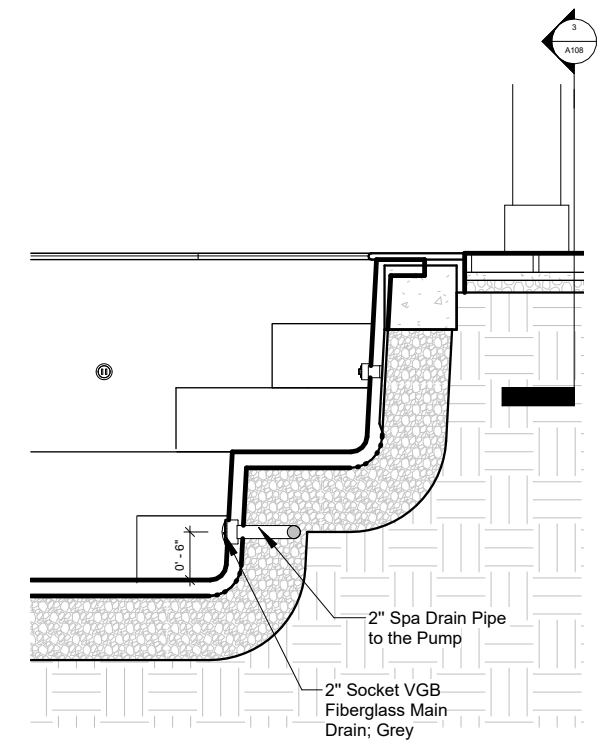

3 Spa Wall Drain Detail  
1/2" = 1'-0"

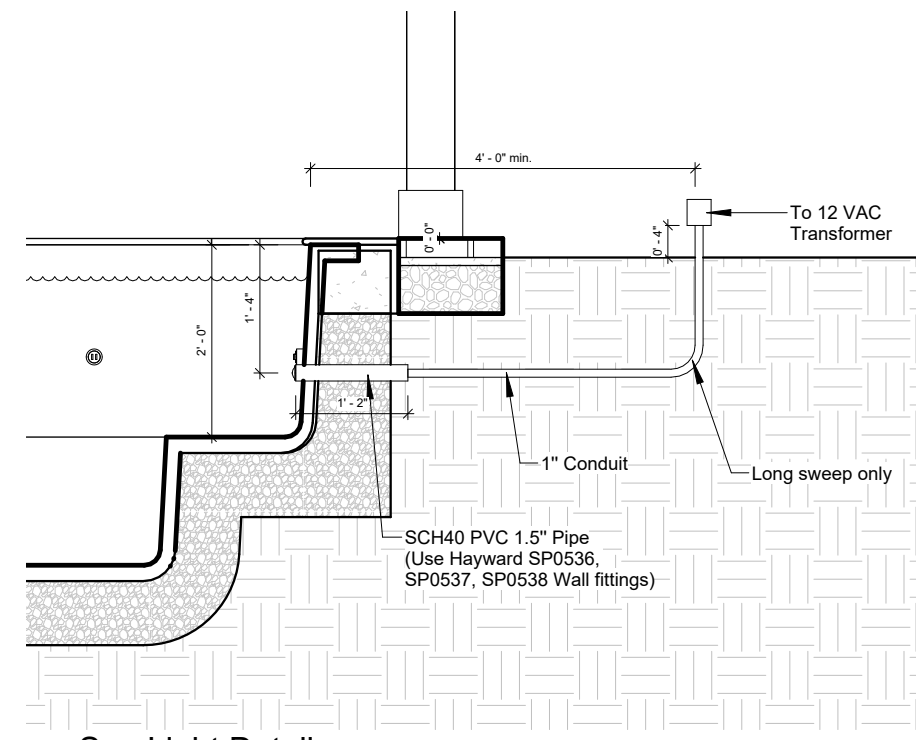

4 Spa Light Detail  
1/2" = 1'-0"

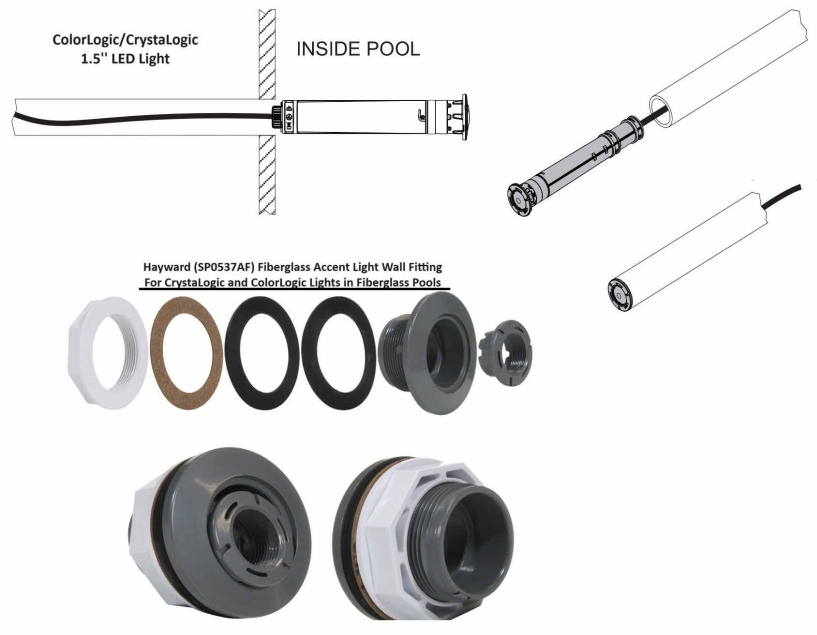

5 Hayward SP0537AF Detail  
1/2" = 1'-0"

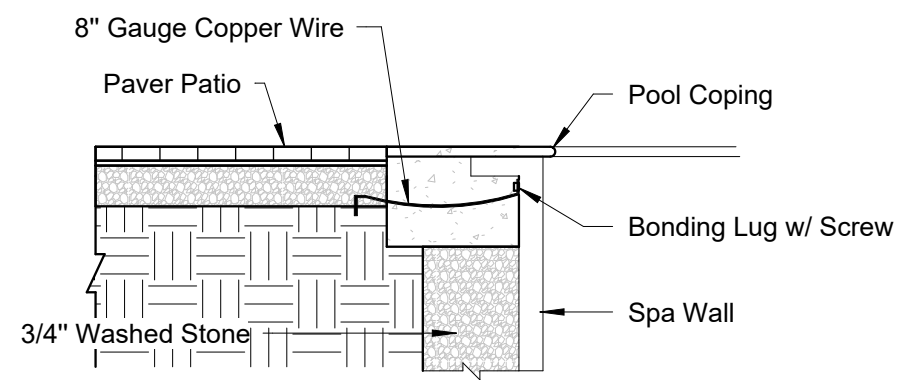

6 Bonding and Grounding Detail  
3/4" = 1'-0"



General Contractor

Pool Contractor

Project Address

Drawn by: Omni Pools  
Date: 01-13-2025  
Project #: Slenkovich  
Sheet Name: Details

Omni Pools & Scapes  
4445 Weaver Court N  
Hilliard, OH 43026

680 Grandon Ave,  
Bexley, OH 43209

A107

Scale: As indicated

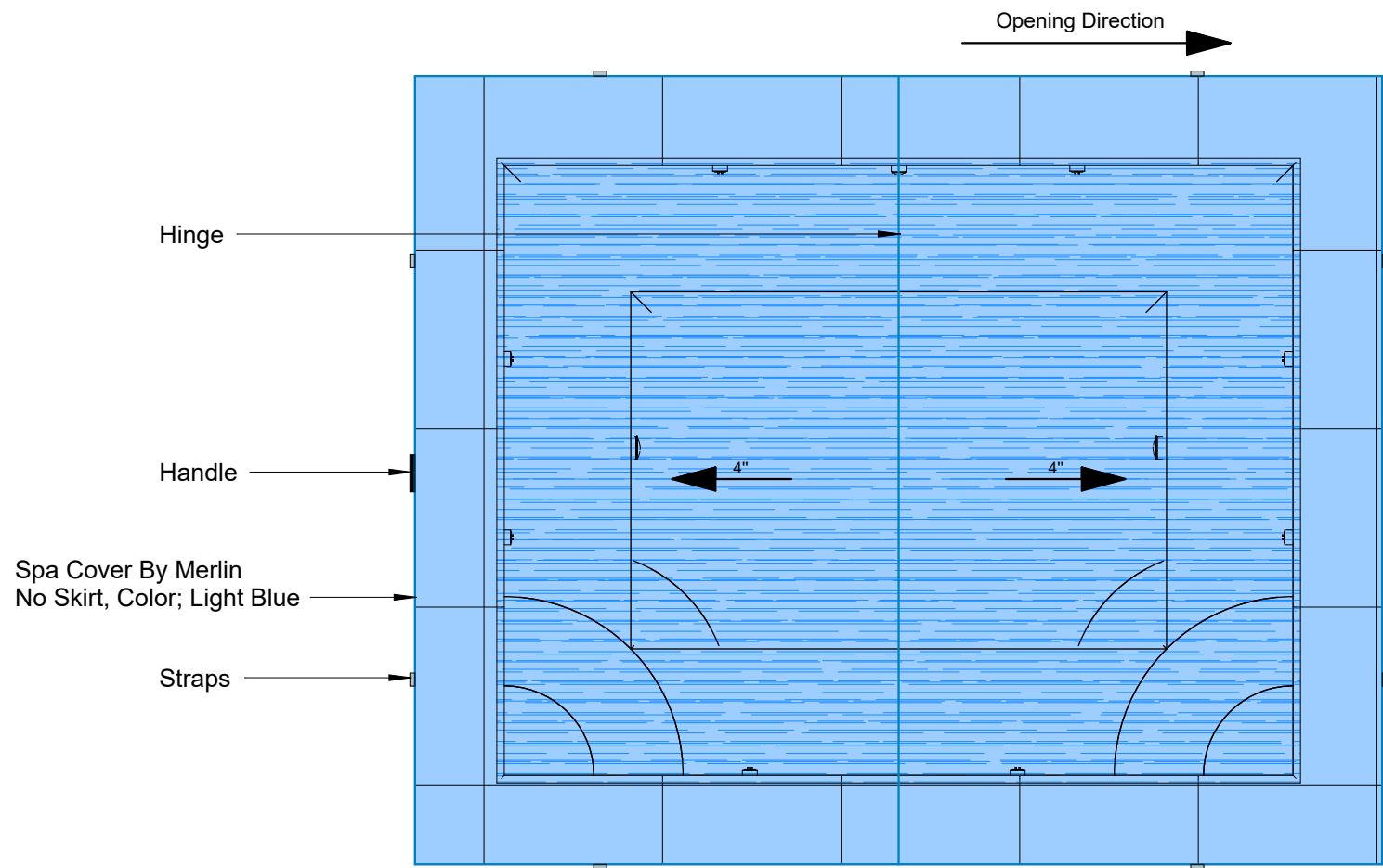

① Spa Cover Plan  
1/2" = 1'-0"

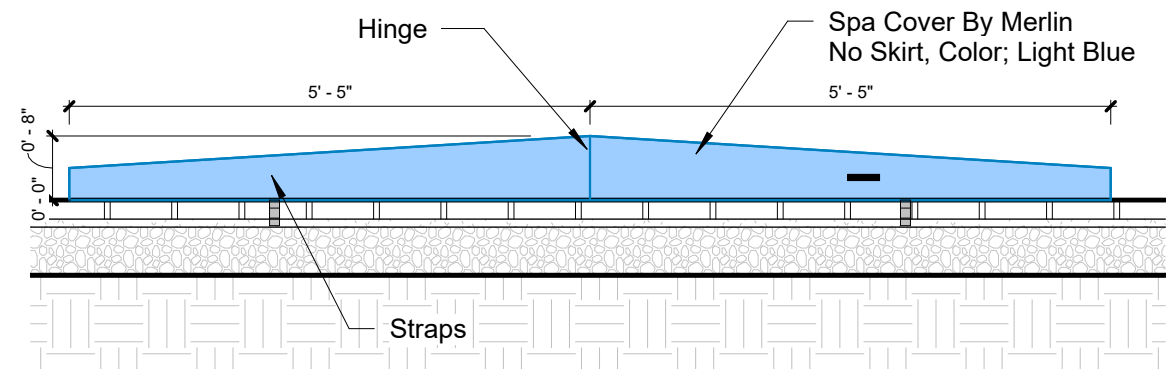

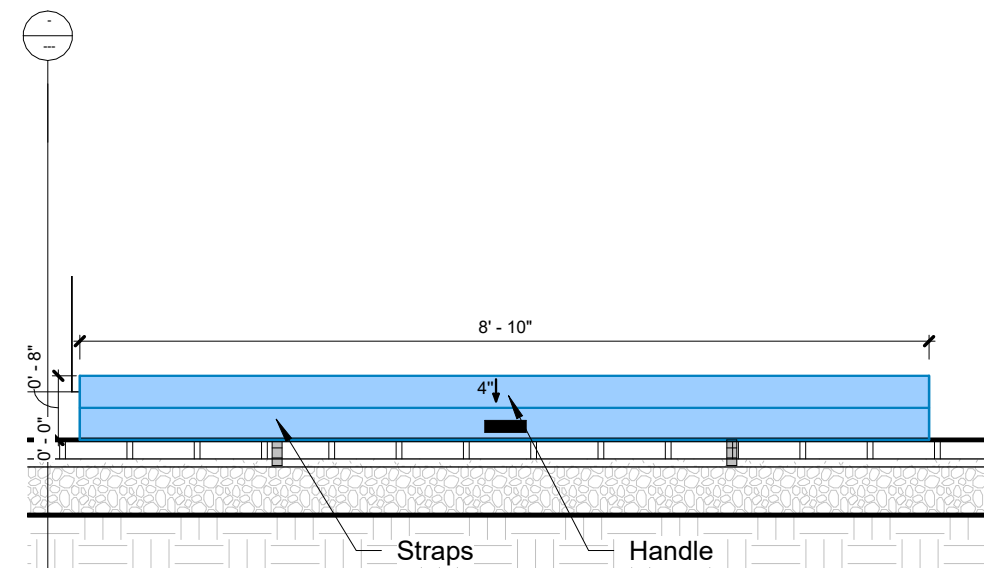

② Spa Cover Elevation 1  
1/2" = 1'-0"



③ Spa Cover Elevation 2  
1/2" = 1'-0"



ID	Qty	Description	Model #	Manufacture	Gas Connection	Volts	Breaker
1	1	Pool Pump, Tristar VS 900 Pump (1.85 h.p)	SP32900VSP	Hayward		230	20
2	1	Spa Gas Heater	xxx	Hayward	BTU 150K		
3	1	In-Line Chlorinator	xxx	Hayward		110	15
4	1	In-Line Chlorinator Power Center	xxx	Hayward		120	15
5	1	Spa Light Transformer	LTBUY11300	Hayward		12	6
6	1	Spa Blower (2h.p)	SPB 202	Hayward		230	20

LEGEND	
	Low Voltage
	Bonding Wire
	High Voltage

**NOTE**

**Equipment Placement:**

Arrange the pool equipment on an equipment pad with ample space for maintenance and repairs.

**Common layout:**

Pumps on one side, filter in the middle, and heater on the other side. Pipes from the pool come up from gravel along the side of the equipment pad. Ensure you can walk, stand, and kneel comfortably around the equipment.

**Valve Placement:**

Position the valves in front of you as you approach the equipment pad. Access to the electrical box should be on the left or right side, not behind the equipment, to avoid reaching over it.

**Electrical Components:**

Wire the pool electrical panel with different types of circuit breakers, relays, outlets, and transformers. Differentiate between standard and GFCI breakers. Connect them to the neutral and ground bars. Wire the control panel, lights, salt system, and filter pump. Properly label the conduits.

**Wiring Method (Conduit wiring):**

It involves running electrical wires through conduit pipes made of metal, plastic, or fiber. This type of wiring offers protection against environmental damage, mechanical damage, and electrical interference.

3/4" PVC Pipe will be used to run the conductors (12 AWG Solid Copper wires) through a trench of 12" deep below grade when the conductors are GFCI Protected and 18" deep below grade when not protected. Piping of the conductors will be minimum of 60" from edge of the pool. Bonding conductors with minimum of 8 AWG solid copper conductor.

**Ground-Fault Circuit-Interrupter (GFCI):**

An electrical device, either a receptacle or circuit breaker, which is designed to protect people from electric shock. GFCI is used in all the receptacles to protect pool users.

**Service Conductors:** The wire or sets of wires that transmit electricity from a transformer or other sources on a distribution line to facility.

**Overcurrent Device (Circuit Breaker):** Branch circuit starts at the final overcurrent device

**Branch Circuit:**

The conductors between the final overcurrent device and the outlet(s)

**Electric Panel:**

The central hub connecting the power lines from the Feeder to Pool Receptacles

**Ends (Receptacles):**

Where the load is connected

**Spa Motor:**

1.85 HP Spal Motor will be wired with #12 AWG Type NM cable on a 20 Amp GFCI Breaker.

**Spa Heater:**

Spa Heater is powered by natural gas. Hayward Gas Heater, BTU 150K

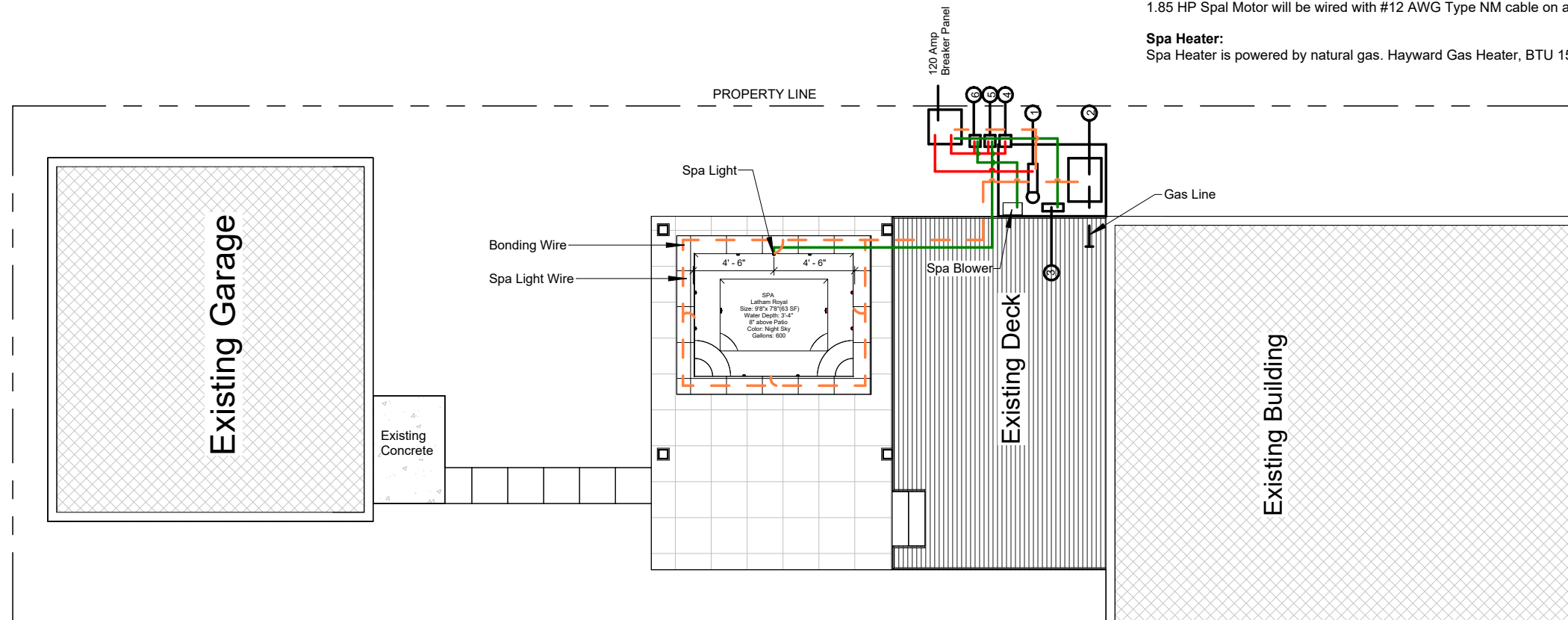

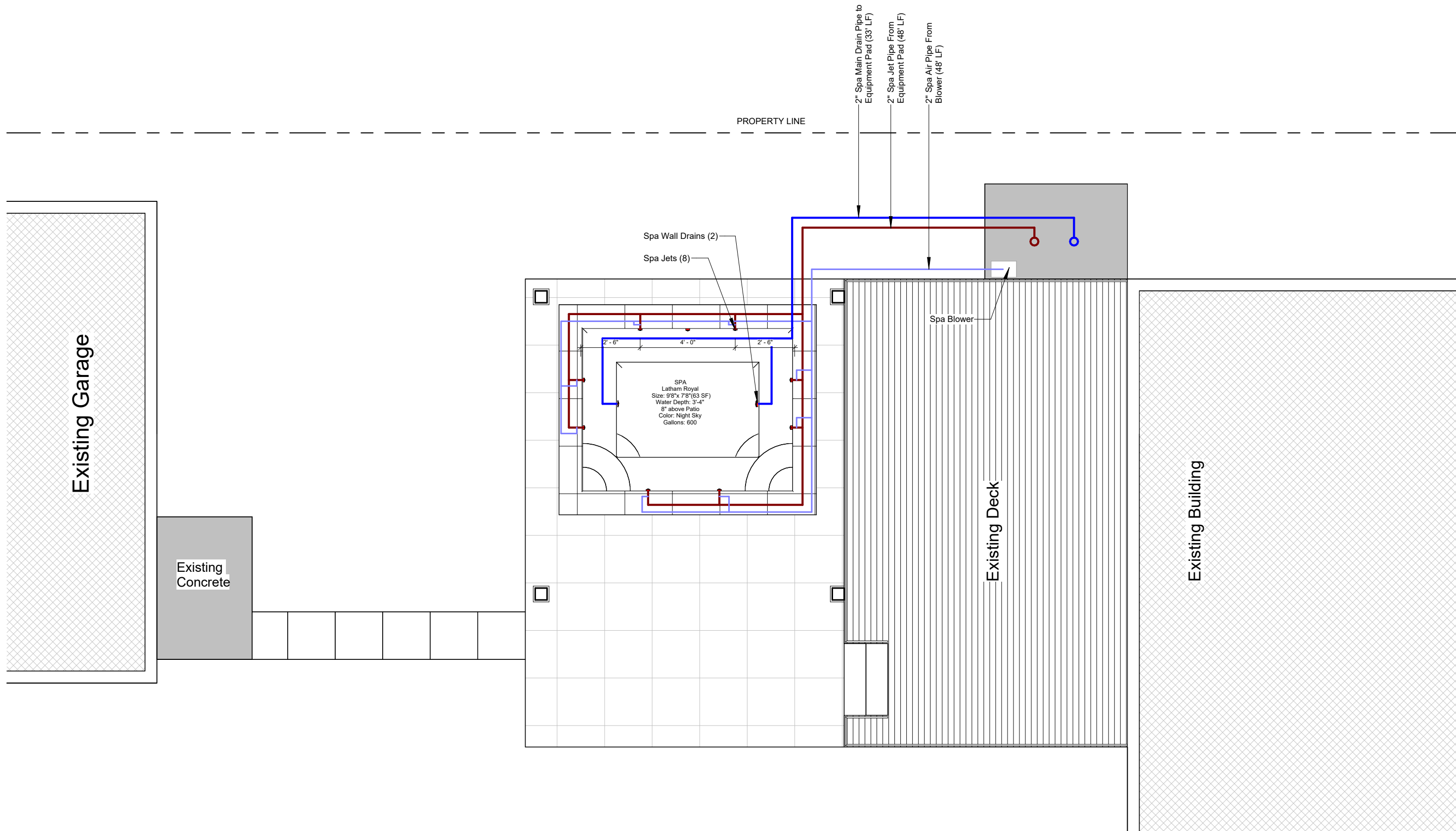

General Contractor

Pool Contractor

Project Address

Drawn by: Omni Pools

Date: 01-13-2025

Project #: Slenkovich

Sheet Name: Plumbing Plan

Omni Pools & Scapes  
4445 Weaver Court N  
Hilliard, OH 43026

680 Grandon Ave,  
Bexley, OH 43209

A110

Scale: 1/4" = 1'-0"

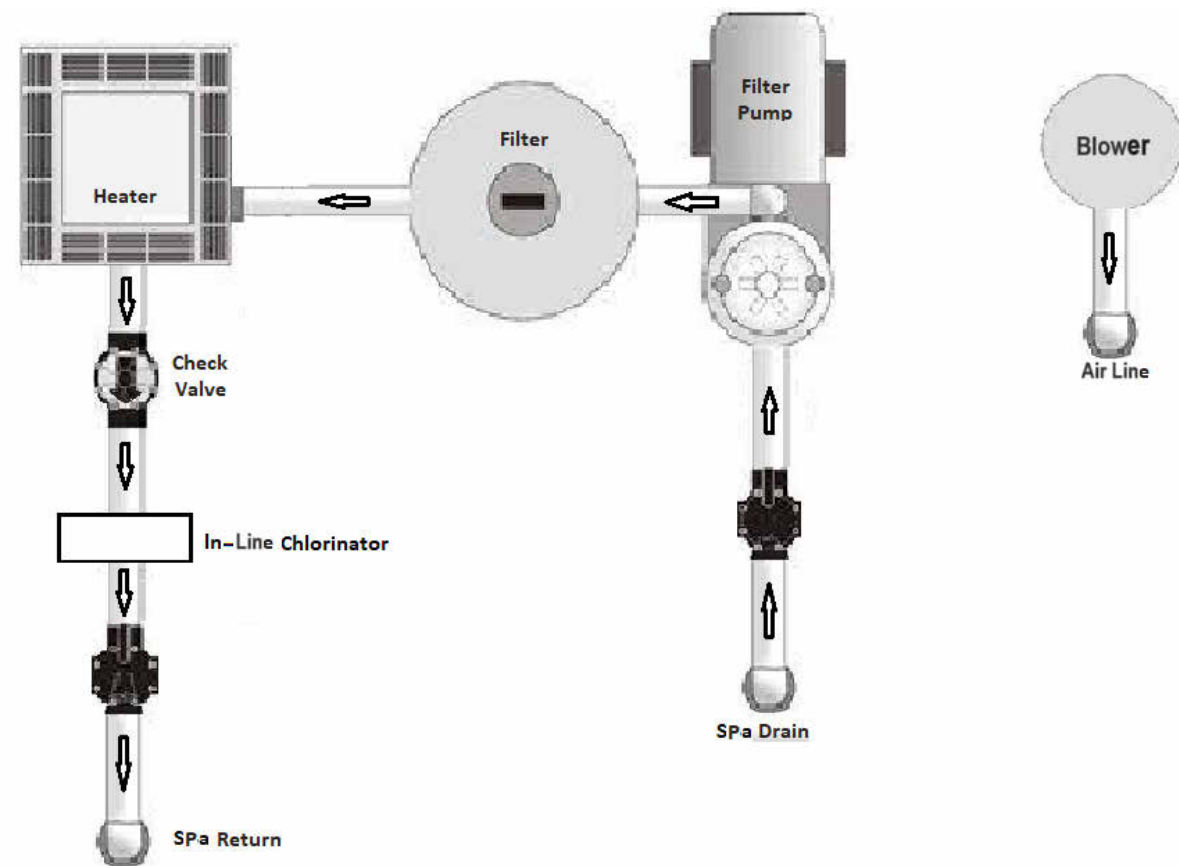

1 Typical Pool Plumbing Layout with Heater & Salt Cell (Plan)  
1/4" = 1'-0"

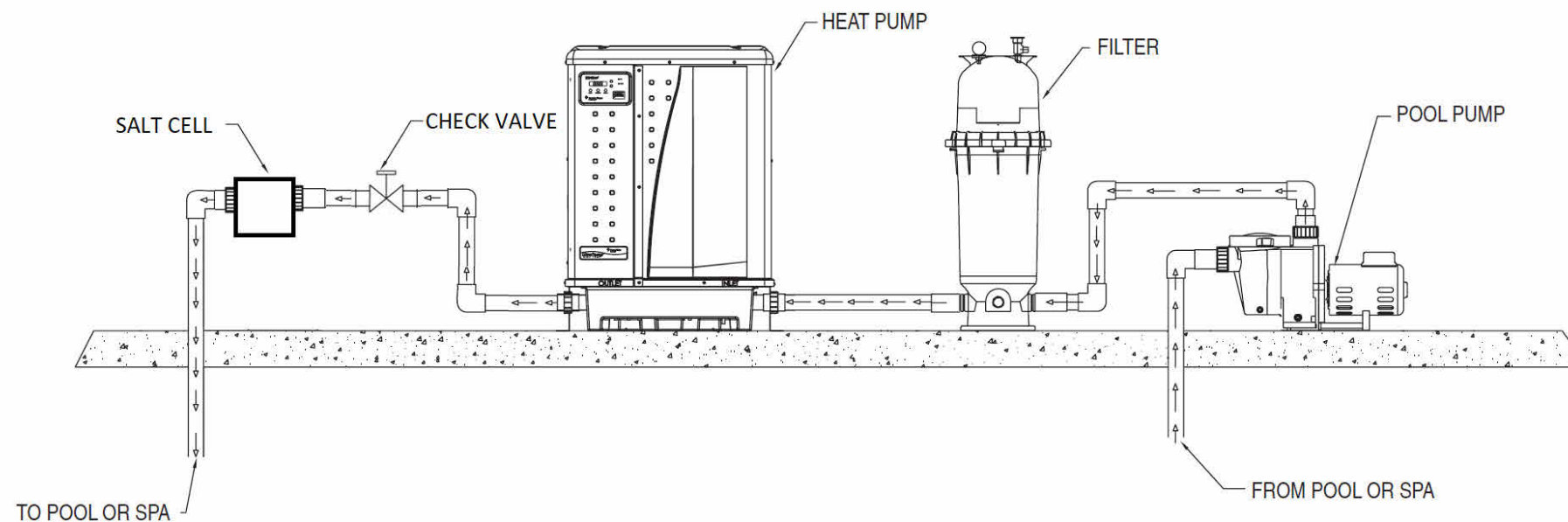

2 Typical Pool Plumbing Layout with Heater & Salt Cell (Elevation)  
1/4" = 1'-0"



General Contractor

Pool Contractor

Project Address

Omni Pools & Scapes  
4445 Weaver Court N  
Hilliard, OH 43026

680 Grandon Ave,  
Bexley, OH 43209

Drawn by: Omni Pools

Date: 01-13-2025

Project #: Slenkovich

Sheet Name: Typical Pool & Spa Plumbing Layout with Heater & Salt Cell

A111

Scale: 1/4" = 1'-0"

Pool and Spa Equipment Specifications	
9'8" x 7'8" Latham Royal, Color; Night Sky, Outdoor Pool	
Spa Surface Area	63 square feet / 50 = 1 Occupants
Deck Area	162 - square feet / 15 = 11 Occupants
Maximum Bather Load	XX Total Occupants Load
Spa Perimeter	37'
Pool Volume	600
Recirculation Pump	1) Hayward Trsitar VS900, 1.85h.p. Recirculation Pump with Strainer & Basket; 011056 113 g.p.m @ 70' of Head 7.99 Hour Turnover Rate, N.S.F Approved
Cartridge Filter	C200S Hayward Cartridge Filter
In-Line Chlorinator	(1) Hayward In-line chlorinator 2inch
Spa Main Drains	(2) Main drain for vinyl liner and fiberglass pools are provided with an SP1048B mounting ring and two (2) gaskets. The gaskets should be placed on either side of the liner. The ring is held to the main drain body by eight (8) screws that pass through the liner. The cover is held to the body by two (2) screws. Tighten all screws securely.
Spa Cover	Merlin-No Skirt, Color; Light Blue, Size; To Fit Spa
Spa Underwater Lights	(1) Hayward Colorlogic LED Light
Gas Heater	Hayward Heat for Spa - 150k Natural Gas Heater
Spa Cap	(37' LF) 12" x 24" Arterra Porcelain Coping, Color: True Bluestone
Spa Jets w/ Air Lines	(8) Hayward Spa Jet, Platinum Grey
Spa Blower	Hayward SP 202
Piping	All underground & above-ground pool plumbing will be P.V.C. Schedule 40. A.S.TM 01785 N.S.F Approved - P.W

Pool And Spa Equipment Schedule				
Qt.	Description	Part #	Model #	Manufacture
1	Pool Pump, Tristar VS900	1.85HP 230V	SP32900VSP	Hayward
1	Cartridge Filter		C200S	Hayward
1	In-Line Chlorinator		AQRS325-25000	Hayward
1	Colorlogic LED Lights		LACUS11100	Hayward
8	Main Drain (Hayward SP1049(AV) Complete with gaskets and screws 1-1/2" bottom connection and plug. 148 GPM	Color: Grey	SP1049(AV)	Hayward
1	Spa Cover	Color: Light Blue	10' Wide	Merlin
37' LF	Spa Cap	Color: Greyed Nickel	Raffinato	Techo-Bloc
8	Spa Jets w/ Air Lines	Color: Platinum Grey	TBD	Hayward
1	Spa Blower	Color: TBD	SP 202	Hayward
1	Check Valve (PVC)	Color: Grey	PSCV2S2DGR	Hayward
1	Transformer (12 Volt Single Tap)	TBD	TBD	Hayward
1	Junction Box	78310700	78310700	Pentair
1	Spa Natural Gas Heater (BTU 150k)	Spa Gas Heater	Spa Gas Heater	Hayward



General Contractor

Pool Contractor

Project Address

Drawn by: Omni Pools

Date: 01-13-2025

Project #: Slenkovich

Sheet Name: Pool Deck Equipment And Schedule

A112

Scale: As indicated

Omni Pools & Scapes  
4445 Weaver Court N  
Hilliard, OH 43026

680 Grandon Ave,  
Bexley, OH 43209

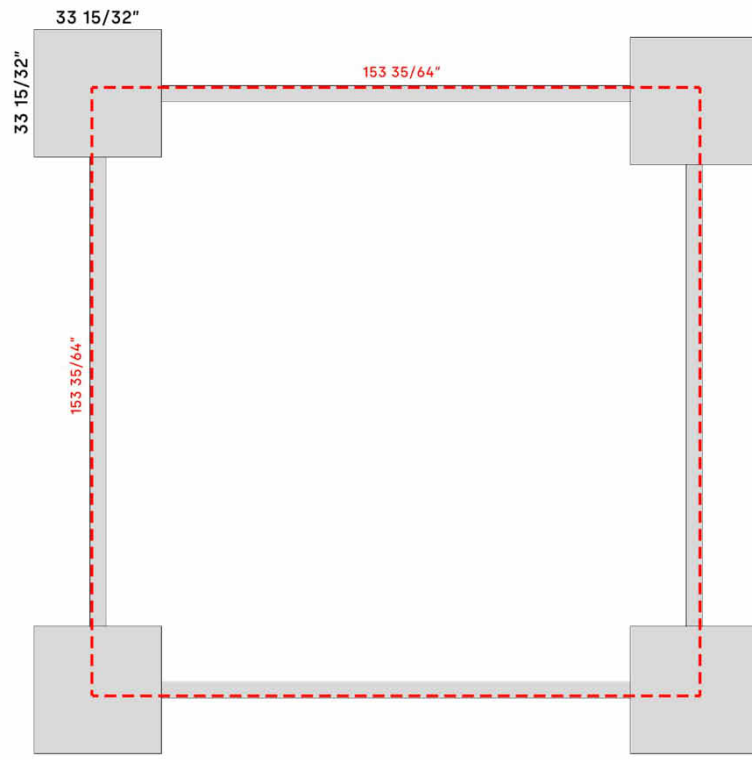

FLOOR PLAN

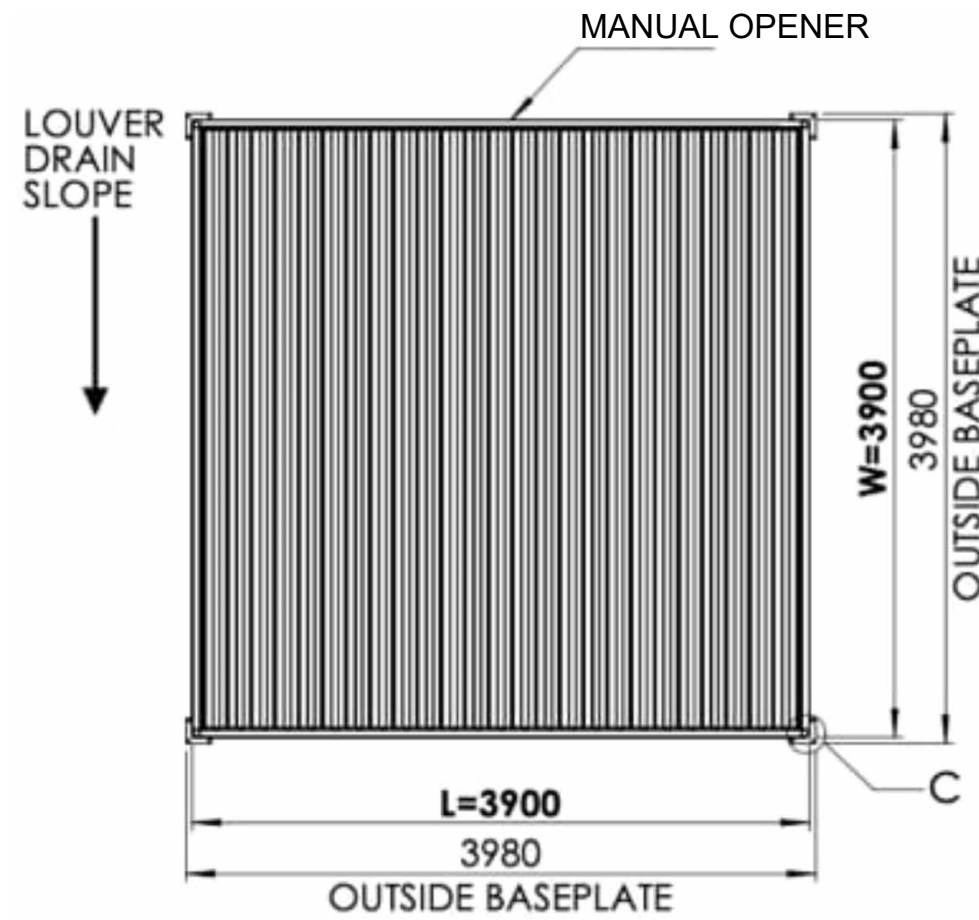

ROOF PLAN

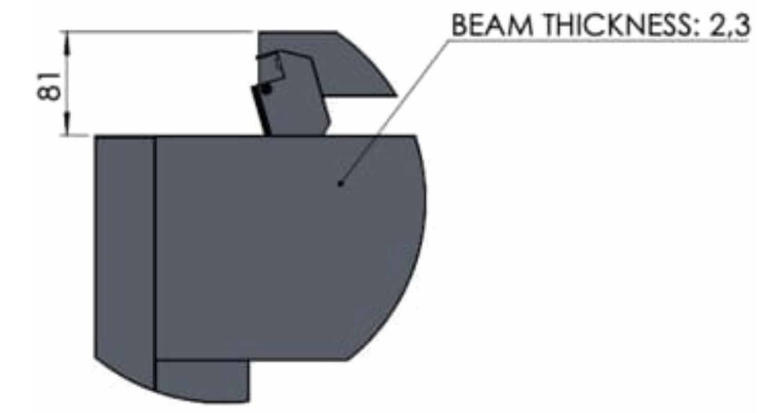

DETAIL A  
OPEN POSITION

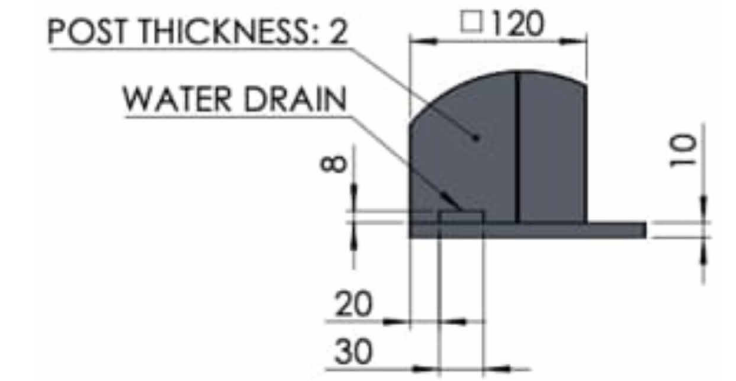

DETAIL B

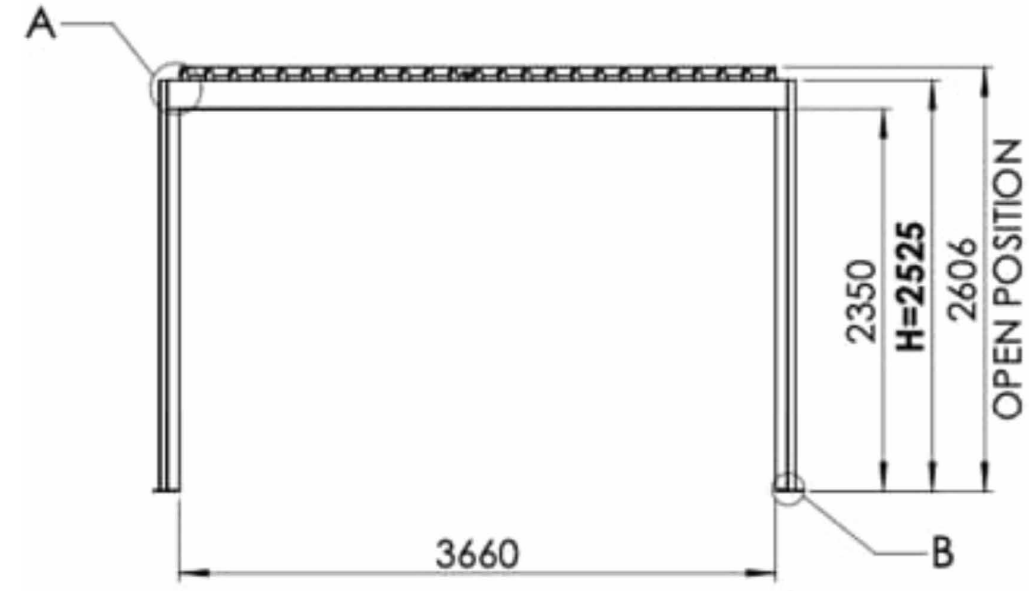

SECTION



PERSPECTIVE

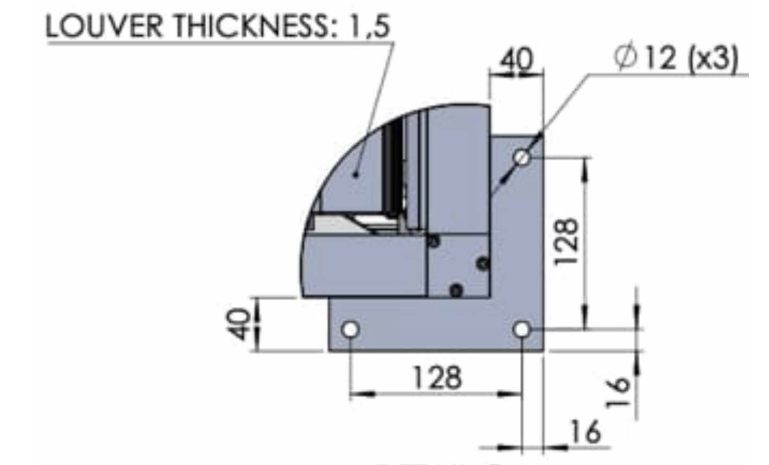

DETAIL C





