

ALLEY  
(16' R.O.W.)

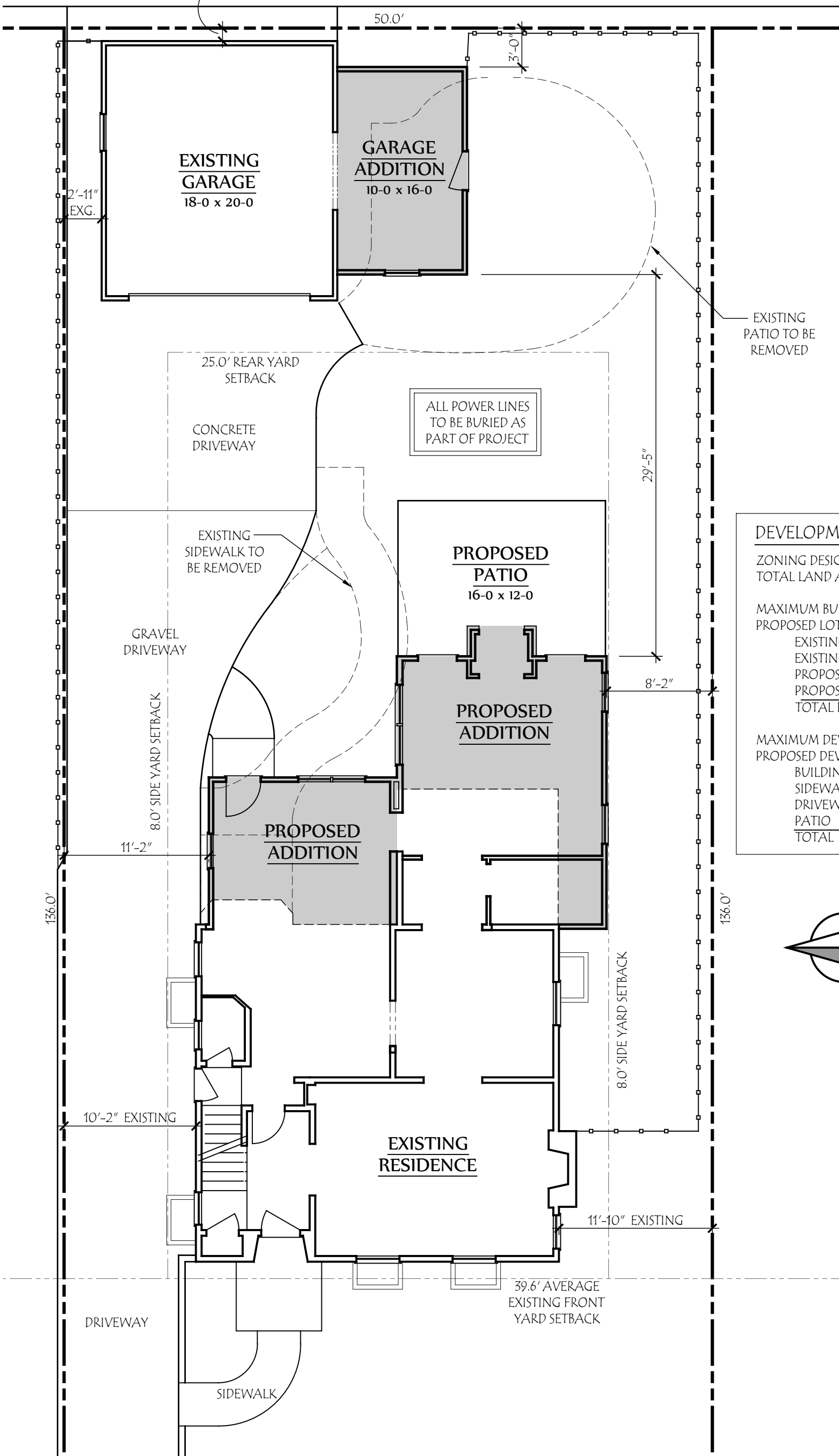

| DEVELOPMENT INFORMATION  |                 |
|--------------------------|-----------------|
| ZONING DESIGNATION       | = R-6           |
| TOTAL LAND AREA          | = 6830 SF       |
| MAXIMUM BUILDING COVER   | 35% = 2391 SF   |
| PROPOSED LOT COVER:      |                 |
| EXISTING HOUSE           | = 867 SF        |
| EXISTING GARAGE          | = 370 SF        |
| PROPOSED HOUSE ADDITION  | = 370 SF        |
| PROPOSED GARAGE ADDITION | = 160 SF        |
| TOTAL BUILDING COVER     | 25.8% = 1767 SF |
| MAXIMUM DEVELOP. COVER   | 60% = 4098 SF   |
| PROPOSED DEVELOP. COVER: |                 |
| BUILDING COVER           | = 1767 SF       |
| SIDEWALKS                | = 71 SF         |
| DRIVEWAY                 | = 1386 SF       |
| PATIO                    | = 200 SF        |
| TOTAL                    | 50.0% = 3424 SF |

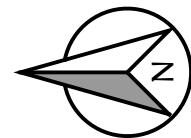

**COPYRIGHT©**  
LAUERHASS ARCHITECTURE, LLC  
ALL RIGHTS RESERVED.  
THE ARCHITECT'S DRAWINGS AND OTHER WORK ARE FOR USE SOLELY ON THIS PROJECT. THE ARCHITECT IS THE AUTHOR, AND RESERVES ALL RIGHTS. INFORMATION CONTAINED HEREIN SHALL NOT BE USED WITHOUT THE EXPRESS WRITTEN AUTHORIZATION OF THE ARCHITECT.

Date: 2 April 2024  
Project Number: 23-078  
Drawing Title: **Site Plan**  
Project Name: The Straub Residence  
176 S. Stanwood Rd.  
Scale: 1/8" = 1'-0"  
Sheet Number: S-1

