

75'-0" (ACCESSORY STRUCTURE TOTAL WIDTH = 44'-2" 58% LOT WIDTH)

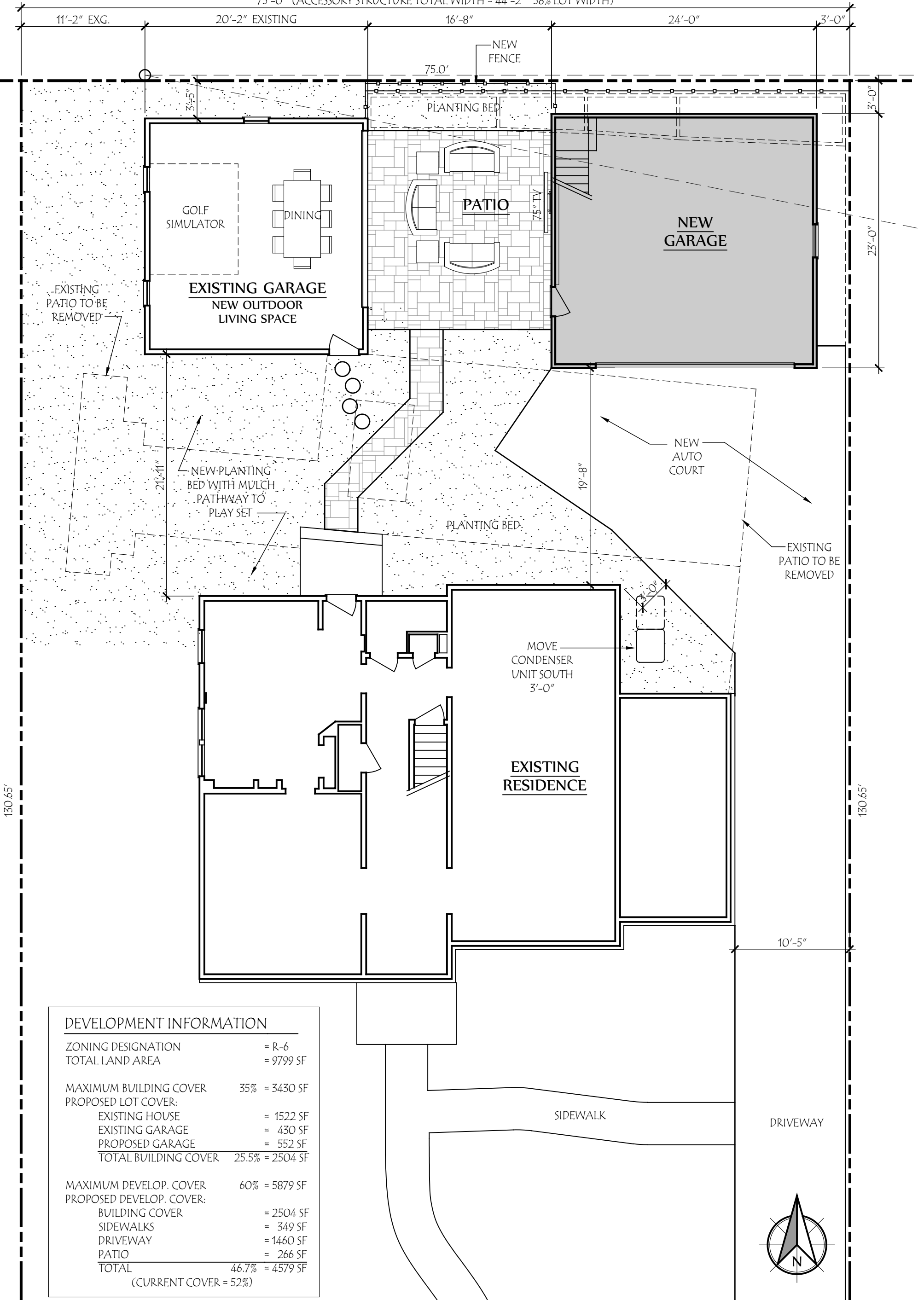

**DEVELOPMENT INFORMATION**

ZONING DESIGNATION	= R-6
TOTAL LAND AREA	= 9799 SF
MAXIMUM BUILDING COVER	35% = 3430 SF
PROPOSED LOT COVER:	
EXISTING HOUSE	= 1522 SF
EXISTING GARAGE	= 430 SF
PROPOSED GARAGE	= 552 SF
<b>TOTAL BUILDING COVER</b>	<b>25.5% = 2504 SF</b>
MAXIMUM DEVELOP. COVER	60% = 5879 SF
PROPOSED DEVELOP. COVER:	
BUILDING COVER	= 2504 SF
SIDEWALKS	= 349 SF
DRIVEWAY	= 1460 SF
PATIO	= 266 SF
<b>TOTAL</b>	<b>46.7% = 4579 SF</b>
(CURRENT COVER = 52%)	



**COPYRIGHT©**

LAUERHASS ARCHITECTURE, LLC  
ALL RIGHTS RESERVED.

THE ARCHITECT'S DRAWINGS AND OTHER WORK ARE FOR USE SOLELY ON THIS PROJECT. THE ARCHITECT IS THE AUTHOR, AND RESERVES ALL RIGHTS. INFORMATION CONTAINED HEREIN SHALL NOT BE USED WITHOUT THE EXPRESS WRITTEN AUTHORIZATION OF THE ARCHITECT.

Date:  
**5 Feb 2024**

Project Number:  
**23-099**

Drawing Title:  
**Site Plan**

Project Name:  
**The Barger Residence**

Scale:  
**1/8" = 1'-0"**

Sheet Number:  
**S-1**



**Lauerhass Architecture**  
RENOVATION - ADDITION - NEW HOME